

XTOOL | SafetyPro™ AP2 Max

Quick Start Guide



Contents

List of items ----- 01

Meet xTool SafetyPro™ AP2 Max ----- 02

Install xTool SafetyPro™ AP2 Max ----- 05

Use xTool SafetyPro™ AP2 Max ----- 14

Use with xTool software ----- 15

Maintenance ----- 16

List of items

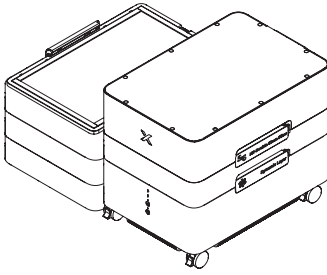

xTool SafetyPro™ AP2 Max

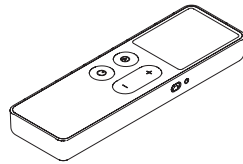

Remote control

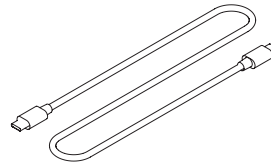

Charging cable for the remote control

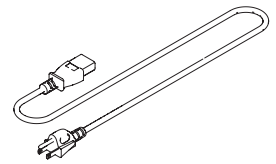

Power cable

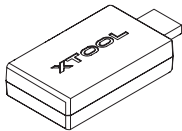

Bluetooth dongle

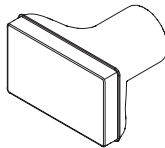

Airflow inlet connector

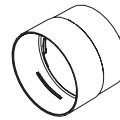

Pipe connector 1

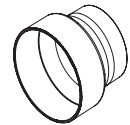

Pipe connector 2

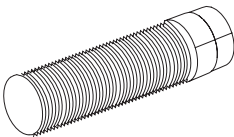

Smoke exhaust pipe



Pipe clamp

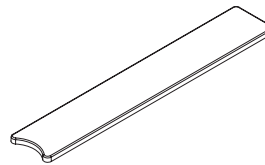

NFC baseplate



Quick start guide

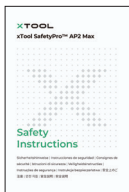

Safety instructions

Note:



- The power cable varies according to the region in which the product is delivered.
- Pipe connector 1 is compatible with xTool machines' rigid, shape-adjustable exhaust pipes with a diameter of 80 mm.
- Pipe connector 2 is compatible with xTool machines' rigid, shape-adjustable exhaust pipes with a diameter of 65 mm.

Meet xTool SafetyPro™ AP2 Max

AP2 Max

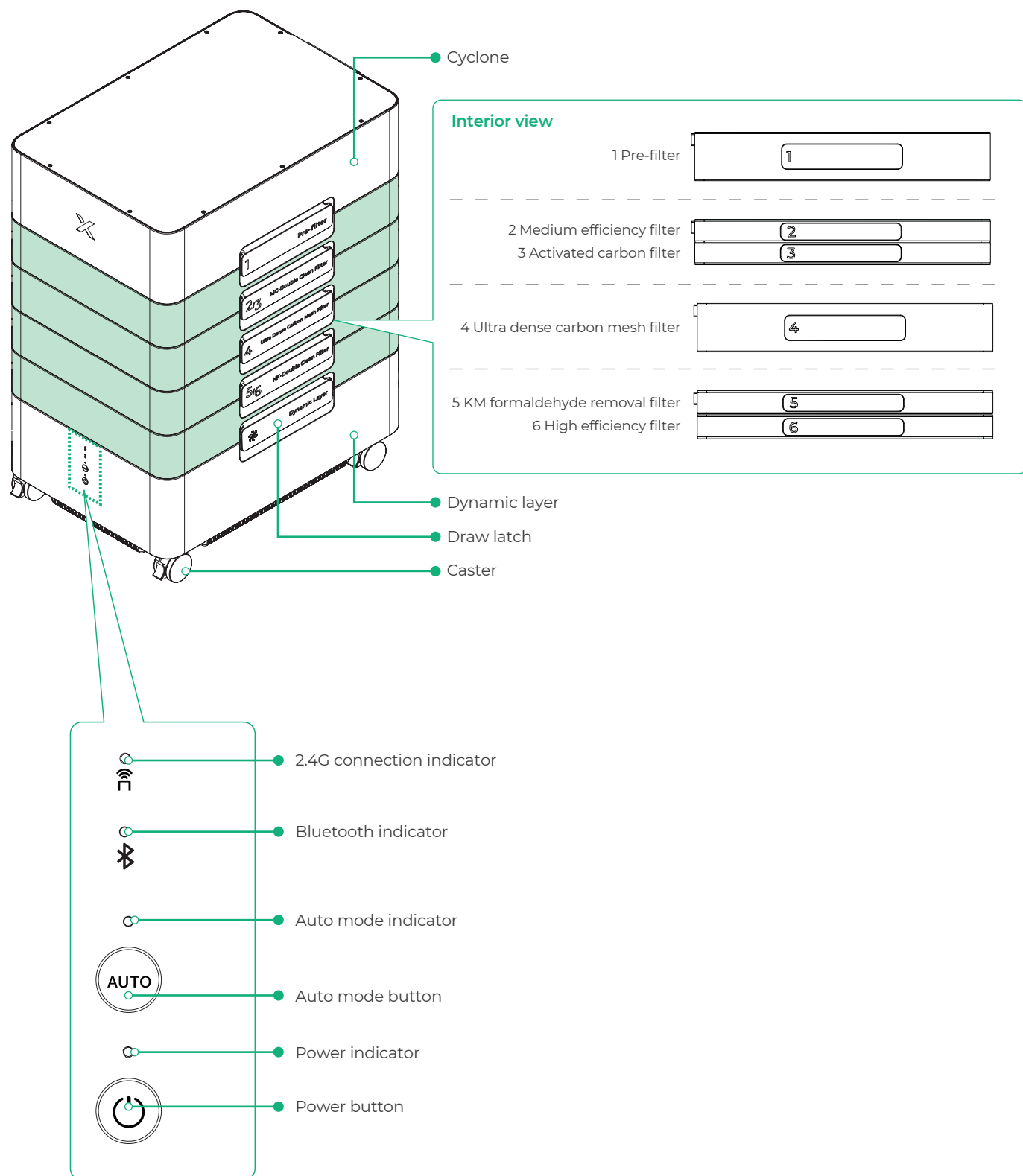

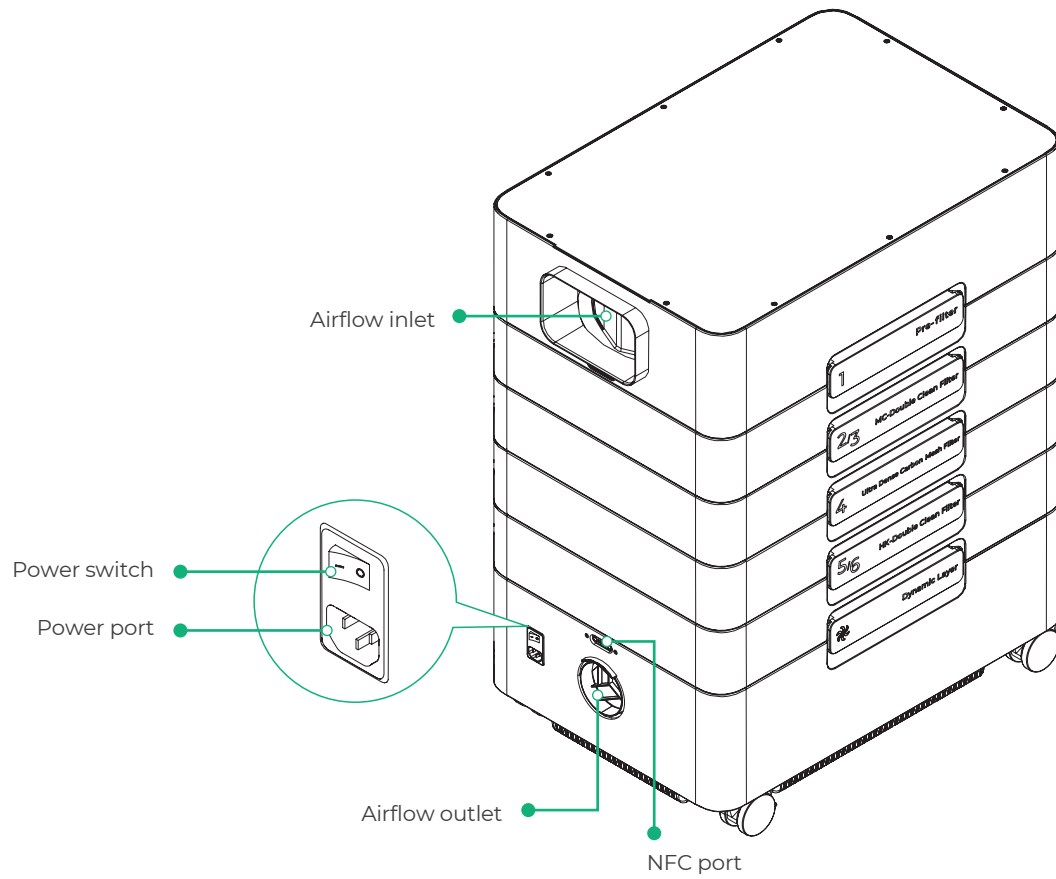



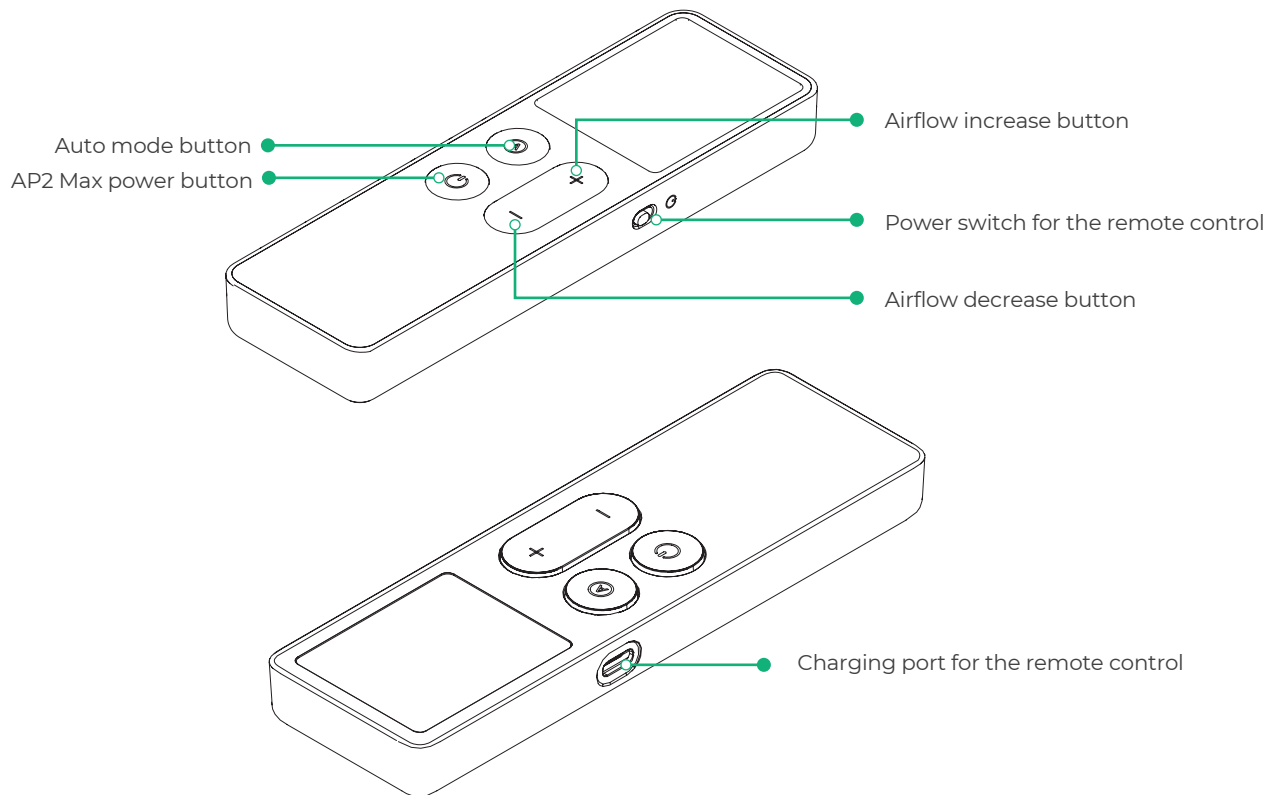









Remote control



AP2 Max indicators description

| Indicator | Indicator status | Device status |
|--|------------------|---|
|  2.4G connection indicator | Blinking blue | The remote control enters pairing mode. |
| | Solid blue | The remote control has been connected to AP2 Max. |
|  Bluetooth indicator | Blinking blue | AP2 Max is waiting to connect to the laser machine. |
| | Solid blue | AP2 Max has been connected to the laser machine. |
|  Auto mode indicator | Solid blue | AP2 Max is working in auto mode. |
| | Off | AP2 Max is working in manual mode. |
|  Power indicator | Solid blue | AP2 Max has been powered on. |

Remote control screen

| Indicator icon | Indicator status | Description |
|---|-------------------------------------|--|
|  Remote control battery | Solid green | Screen on/Power sufficient |
| | Blinking green | Charging |
| | Solid red | Battery power below 25% |
| | Off | Power depleted/Screen off |
|  Bluetooth connection status | Blinking green | AP2 Max is waiting to connect to the laser machine. |
| | Solid green | AP2 Max has been connected to the laser machine. |
| | Off | AP2 Max is not connected to the laser machine. |
|  Remote control connection status | Blinking green | The remote control is pairing with AP2 Max. |
| | Solid green | The remote control has been connected to AP2 Max. |
| | Off | The remote control is not connected to AP2 Max. |
|  AP2 Max power status | Solid green | AP2 Max has been powered on. |
| | Off | AP2 Max is not powered on. |
|  Fault indicator | Solid red | AP2 Max malfunctions. |
| | Off | AP2 Max is working properly. |
|  Auto mode display | Solid green | AP2 Max is working in auto mode. |
| | Off | AP2 Max is working in manual mode. |
|  Airflow volume (%) | Solid green (value range: 1-100) | AP2 Max is in manual mode, and the value is the current airflow volume. |
| Filter indicator  | Solid green | The corresponding filter is normal. |
| | Blinking green | The corresponding filter's life is low ($\leq 30\%$) and needs to be replaced. |
| | Off | The corresponding filter is missing. |

Install xTool SafetyPro™ AP2 Max

1 Install the filters

(1) Release the draw latches.



Caution: When releasing the draw latches, do not place your hand in the gap to avoid injury.

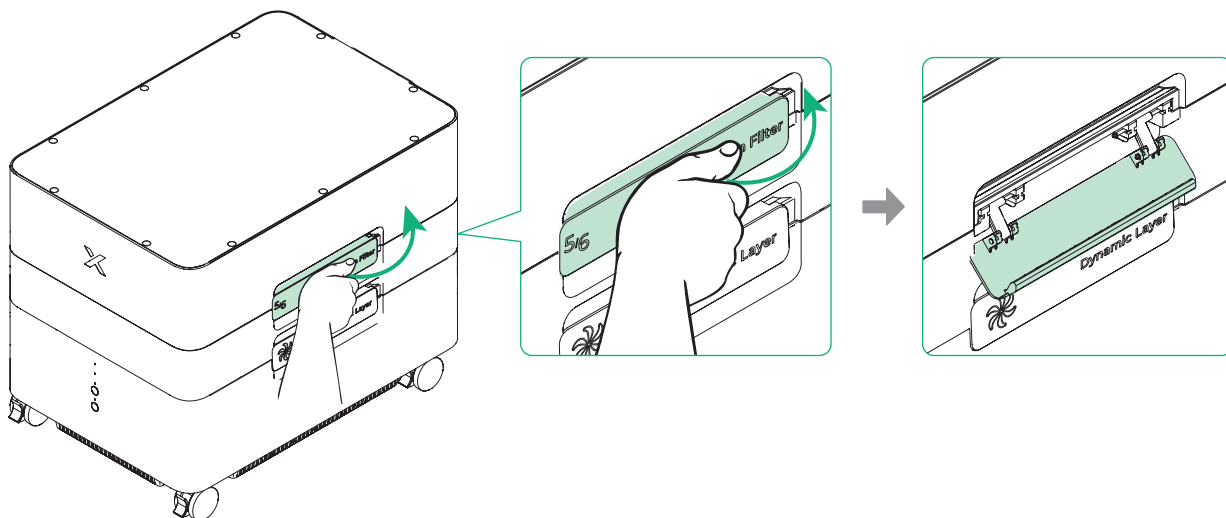

(2) Take the cyclone down.

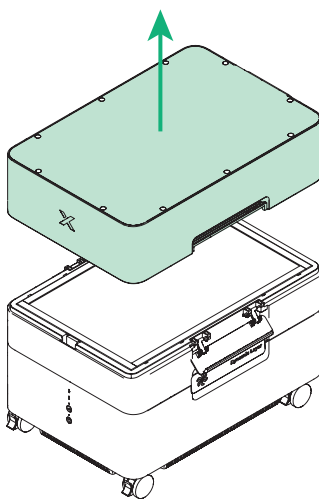

(3) Take the filters out.

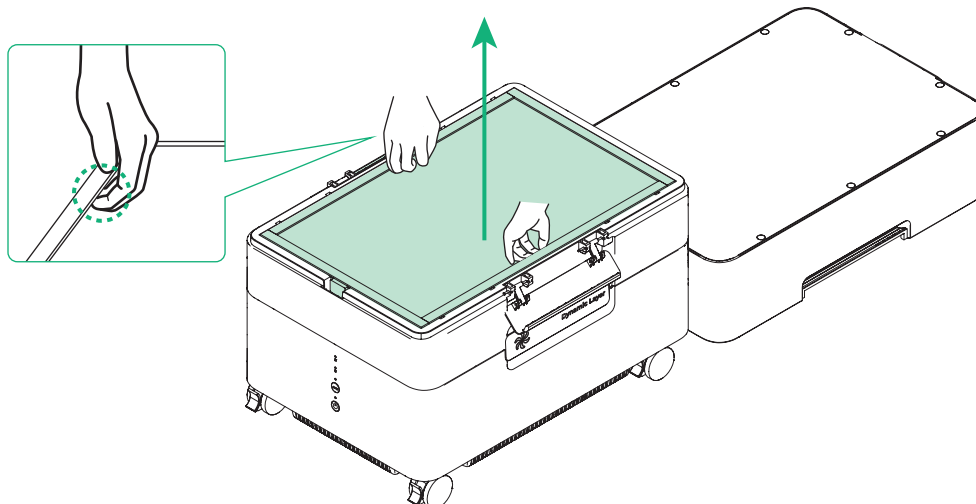

(4) Remove the plastic bags from the filters.

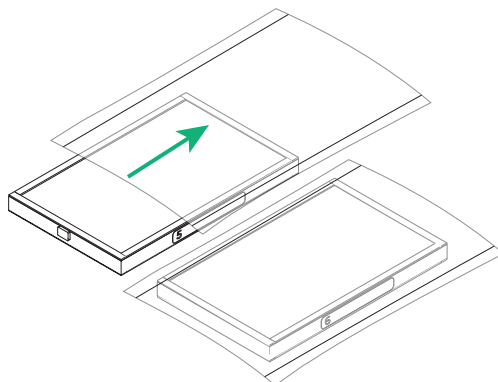

(5) Put the filters back.



Install the filters with texts upright and NFC label facing the rear access (power/air inlet/outlet side).

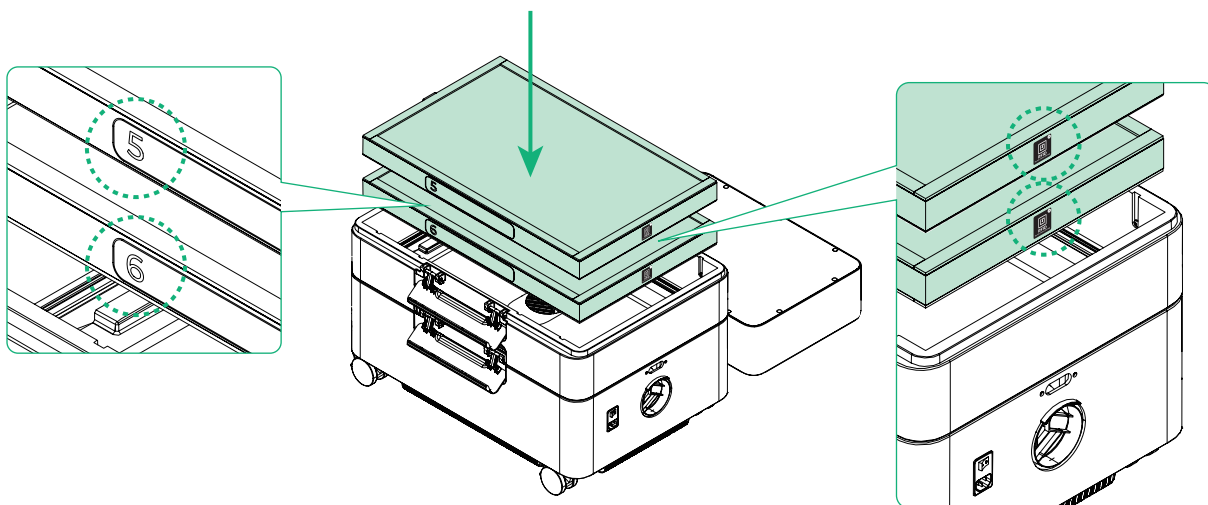

(6) Repeat steps 1 to 5 to prepare the other four filters.

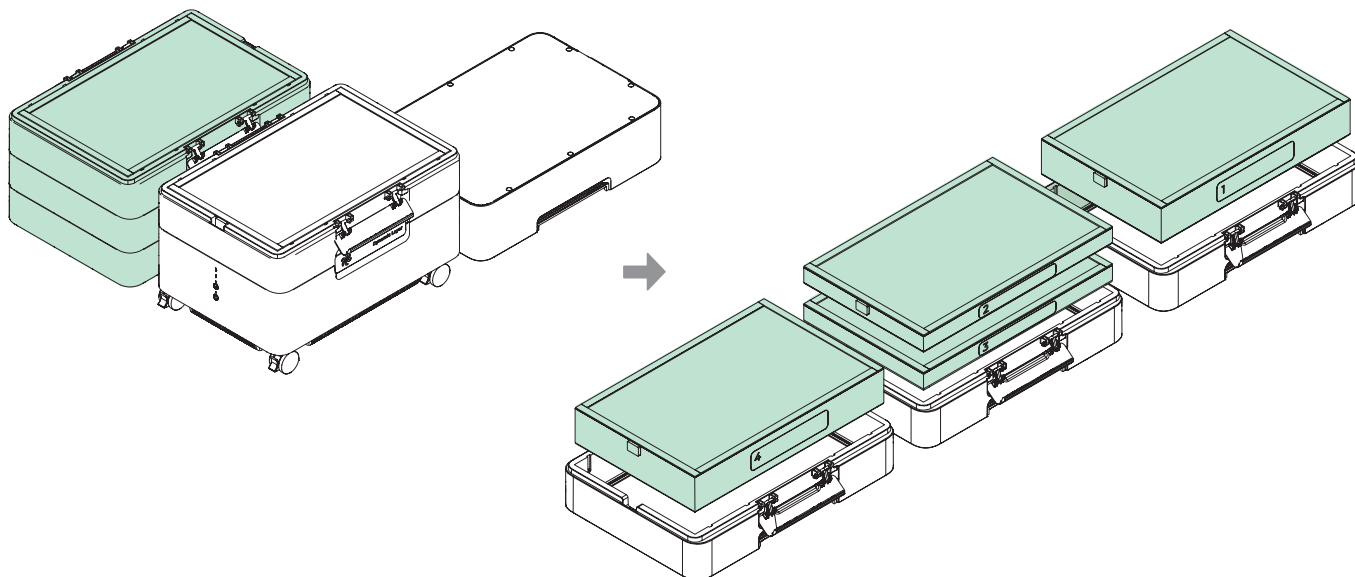

(7) Stack the cyclone and filters according to the illustrated sequence.

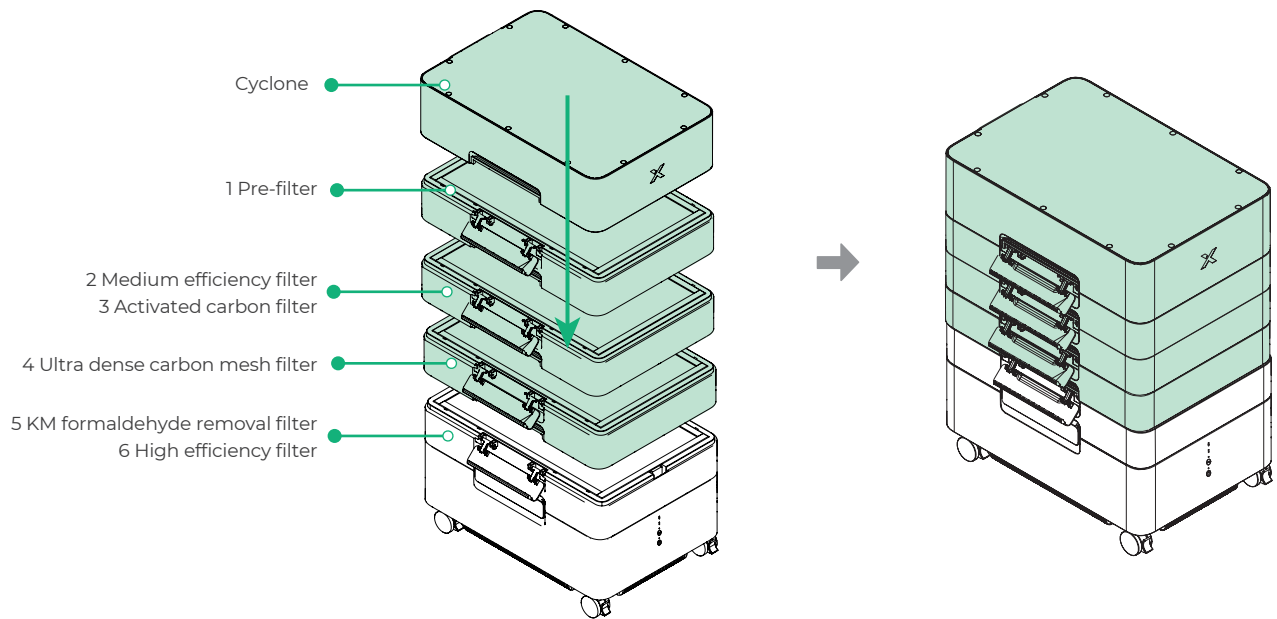

(8) Lock all draw latches.

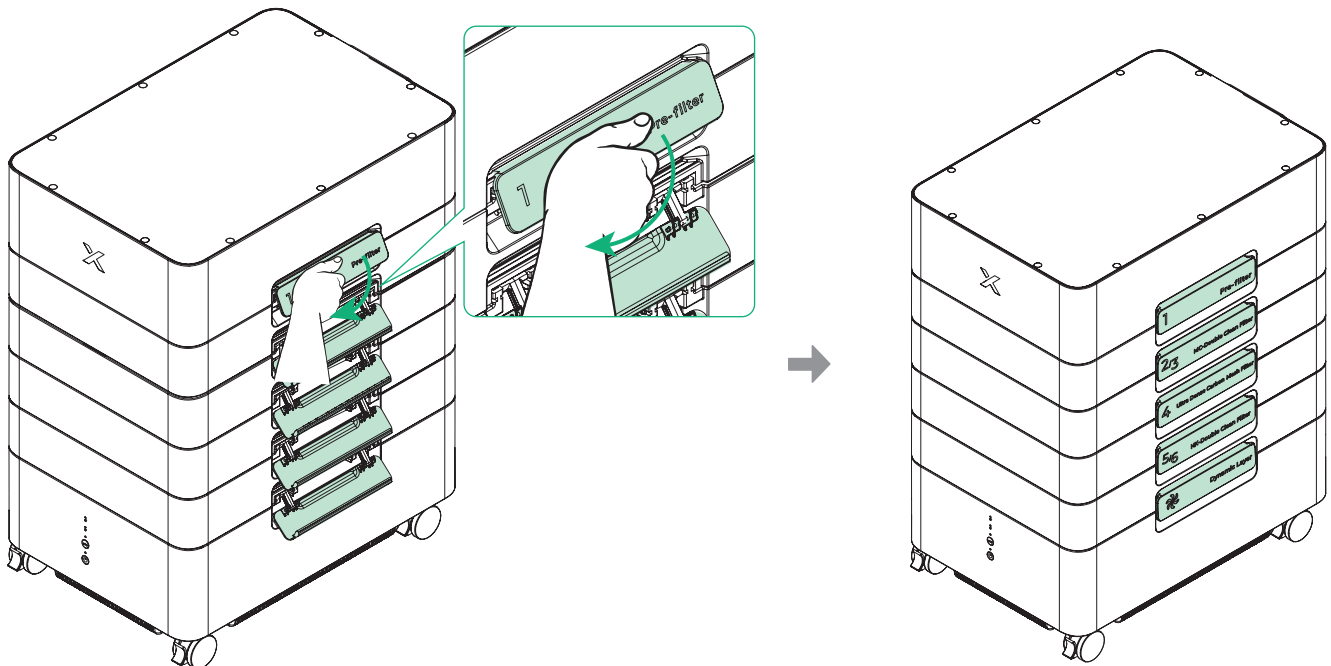

2 Install the NFC baseplate

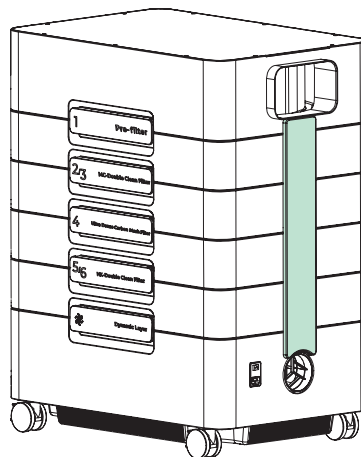
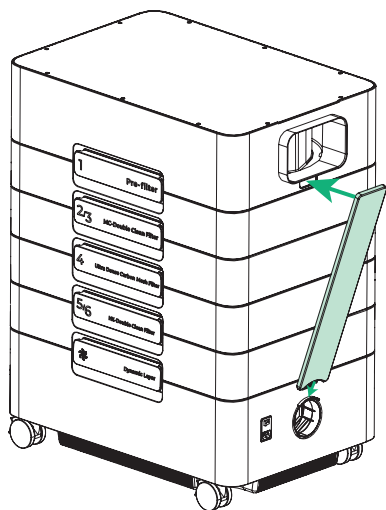
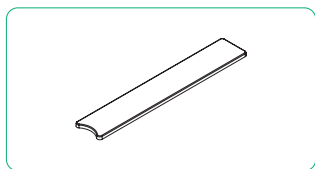

3 Place AP2 Max at the desired location

Unlock the casters, move AP2 Max to the desired location, and then lock the casters.

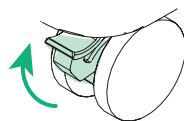
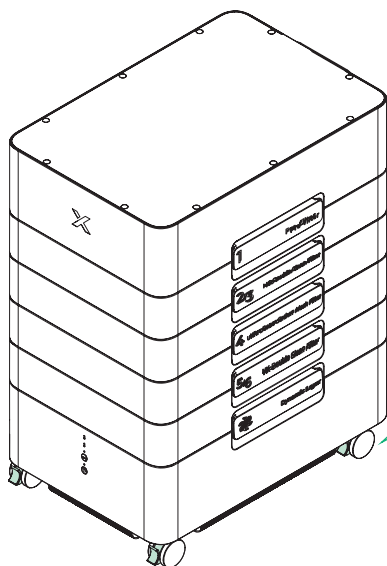

Brake pedal up: AP2 Max is movable.



Brake pedal down: AP2 Max is fixed.

4 Connect the exhaust pipe of the laser machine

(1) Use the exhaust pipe connector to connect the airflow inlet connector and the machine's exhaust pipe.

■ Scenario 1

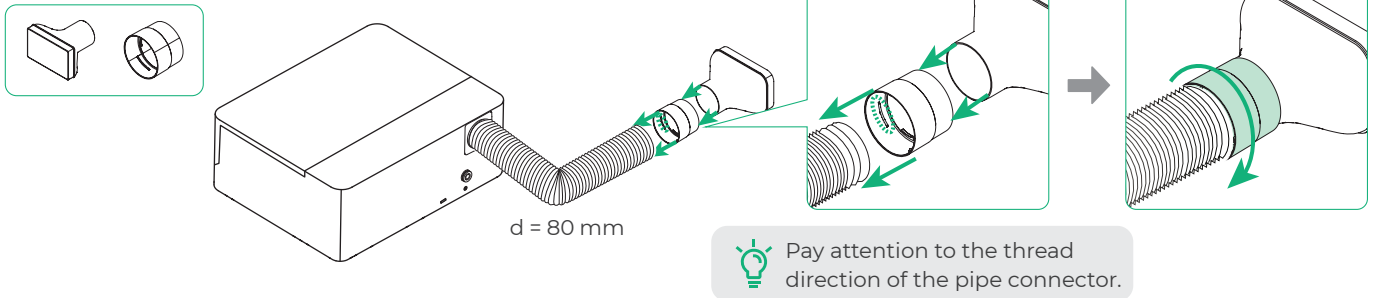

■ Scenario 2

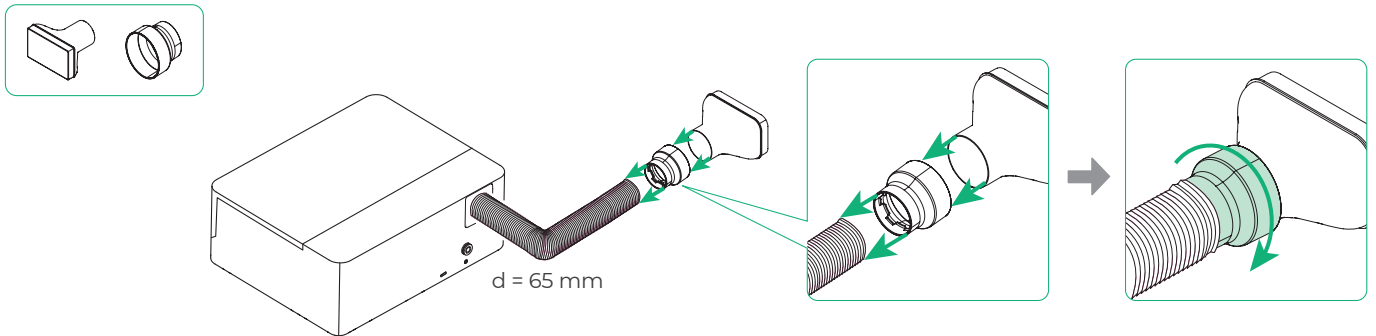

■ Scenario 3

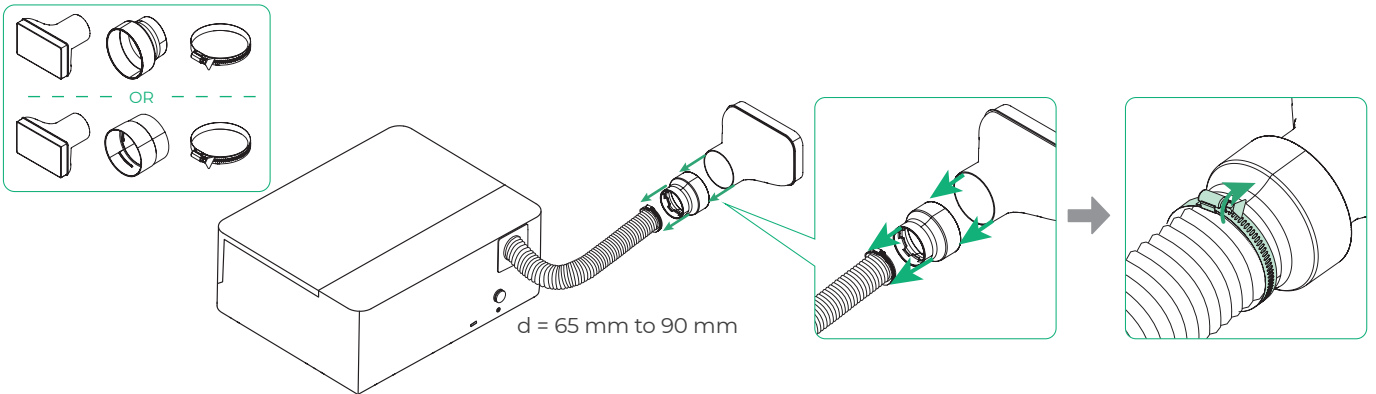

■ Scenario 4

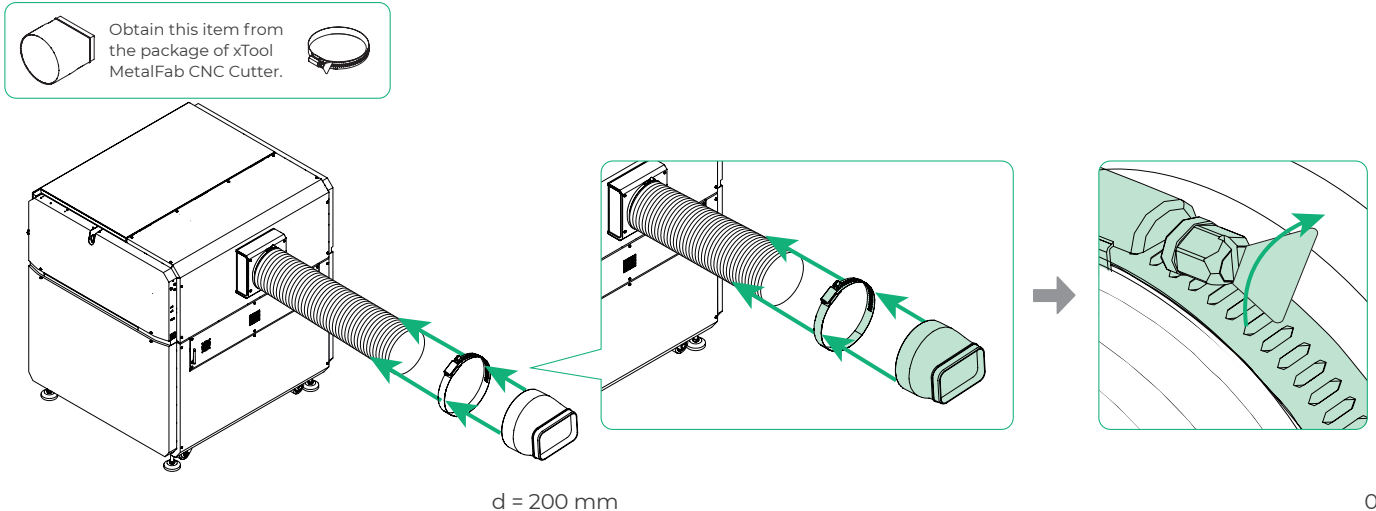

(2) Connect the machine exhaust pipe to the air inlet of AP2 Max.

■ Scenario 1

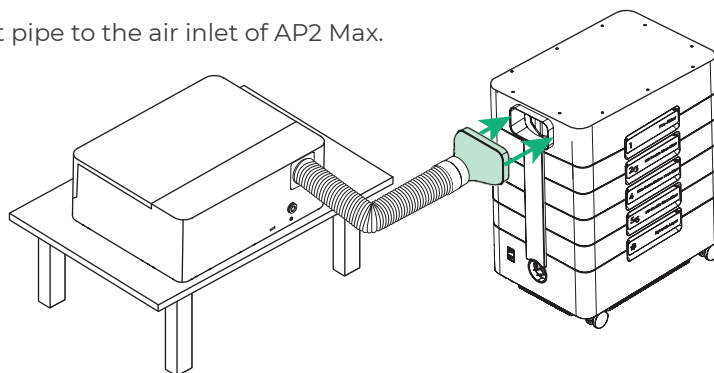

■ Scenario 2

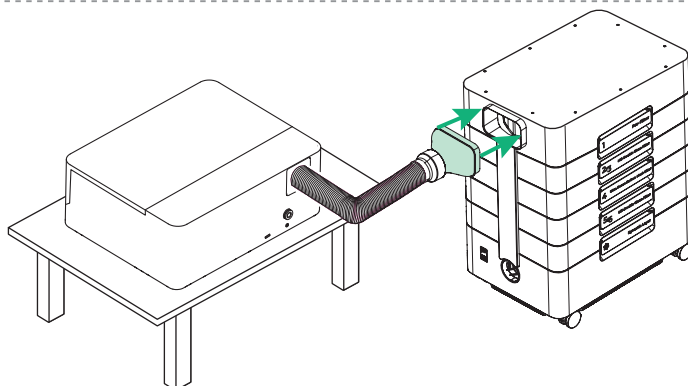
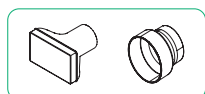

■ Scenario 3

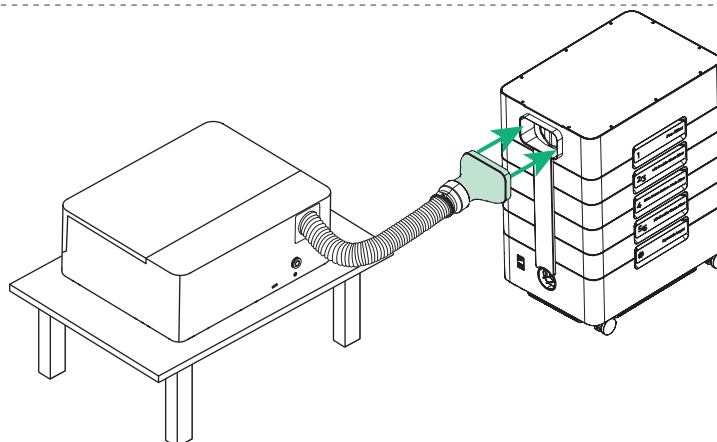
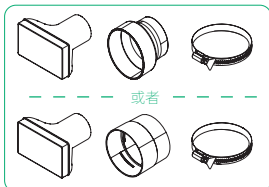

■ Scenario 4

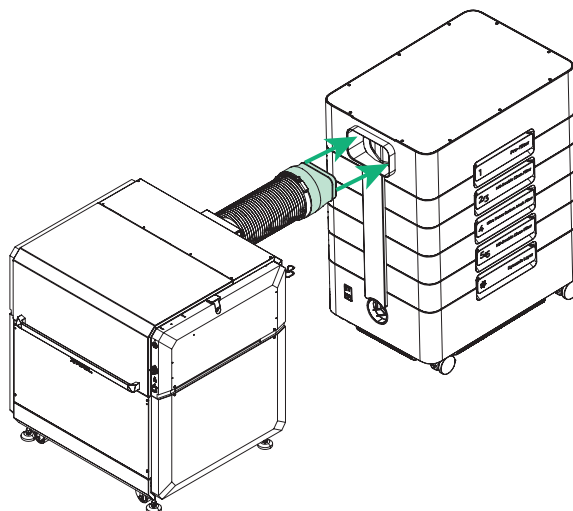
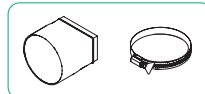

Subsequent steps: The operating steps are the same for different accessory combinations. This manual uses exhaust pipe connector 1 as an example.

5 Connect the exhaust pipe of AP2 Max

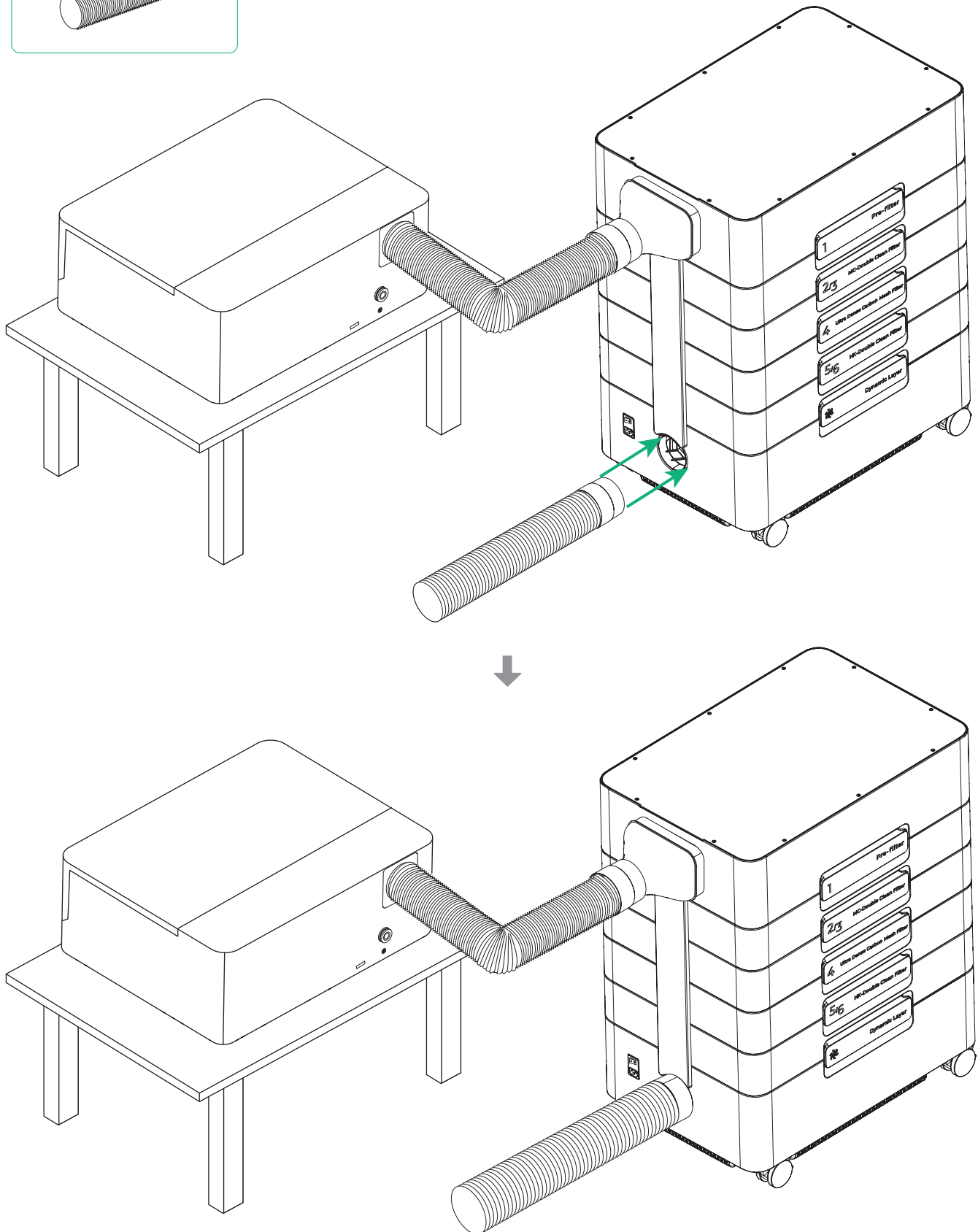
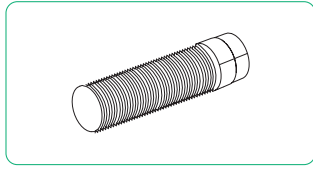

6 Connect AP2 Max to the power supply

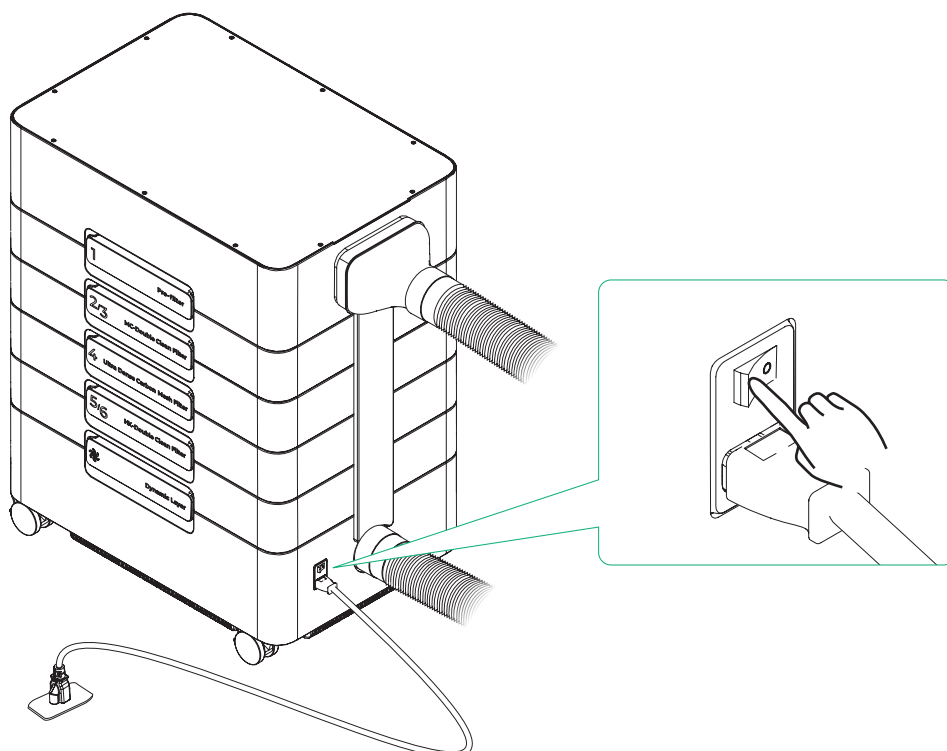
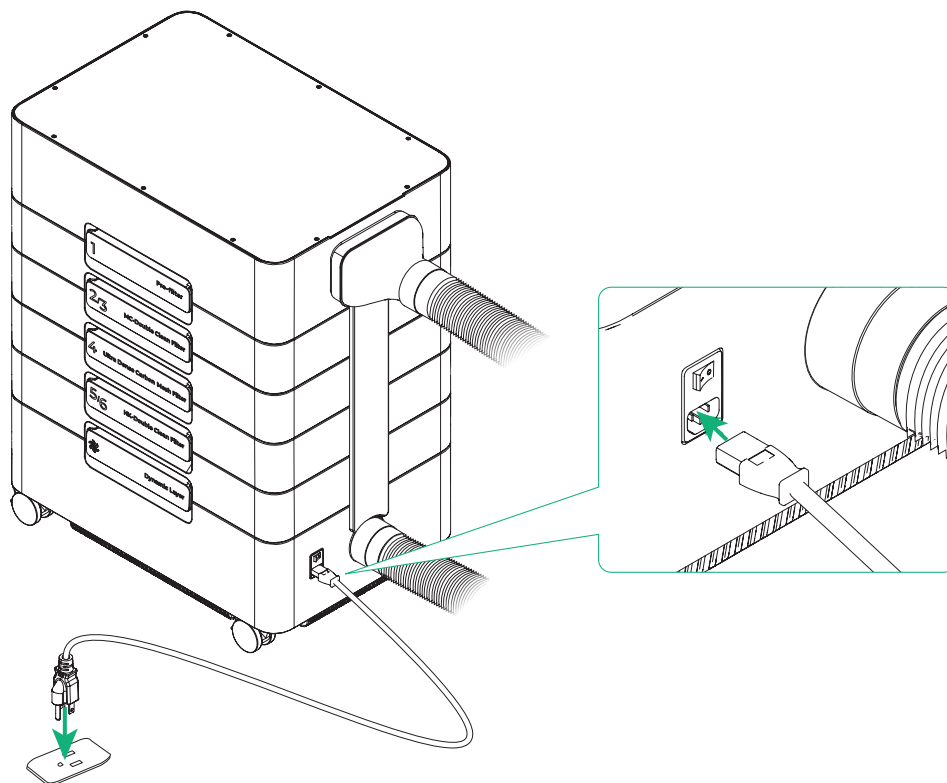
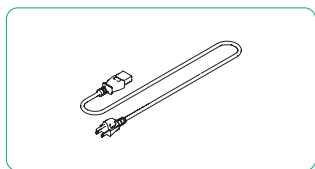

7 Set up wireless connection



AP2 Max can establish a wireless connection only with xTool laser machines that support Bluetooth.

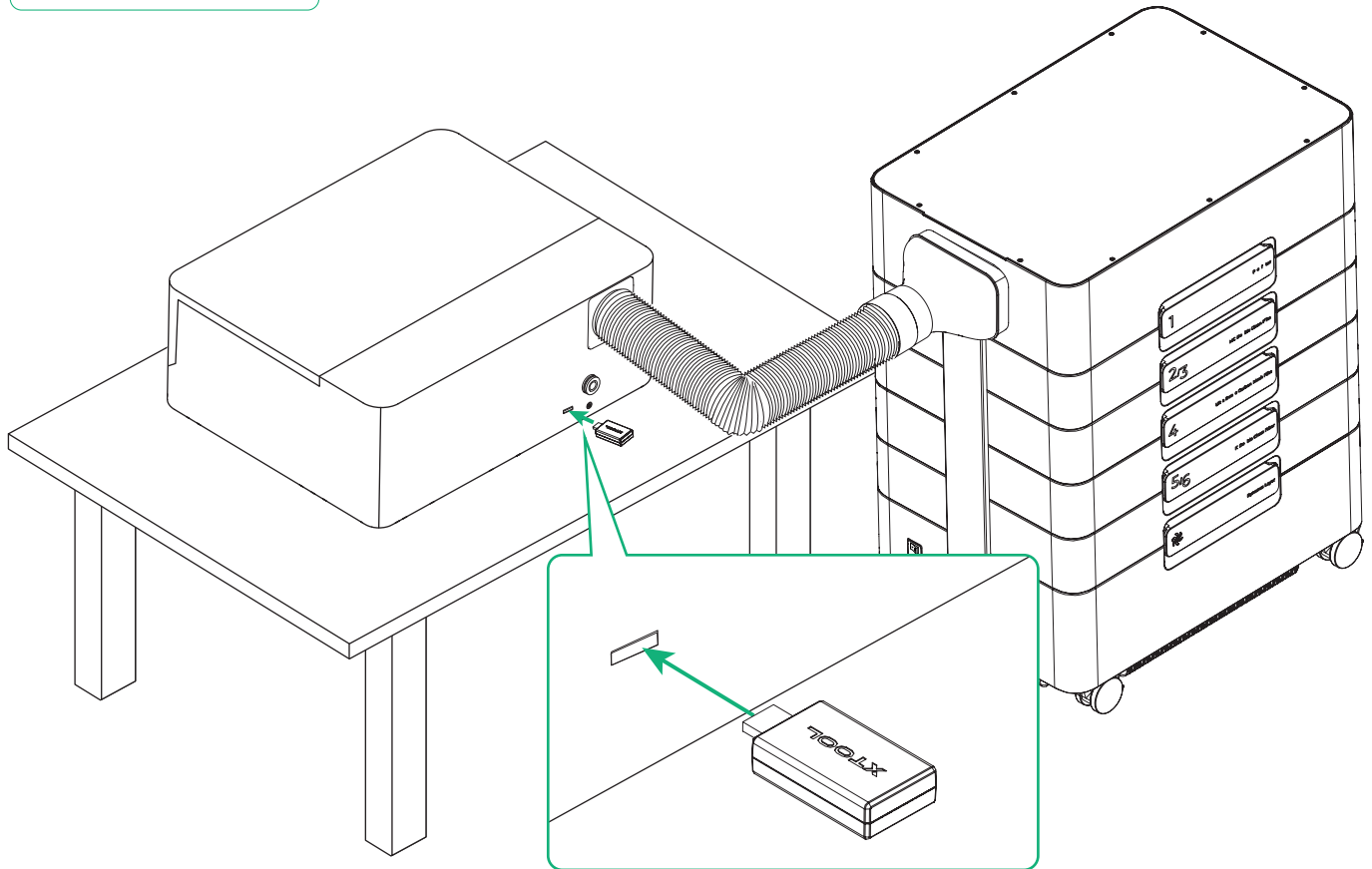

- Insert the Bluetooth dongle to the extension port of the xTool machine. The preceding figure is for reference only.
- After the Bluetooth dongle is connected, AP2 Max automatically establishes a connection with the xTool machine, and its information is displayed on the machine's device settings page on the xTool software. For more details, see "Use with xTool software."
- If another Bluetooth dongle has been inserted to the machine or you need to pair again, press and hold the AP2 Max's power button for at least five seconds. The Bluetooth status indicator will blink white, indicating that AP2 Max is in pairing mode.

Use xTool SafetyPro™ AP2 Max

1 Turn on the remote control.

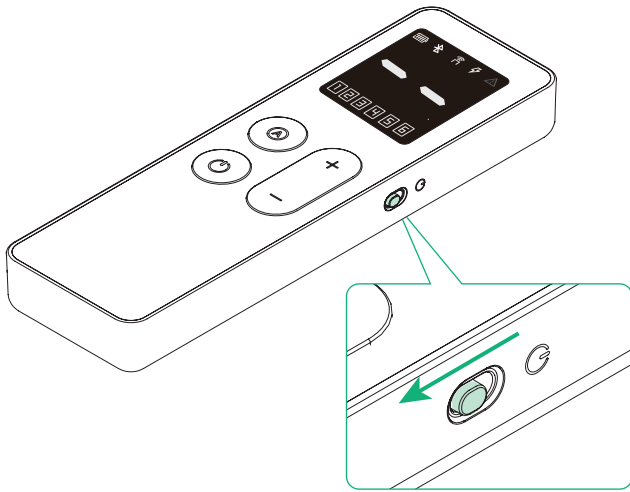

2 Turn on AP2 Max.

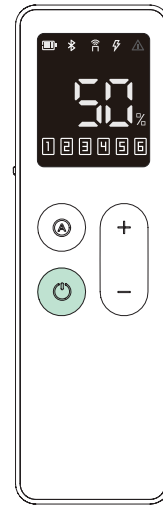

3 Select a mode.

Auto mode

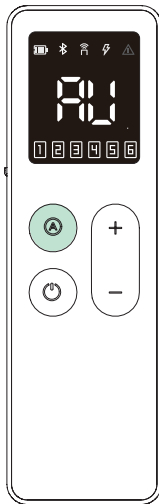

This mode is applicable only to xTool laser machines with Bluetooth functionality. In this mode, AP2 Max automatically adjusts the airflow volume based on the material being processed.

Manual mode

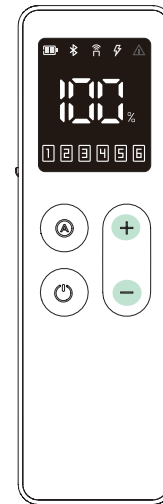

Press the airflow increase button or airflow decrease button to manually adjust the airflow.

+

Each press increases the airflow by 1%. Pressing and holding for at least 1 second can increase continuously.

-

Each press reduces the airflow by 1%. Pressing and holding for at least 1 second can reduce continuously.

Reconnect the remote control



You need to reconnect the remote control if the remote control disconnects from AP2 Max, or another remote control or AP2 Max needs to be connected.

Procedure: Concurrently press the auto mode button of both the remote control and AP2 Max for at least 5s until the 2.4G connection indicator blinks, and ensure that the remote control is close to AP2 Max. The remote control will connect to AP2 Max automatically.

Use with xTool software

1 Get xTool software

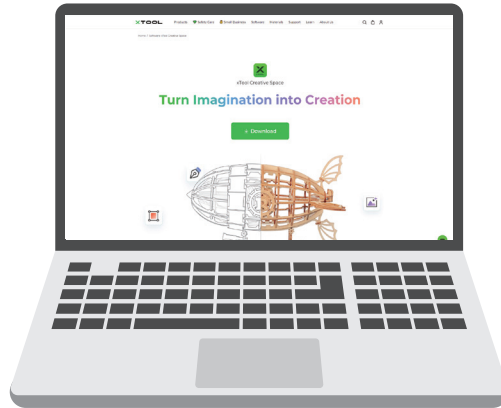

Visit s.xtool.com/software to get xTool software.

2 Use xTool SafetyPro™ AP2 Max on xTool software



support.xtool.com/article/2097

Maintenance

Replace the filters

When a filter is reaching its end of life, the xTool software prompts you to purchase a new one for replacement. For steps about how to replace a filter, see “Install the filters.”



You must disconnect the power cable before replacing any filter.

Clean the cyclone

Generally, you need to clean the cyclone every 3 to 6 months.



You must disconnect the power cable before cleaning the cyclone.

(I) Take the cyclone down

1. Disconnect power.

2. Remove the exhaust pipe.

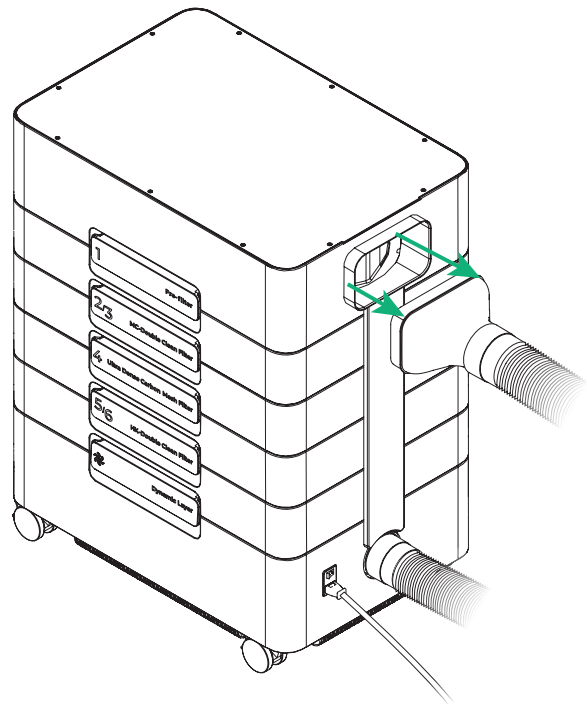
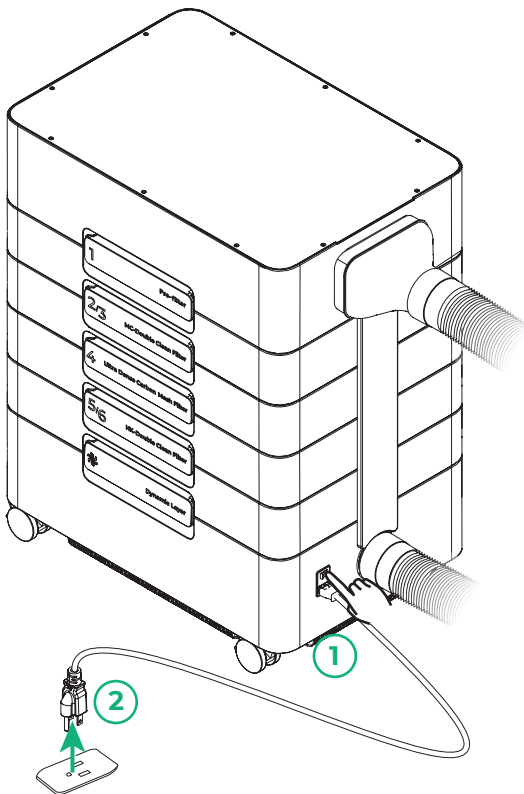

3. Remove the NFC baseplate.

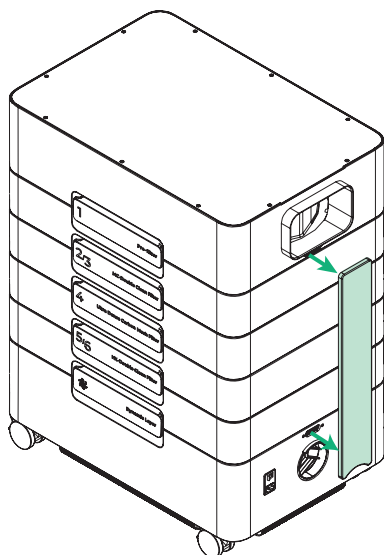

4. Release draw latches on both sides to unlock them.

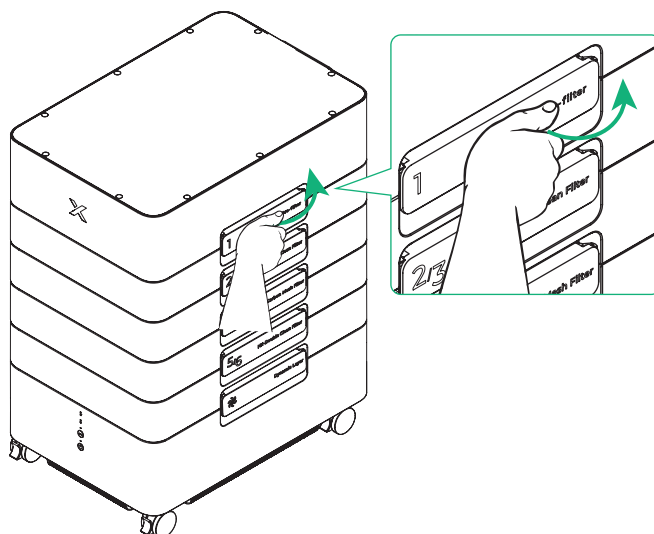

5. Take the cyclone down.

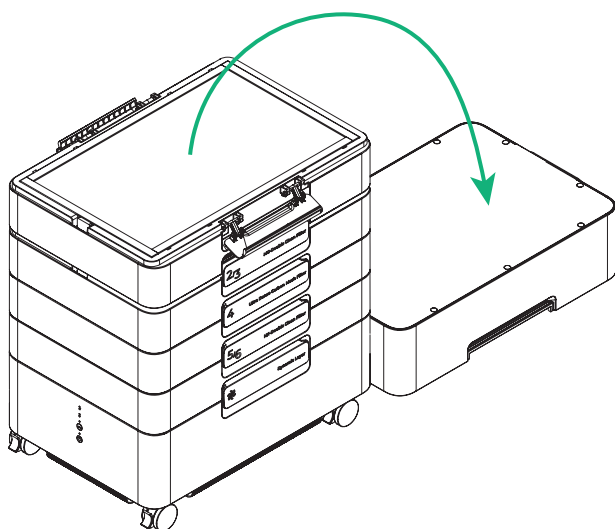

(2) Disassemble the cyclone

1. Remove the screws.

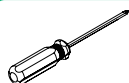

not included
in packaging

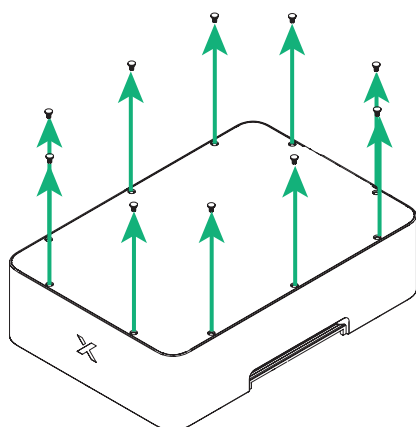

2. Take the cyclone components out.

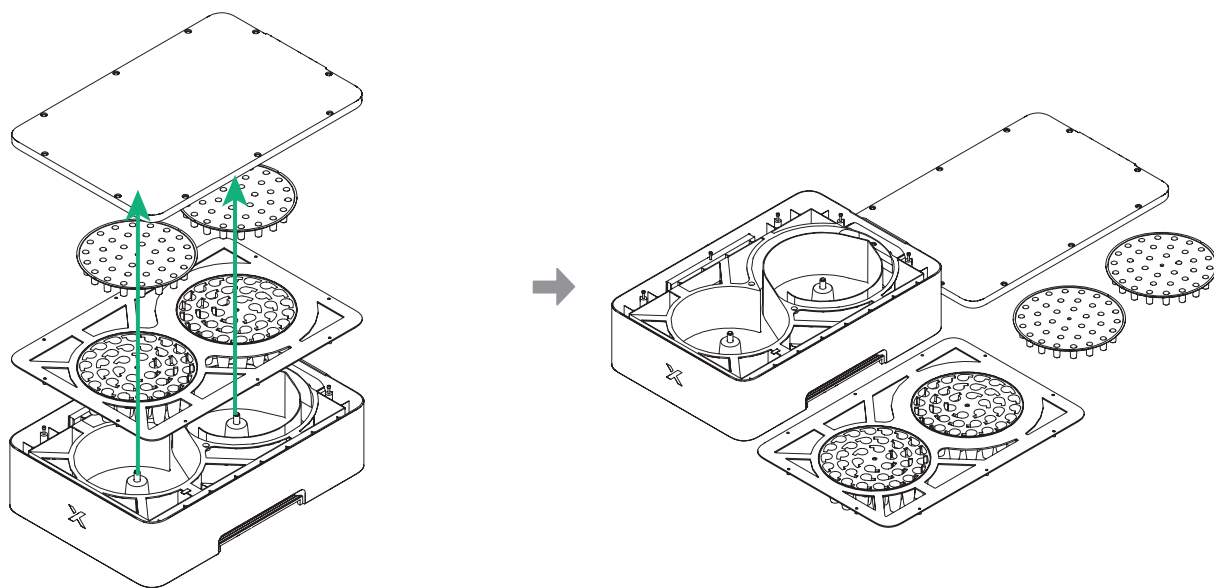

(3) Clean the cyclone

1. Pour out accumulated dust and debris.

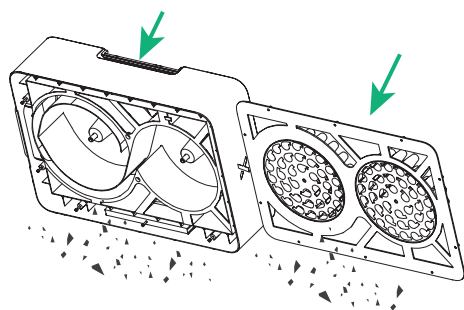

2. Spray with degreaser.

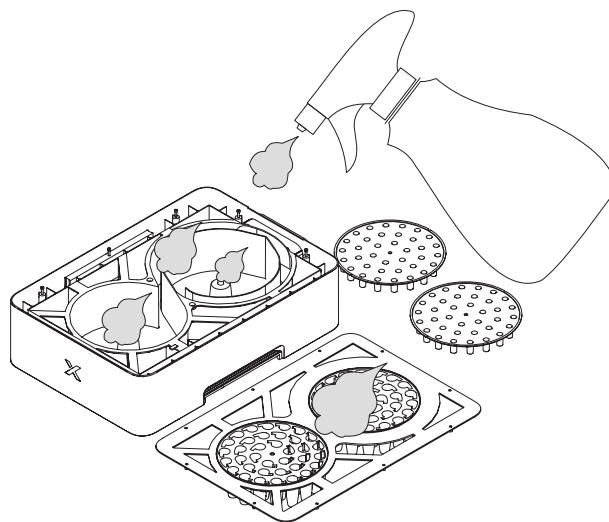

3. Wash with running water.

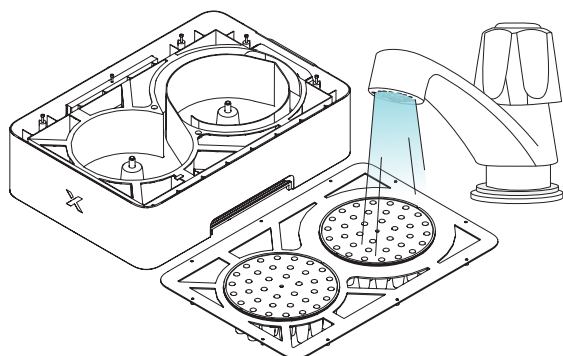

(4) Install the cyclone back

When the cyclone components are dry, install them back in place.

1. Reinstall the components in the order as illustrated.

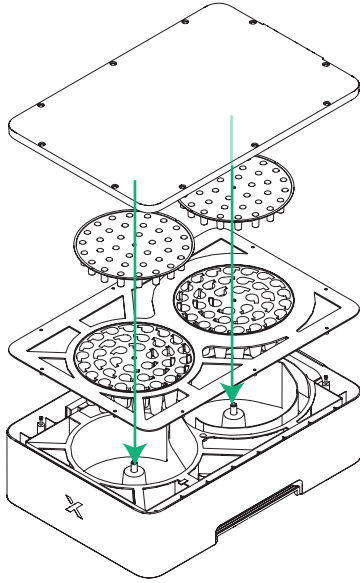

2. Install the screws.

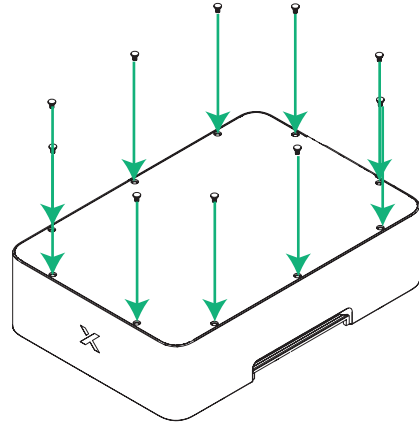

3. Reinstall the cyclone and lock the draw latches.

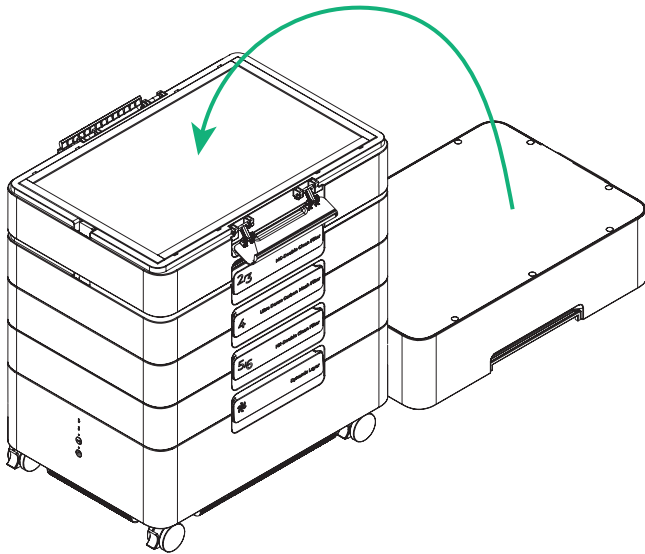

4. Reinstall the NFC baseplate.

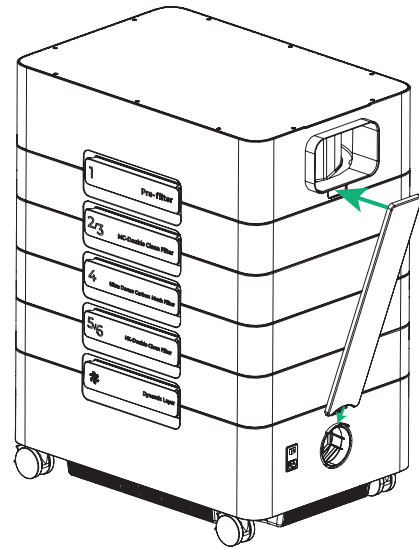

XTOOL