

XTOOL selected

Air Dryer

XTOOL
selected



Quick Start Guide

Kurzanleitung | Guía de inicio rápido | Guide de démarrage rapide |
Guida rapida | Korte handleiding | Manual de referência rápida |
Skrócona instrukcja obsługi | クイックガイド | 빠른 시작 가이드 | 快速入門指南 |
快速使用指南

01

Multi-language versions and more information

To find user guides in multiple languages and more help, please visit support.xtool.com/article/2000 or scan the QR code.

Mehrsprachige Versionen und weitere Informationen

Falls Sie Benutzerhandbücher in mehreren Sprachen suchen und weitere Hilfe benötigen, besuchen Sie bitte support.xtool.com/article/2000 oder scannen Sie den QR-Code.

Versiones multilingües y más información

Para encontrar guías de usuario en varios idiomas y más ayuda, visite support.xtool.com/article/2000 o escanee el código QR.

Versions multilingues et informations complémentaires

Pour trouver des guides de l'utilisateur dans plusieurs langues et accéder à une assistance supplémentaire, veuillez consulter support.xtool.com/article/2000 ou scanner le code QR.

Versioni multilingue e ulteriori informazioni

Per manuali dell'utente in altre lingue o ulteriore assistenza, visitare support.xtool.com/article/2000 o scansionare il codice QR.

Meertalige versies en meer informatie

Ga voor gebruikershandleidingen in meerdere talen en meer hulp naar support.xtool.com/article/2000 of scan de QR-code.

Versões multi-idíomas e mais informações

Para encontrar manuais do utilizador em idiomas múltiplos e mais ajuda, visite, se faz o favor, support.xtool.com/article/2000 ou leia o código QR.

Wersje wielojęzyczne i więcej informacji

Aby znaleźć instrukcje obsługi w wielu językach i dodatkową pomoc, odwiedź stronę support.xtool.com/article/2000 lub zeskanuj kod QR.

複数言語バージョンと詳細情報

複数言語のユーザーガイドと詳細なヘルプについては、support.xtool.com/article/2000 にアクセスするか、QRコードをスキャンしてください。

다중 언어 버전 및 추가 정보

다중 언어로 된 사용 설명서와 추가 도움말을 찾으려면 support.xtool.com/article/2000 페이지를 방문하거나 QR 코드를 스캔하십시오.

多語言版本及更多資訊

如需取得其他語言版本的使用者指南或幫助資訊，請前往 support.xtool.com/article/2000 或掃描 QR code。

多语言版本及更多信息

如需获取其他语言版本的用户指南或更多帮助信息，请访问 support.xtool.com/article/2000 或扫描二维码。你也可以访问 yuque.com/makeblock-help-center-zh/xtool-accessories/air-dryer 查看在线帮助。

02

List of items - - - - - 01

Meet Air Dryer - - - - - 01

Connections - - - - - 03

Use the devices - - - - - 05

Maintenance - - - - - 06

FAQ - - - - - 12

support.xtool.com/article/2000



List of items

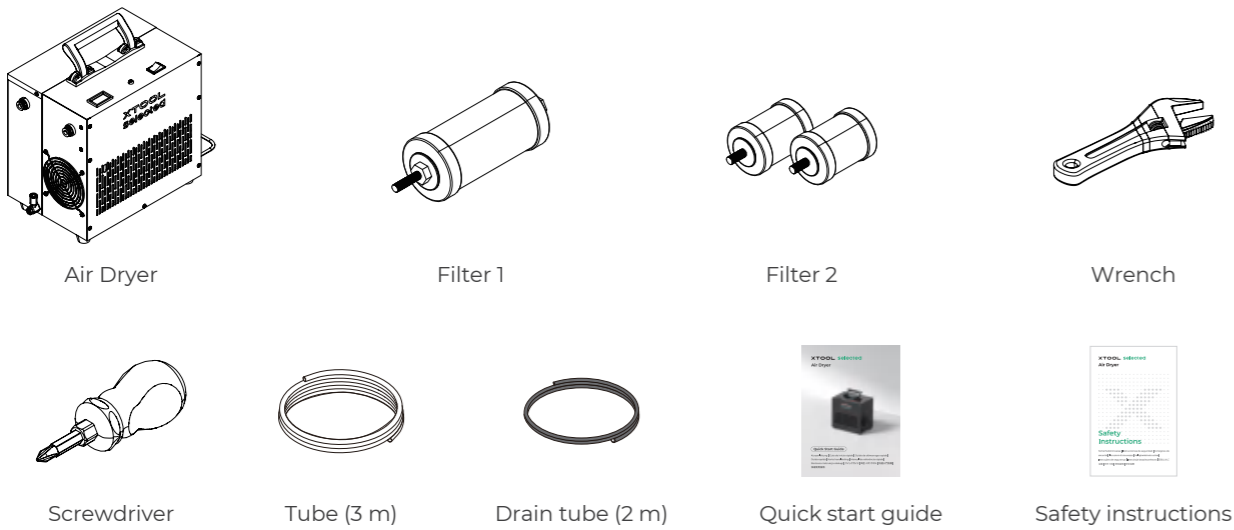

Meet Air Dryer

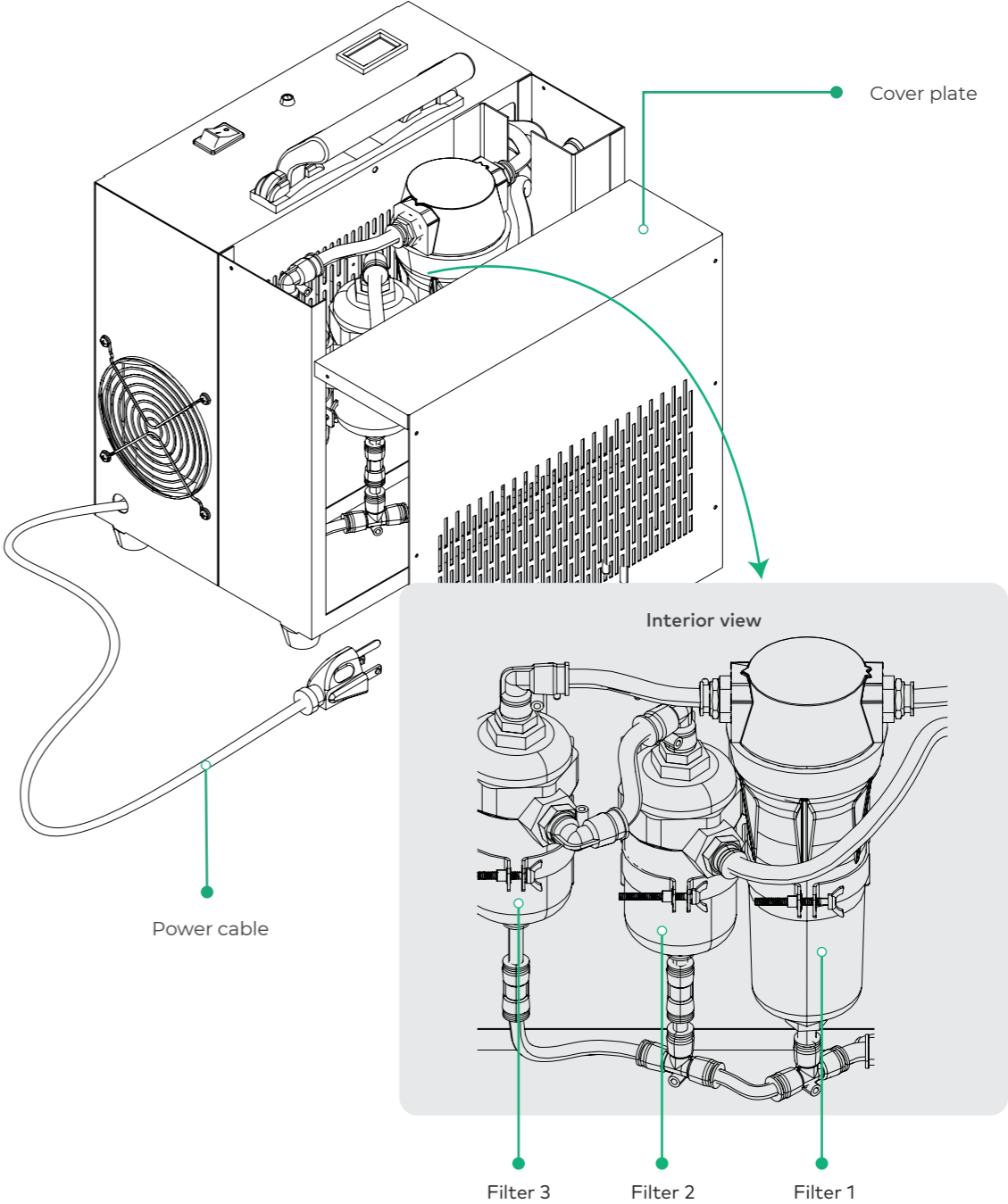
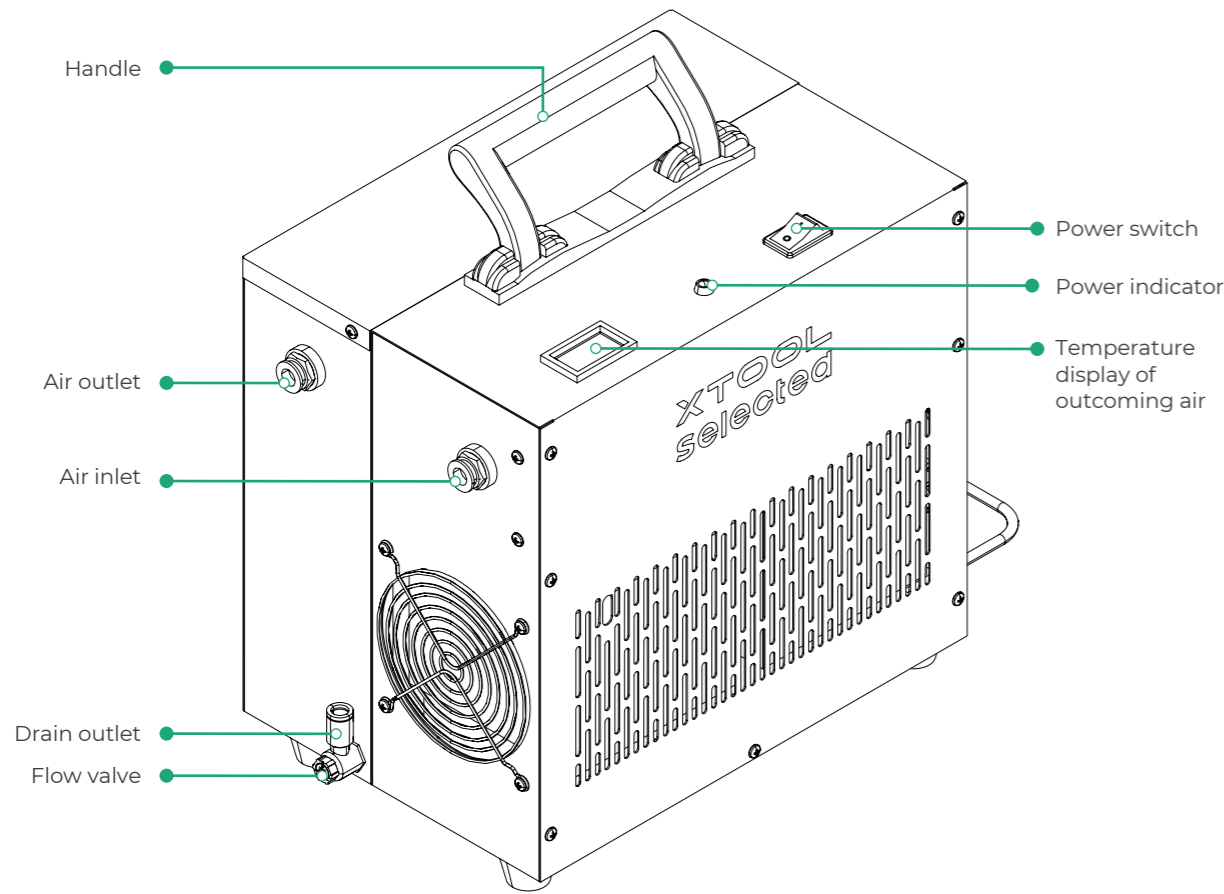

Product specifications

Model	Volume flow rate (L/min)	Operating pressure (MPa)	Voltage / Current (V / A)	Rated power (kW)	Air inlet temperature (°C)	Weight (kg)	Dimensions (W × H × D) (mm)
NP3-5AC	400	1.0	US: 110 / 4.8 EU: 220 / 2.6	0.38	≤45	10.8	402 × 355 × 227

Connections



Since the air dryer is designed to be used with the air compressor and the welder, this manual includes instructions for operating the air compressor. Please find the air compressor components from its package.

1 Connect the devices



Tube

Air compressor

Air dryer

Welder

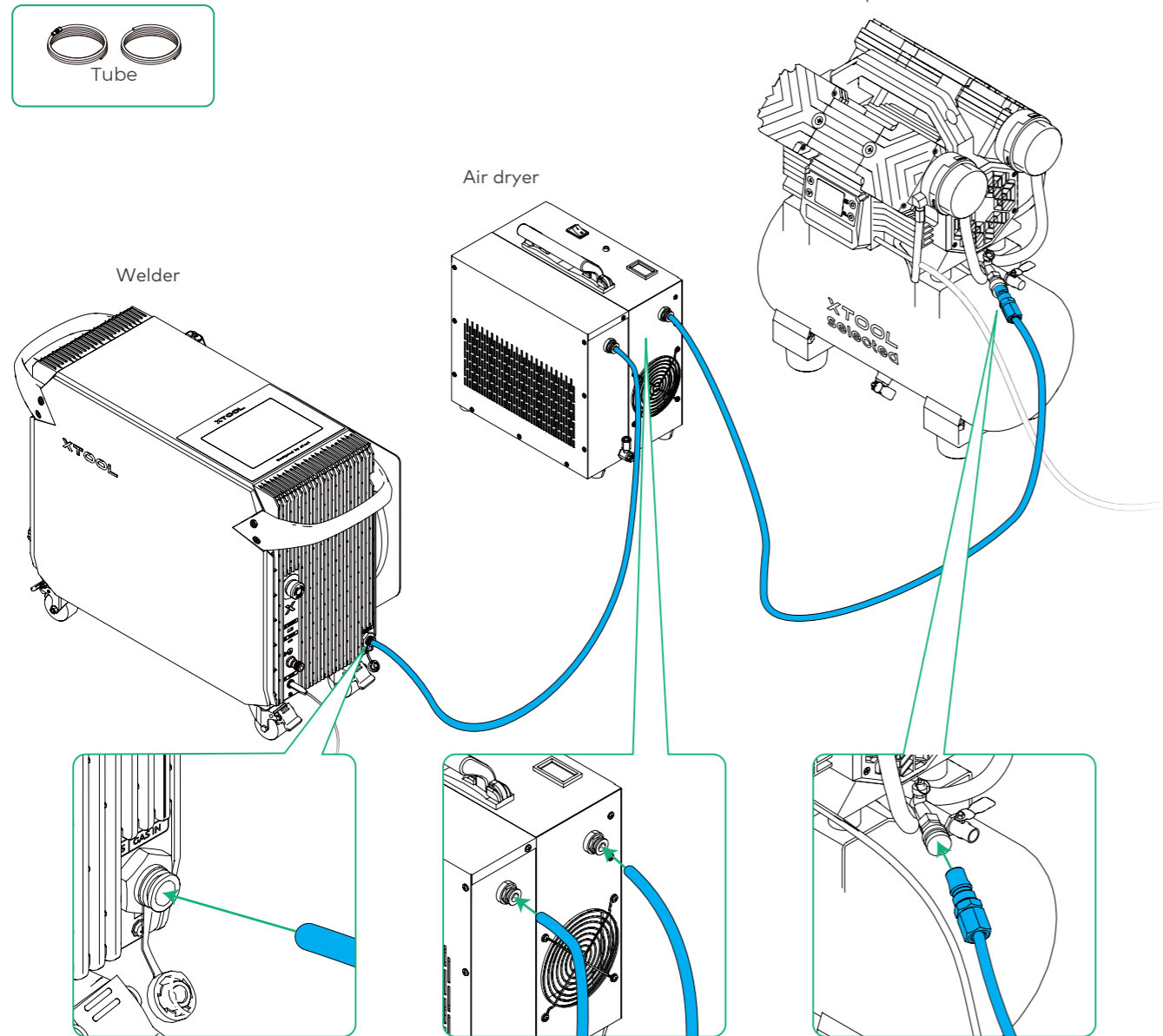

Removing tubes

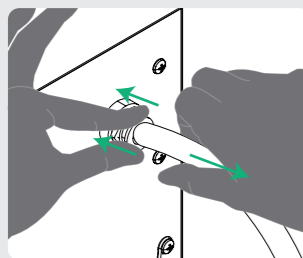

Air dryer

■ Press the connector collet and pull out the tube.

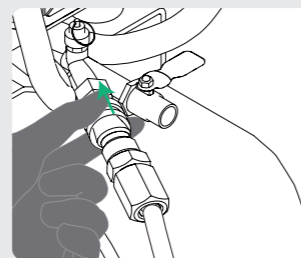

Air compressor

■ Press the connector collet and the tube will pop out automatically.

2 Connect drain tube



Drain tube (2 m)

■ Connect the drain tube to the drain outlet and guide the tube to a wastewater disposal area.

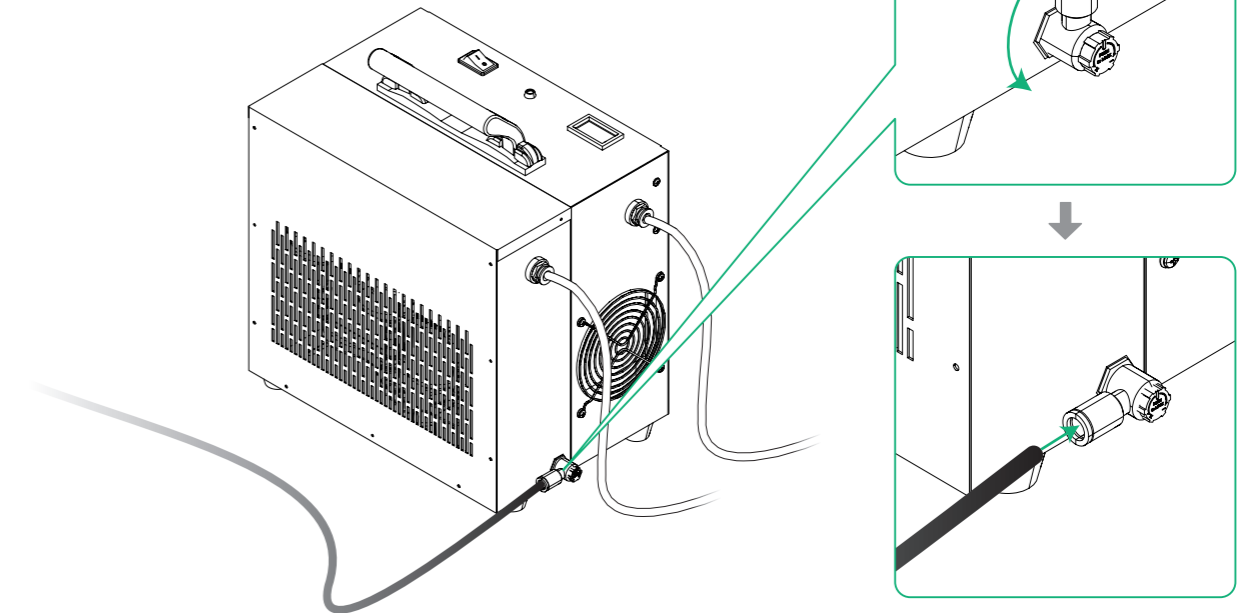

3 Connect to power supply



Power voltage requirements:

- Air dryer: US 110 V, EU 220 V
- Air compressor: US / EU 220 V

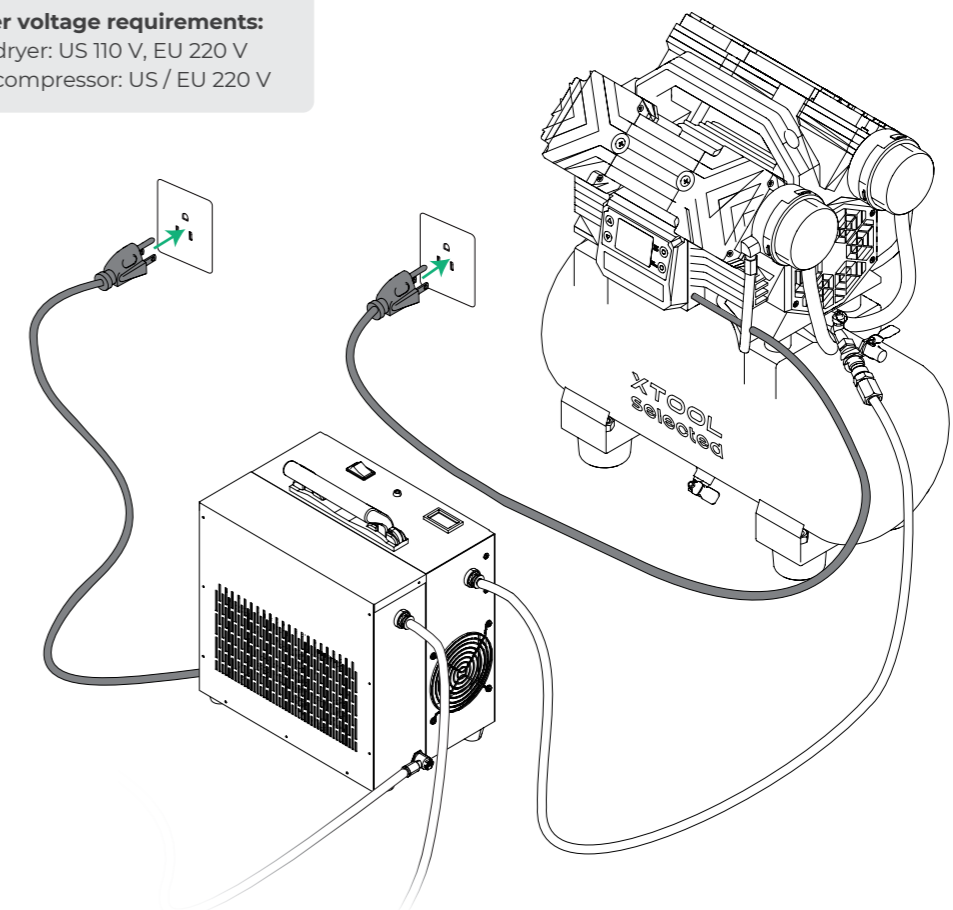

Use the devices

1 Power on

- Power on the air dryer first and then the air compressor.

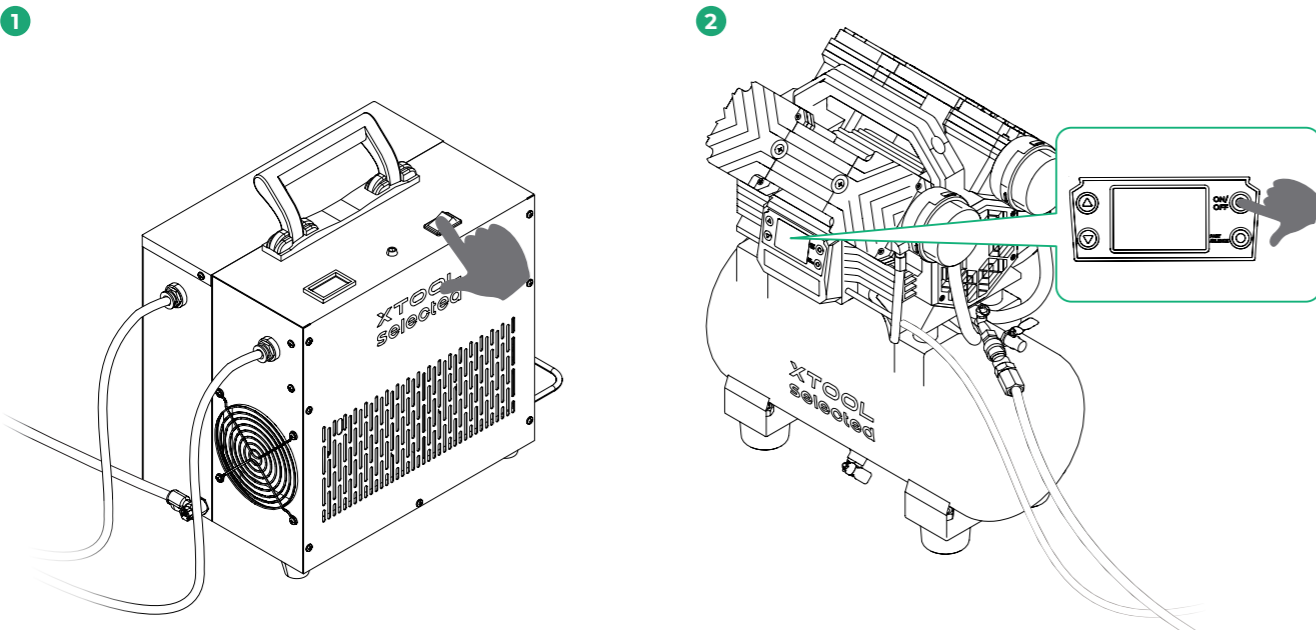

CAUTION

The air compressor's upper part heats up during operation. Do not touch it during operation or shortly after it shuts down.

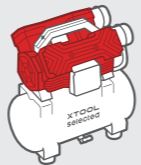

2 Check the safety valve of the air compressor

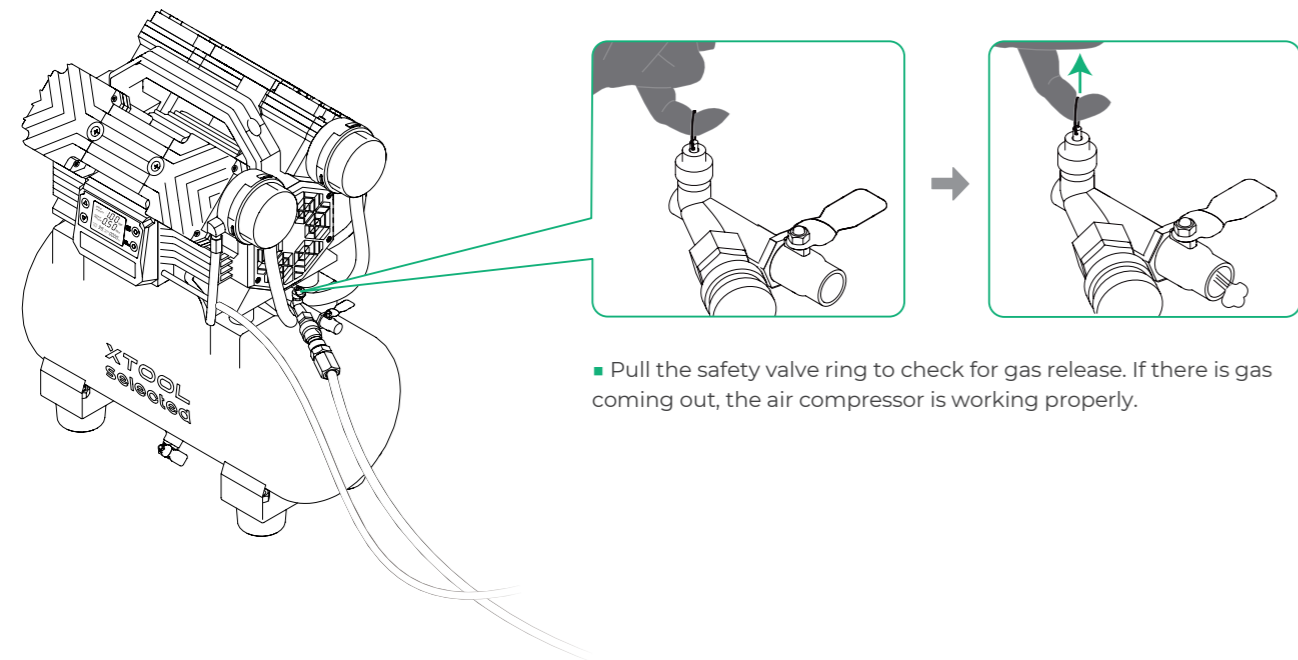

- Pull the safety valve ring to check for gas release. If there is gas coming out, the air compressor is working properly.

3 Set pressure

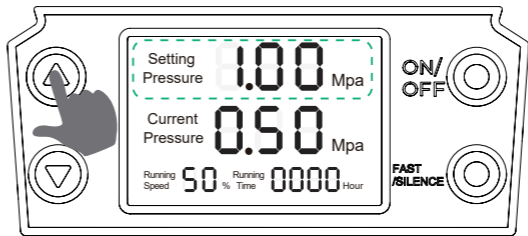

Pressure range: 0.3–1.0 MPa
Recommended pressure: 1.0 MPa
Up button: + 0.05 MPa per press
Down button: –0.05 MPa per press

The air compressor automatically stops working when the air pressure reaches the set value, and starts working again when the pressure drops 0.2 MPa below the set value.

- Once the air compressor's current pressure is steady, you can proceed to operate the welding machine.



To stop the air dryer and compressor, first turn off the air compressor and then turn off the air dryer.

4 Switch the speed mode

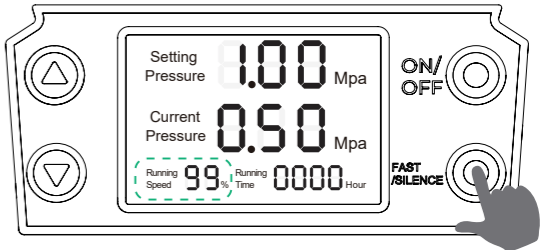

Press the FAST/SILENCE button to switch the operating speed. A speed of 99% indicates high-speed mode, while 50% indicates low-speed mode.

Recommended mode: FAST

Maintenance



Before performing any maintenance, disconnect the power supply.

Replace filters

After long period of use, the performance of the air dryer filters may degrade due to accumulated contaminants. You need to replace the filter elements in time.

1 Disconnect power and tubes

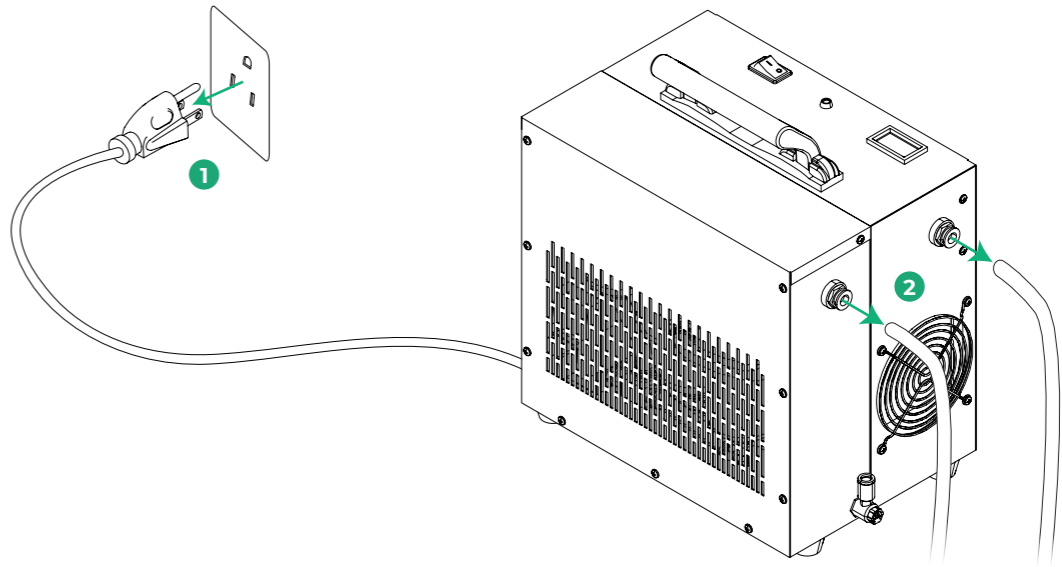

2 Remove the cover plate

(1) Remove the screws

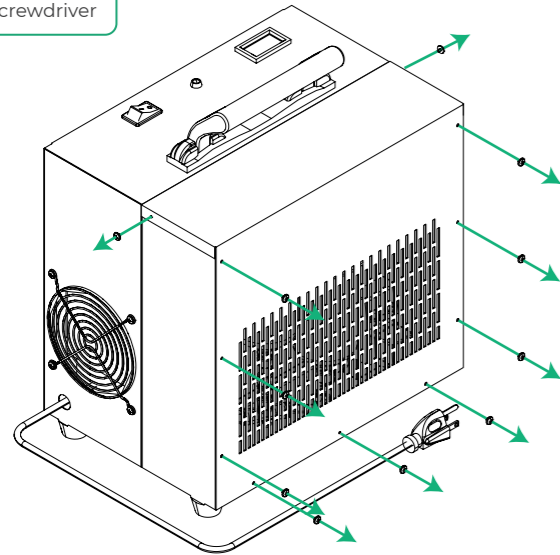

(2) Lift up the cover plate

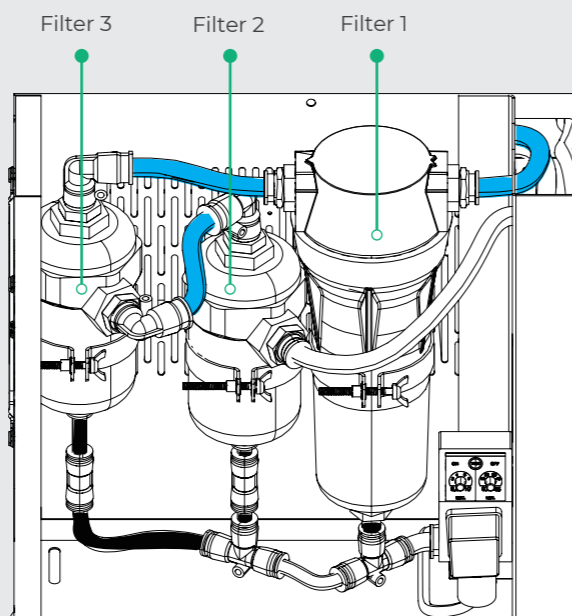
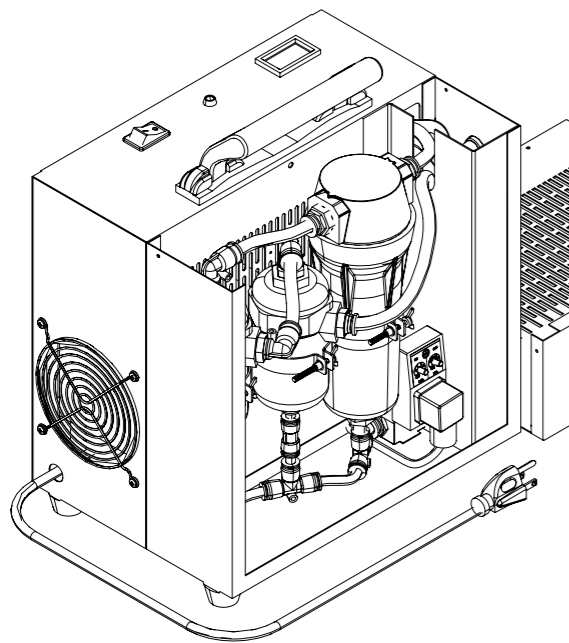
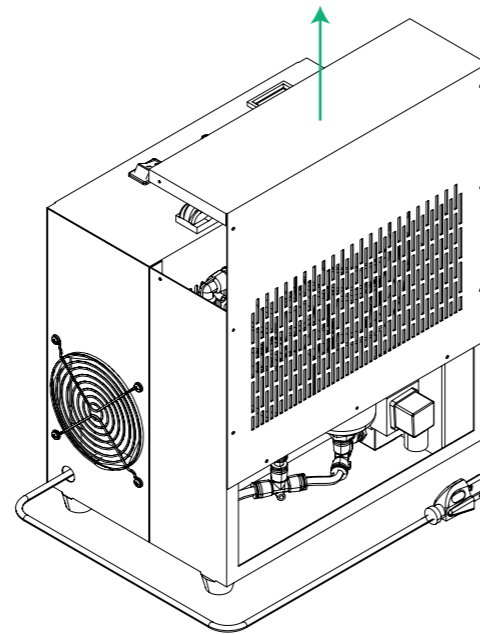

⚠ Only the blue tubes are removable. Do not operate the other tubes.

3 Remove tubes

Remove the highlighted tubes from the filter ports

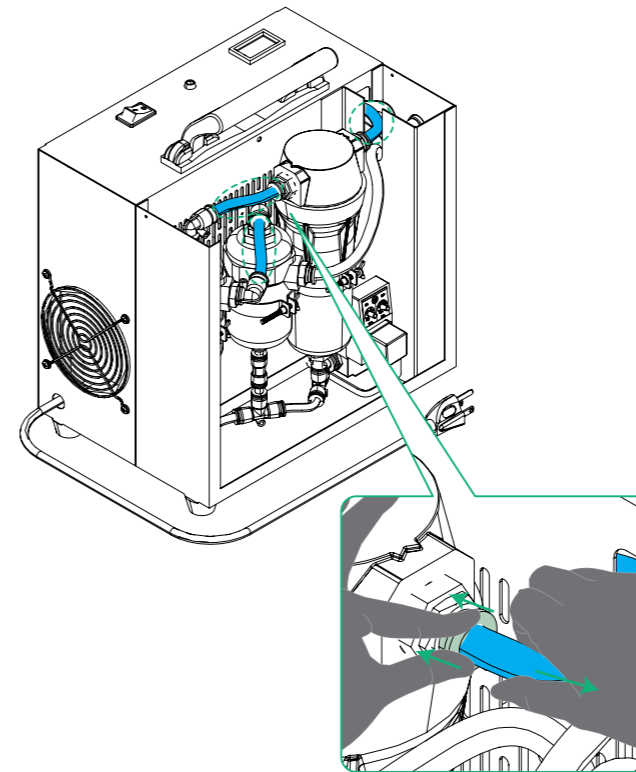

You should see this after removing the tubes

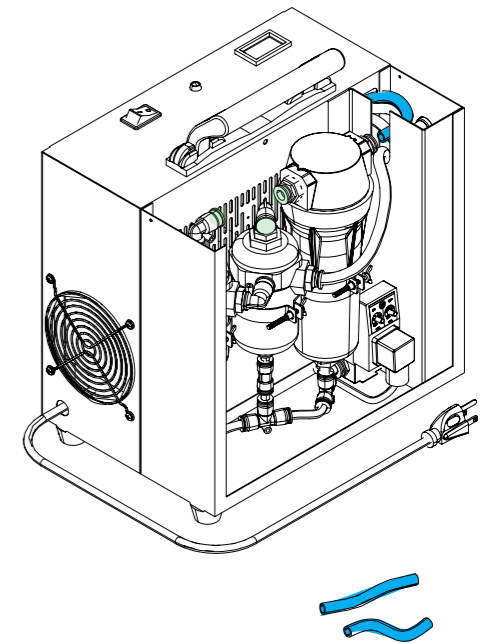

4 Remove the filter elements

(1) Loosen the three wing screws

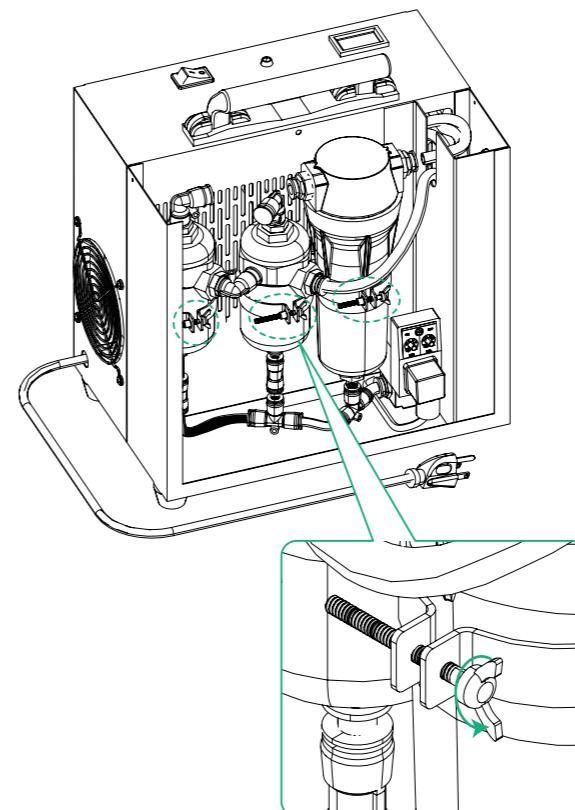

(2) Pull the upper part of filter 1 out for about 20° to 60°

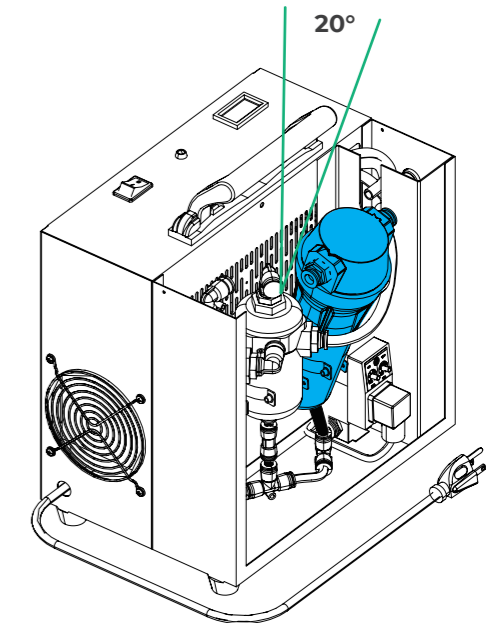

(3) Rotate to open the cover of filter 1

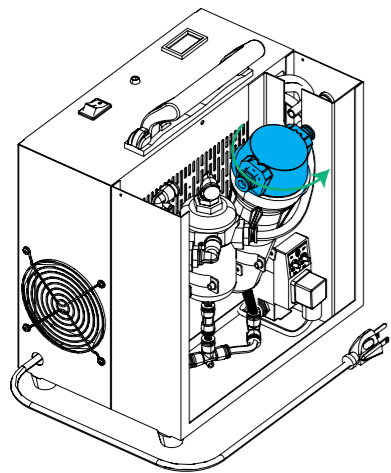

(4) Take out the filter element

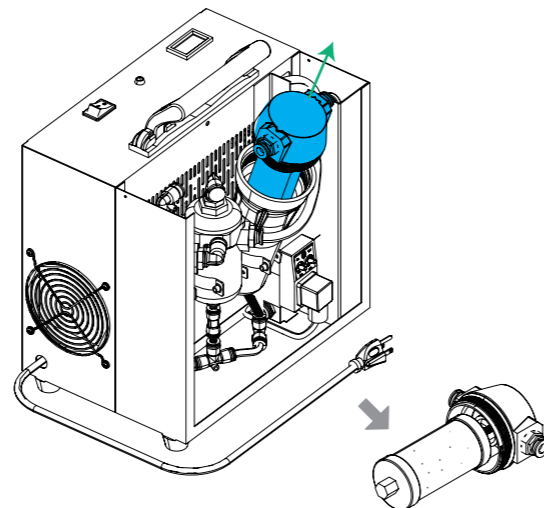

(5) Pull the upper part of filter 2 out for about 20° to 60 °

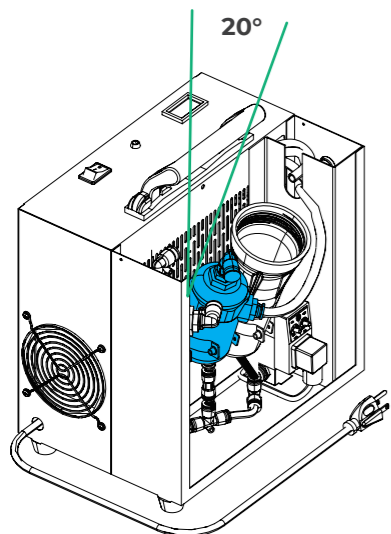

(6) Loosen the cover by using the wrench

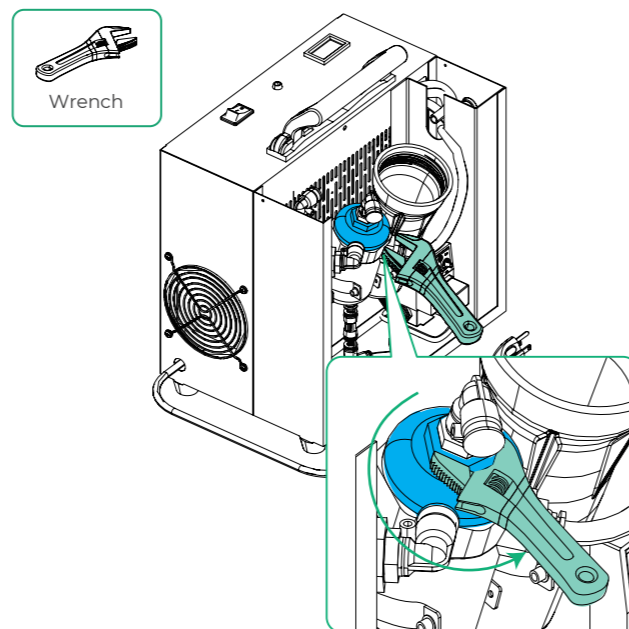

(7) Take out the filter element

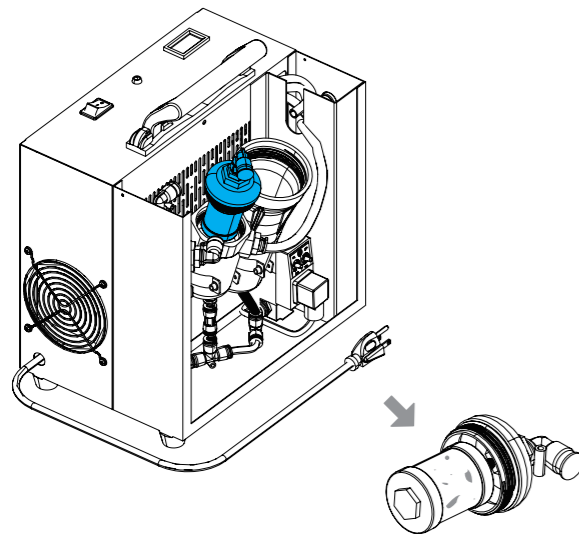

(8) Repeat steps 5-7 to take out the third filter element

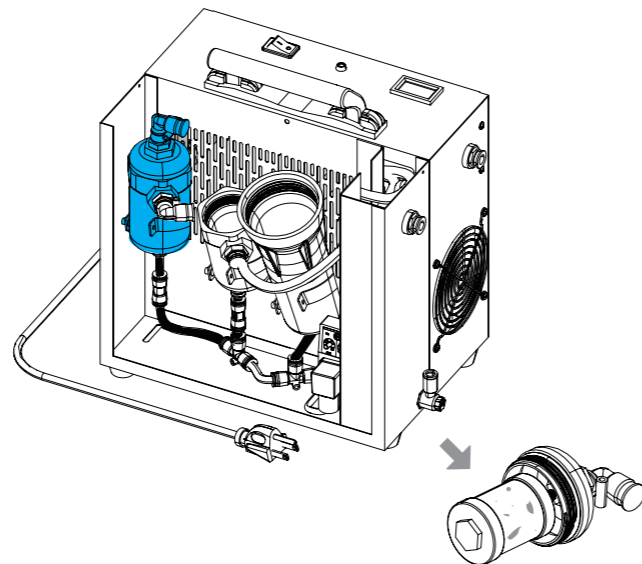

5 Replace filter elements

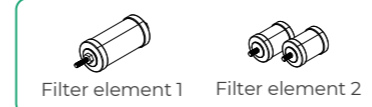

(1) Replace filter element 1

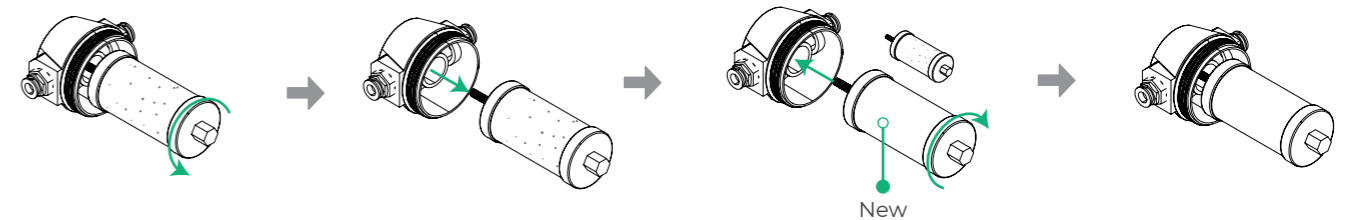

(2) Repeat the preceding to replace the other two filter elements



6 Re-install filter elements

(1) Insert the filter elements into their corresponding cases

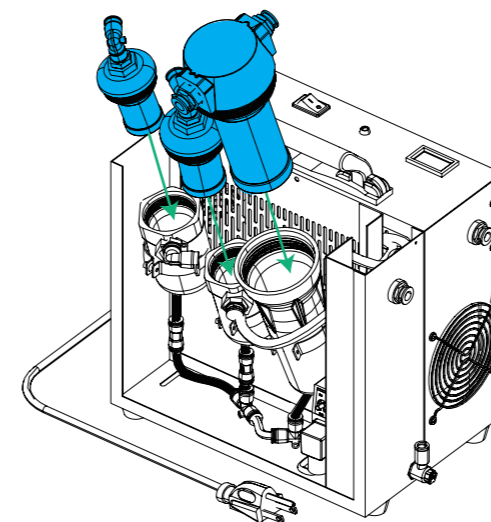

(2) Rotate to tighten the cover of filter 1 and use the wrench to tighten those of filters 2 and 3

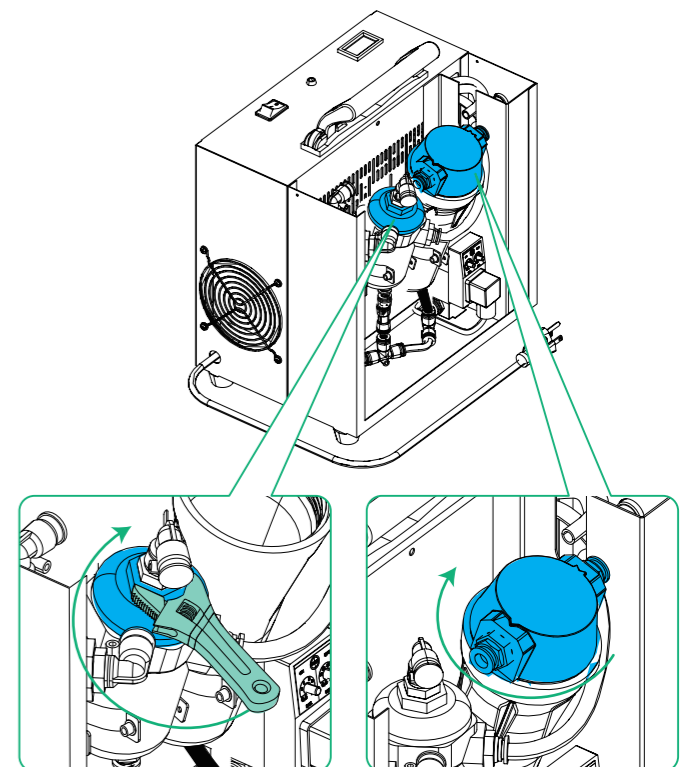

(3) Re-install and tighten the wing screws

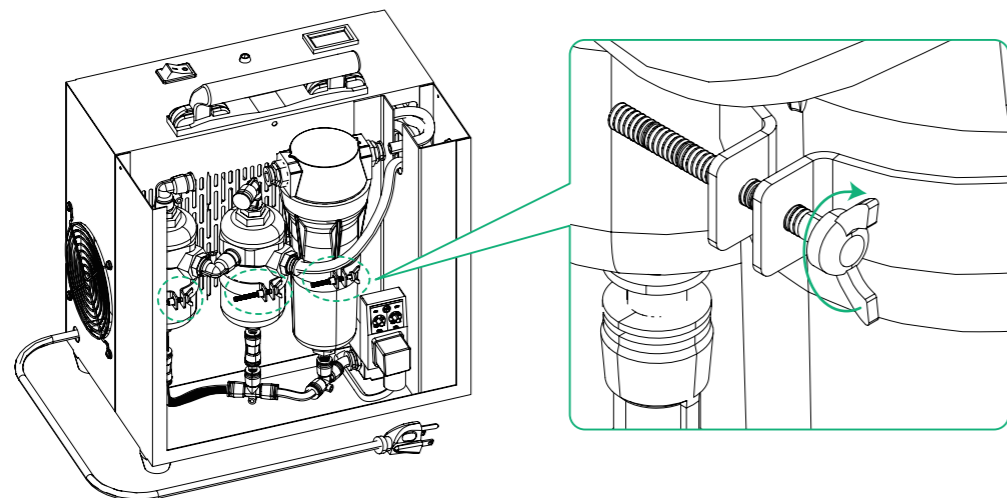

7 Re-connect tubes

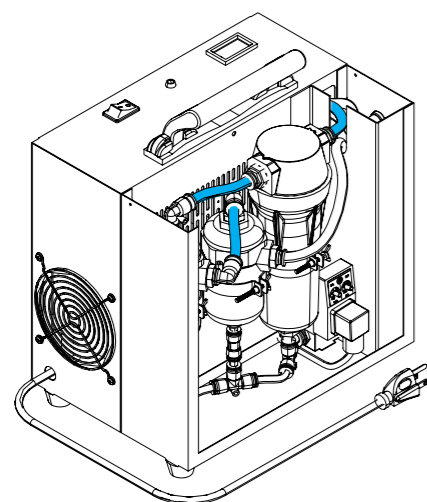

Check the connections

Connect the tubes to the air inlet and outlet. Then connect the power cable and check whether the air way is working properly.

8 Re-install the cover plate



Screwdriver

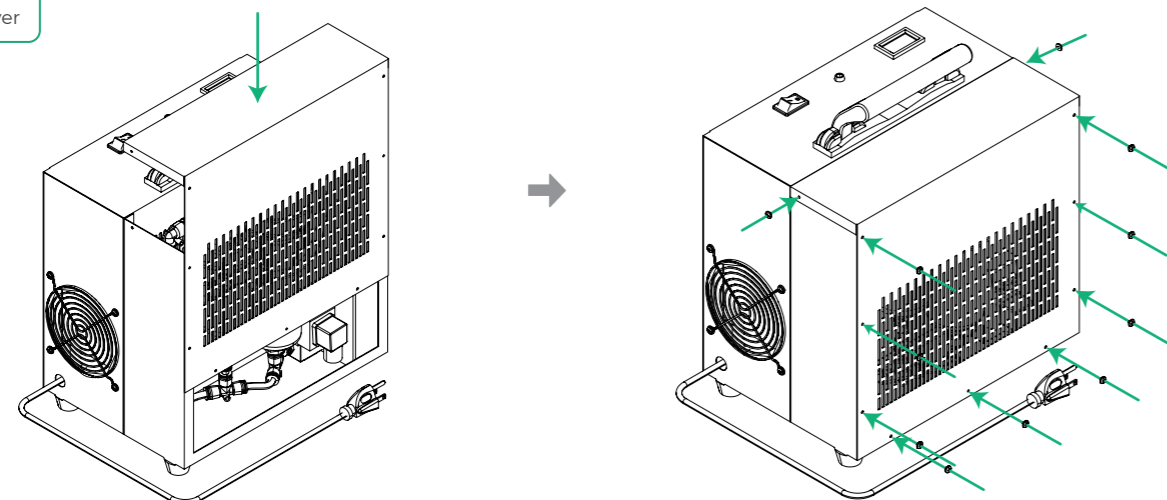

FAQ

1. What should I do if the air volume and pressure are insufficient?

Inspect all tube and pipe connections. If you find any leaks, apply tape to the threaded ends to ensure a secure connection. If xTool MetalFab CNC Cutter is connected and the xTool software displays an air pressure lower than 0.4 MPa, first verify the air compressor is set to 1 MPa in Fast mode as recommended.

If the settings are correct but pressure remains low, inspect all tube connections for leaks and check the compressor for damage.

2. Is it possible to shorten the tube connecting to the welder?

It is not recommended. A shorter tube may not effectively condense water, which could disrupt airflow to the welder.

3. What should I do if water enters the tube connecting the welder?

If the processing result is poor and water droplets are found on the lens protector, follow these steps to resolve the issue:

- 1) Stop using the welder's cutting function immediately.
- 2) Check the air dryer to ensure it is functioning properly.
- 3) Allow the air dryer to run and continue drying the air.
- 4) After some time, place a dry piece of cardboard near the welding head nozzle. If the cardboard remains dry, the air dryer is now supplying dry air.
- 5) Replace the lens protector and resume processing.

4. A low-pressure alarm is reported when the air dryer is connected to xTool MetalFab CNC Cutter. What should I do ?

To address this issue, reduce the flow speed by slightly turning the flow valve knob clockwise from its factory setting. Be careful not to rotate it too far.

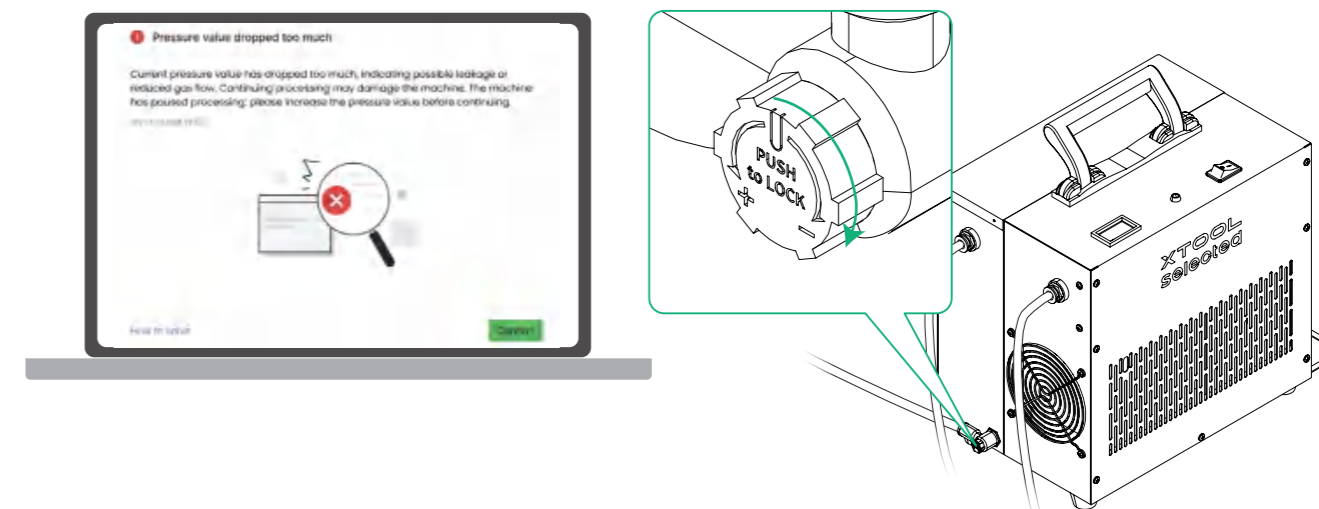

5. What is the temperature range of the air outlet of the air dryer?

With ambient temperature of 0°C to 40°C and relative humidity of 50% to 90%, the outlet air temperature maintains within 0°C to 40°C.

6. What should I do if a small amount of oil stains builds up on the lens protector after long-term continuous cutting (e.g., 8 hours)?

The lens protector has a limited lifespan. An oil-stained lens protector may negatively affect dross adhesion. You can wipe the lens protector by using a cotton swab or lint-free cloth dampened with alcohol.