

XTOOL | P3

Quick Start Guide



List of items	01
Meet your xTool P3	02
Meet your xTool SafetyPro™ IF2 2.0	03
Preparations	04
Use xTool P3	13
Understand the annular indicator and control knob	14
Use the material clamps	15

List of items



xTool P3



Power cable



USB cable



Antifreeze



Funnel



Material clamp



Masking tape



Cardboard



Basswood 3 mm



Smoke exhaust pipe



Quick start guide



Safety instructions

xTool SafetyPro™ IF2 2.0 kit

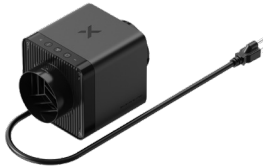

xTool SafetyPro™ IF2 2.0



Ribbed plastic anchors



Screw M3*10



Smoke exhaust pipe



Wall-mounting fixture



Hex key 2 mm



Tool kit



Key



Double-end screwdriver



Hex key 1.5 mm



Hex key 3 mm



Screw M3*6



Screw M3*5



Screw M4*10



Screw M3*10



Self-tapping screw ST2.9*9.5

*All the screws in the tool kit are spare.

Meet your xTool P3

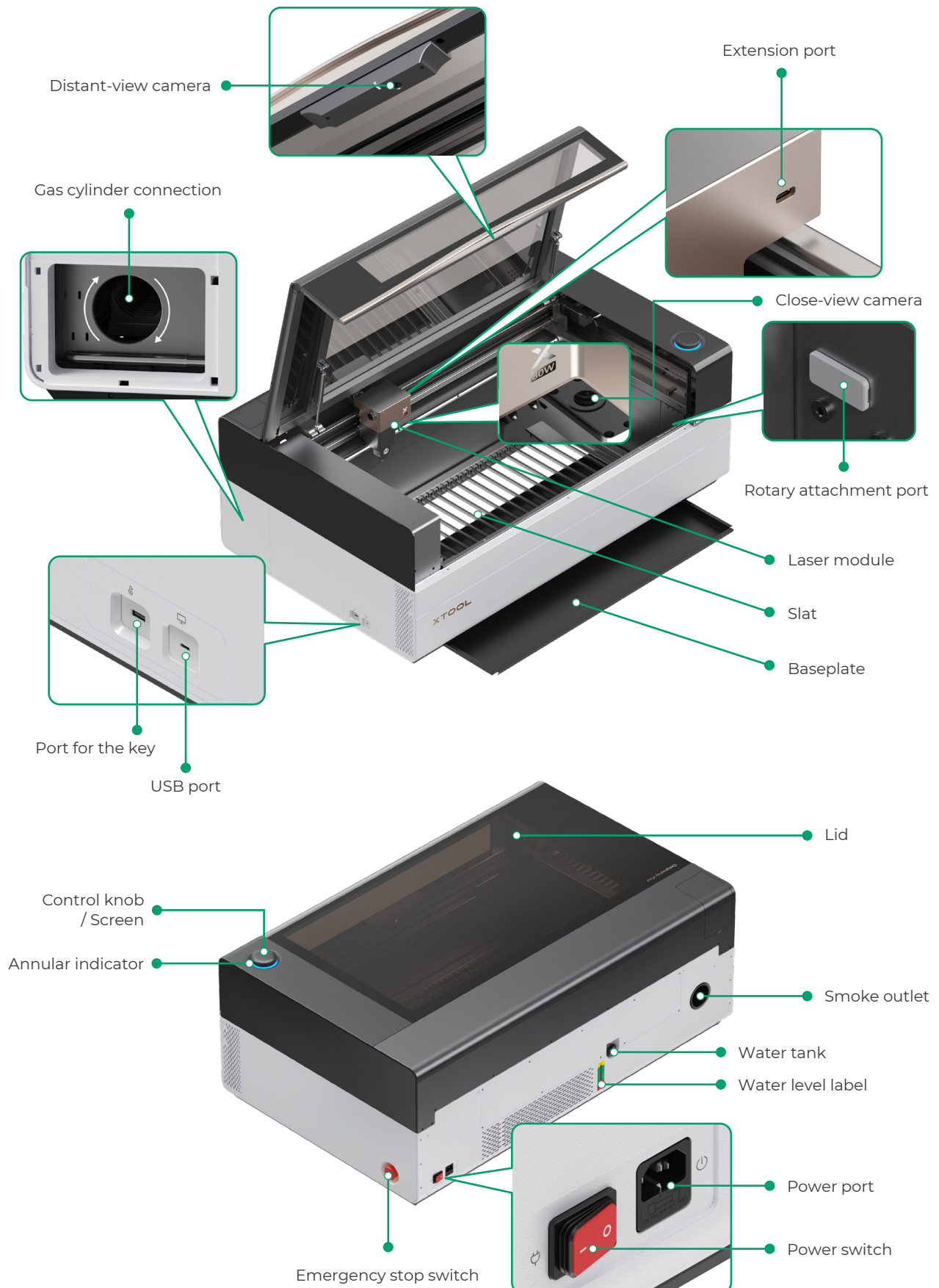

Meet your xTool SafetyPro™ IF2 2.0

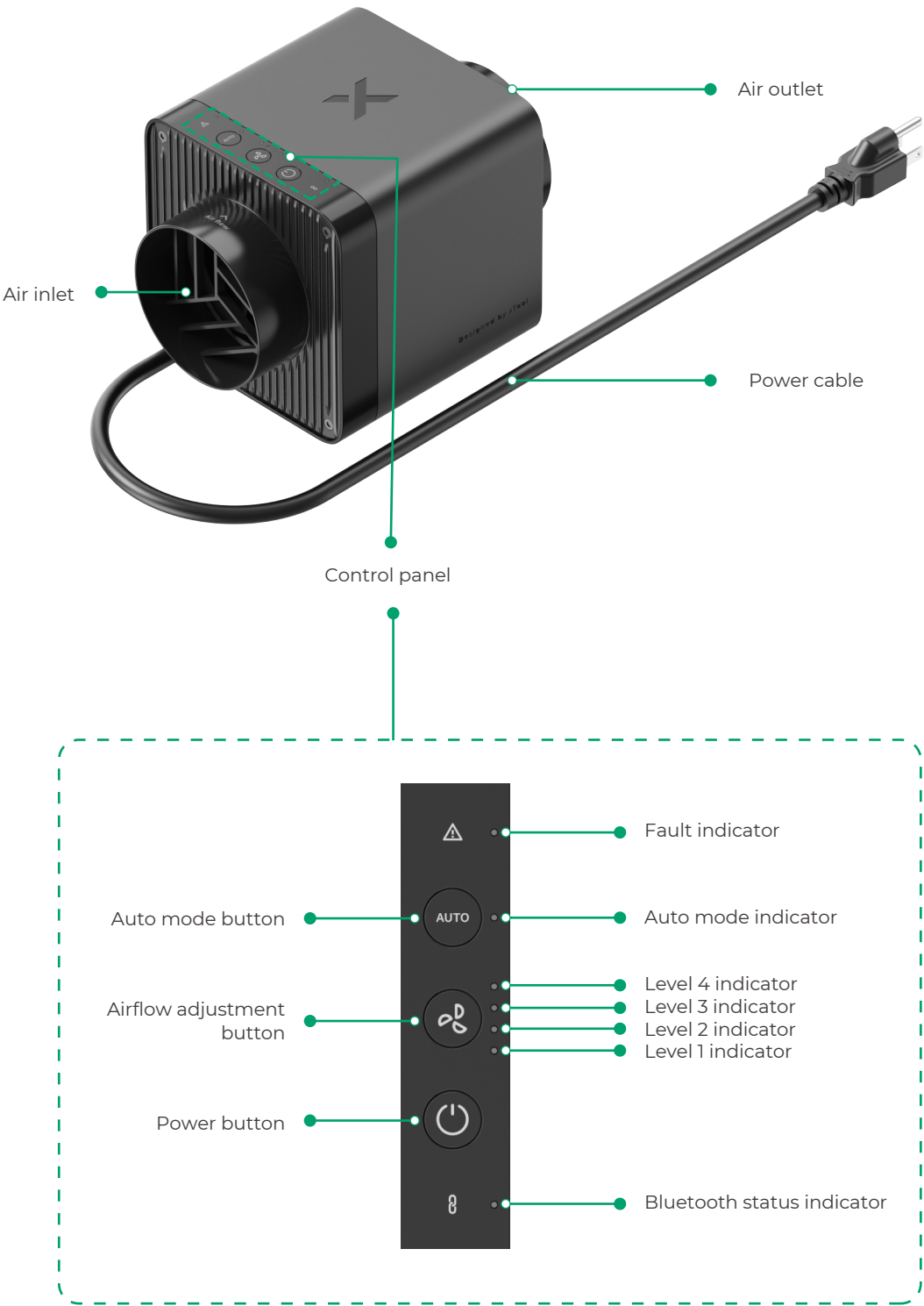

Preparations



Do not connect the device to a power supply before filling the antifreeze.

- 1 Check the casing of the device. If it is severely damaged, do not use the device and contact xTool after-sales services.



- 2 Open the lid and take out the items.

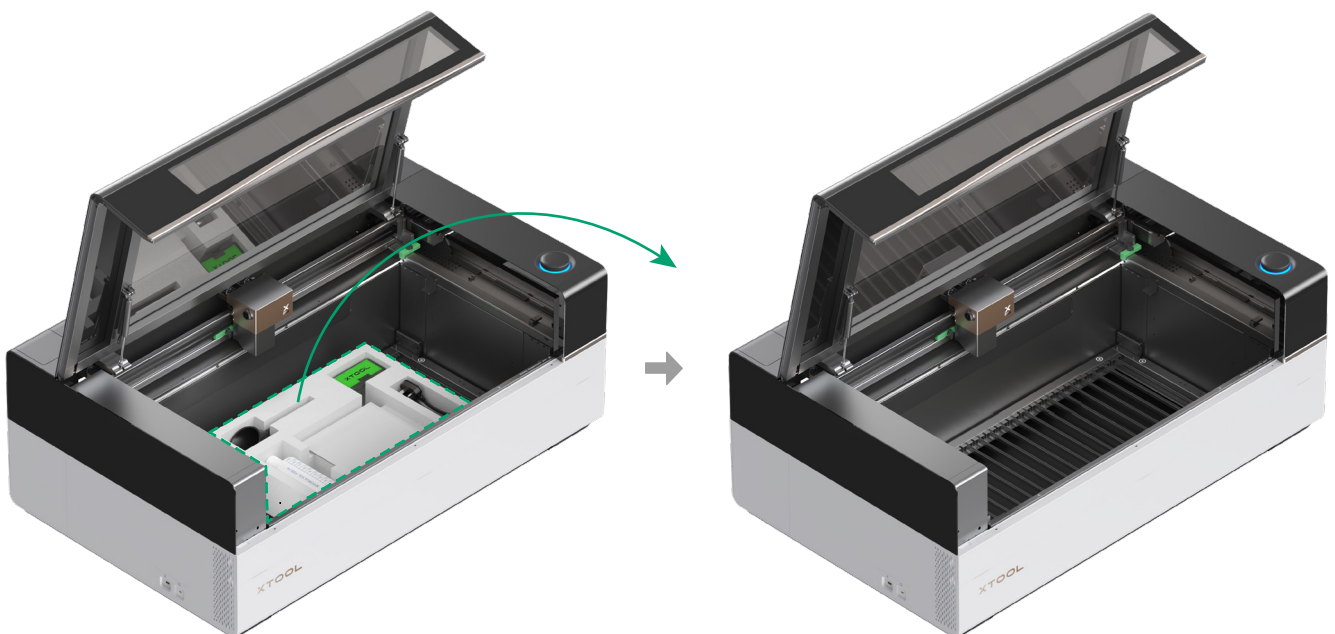

3 Remove the thumb screws on the x-axis and y-axis guide rails.

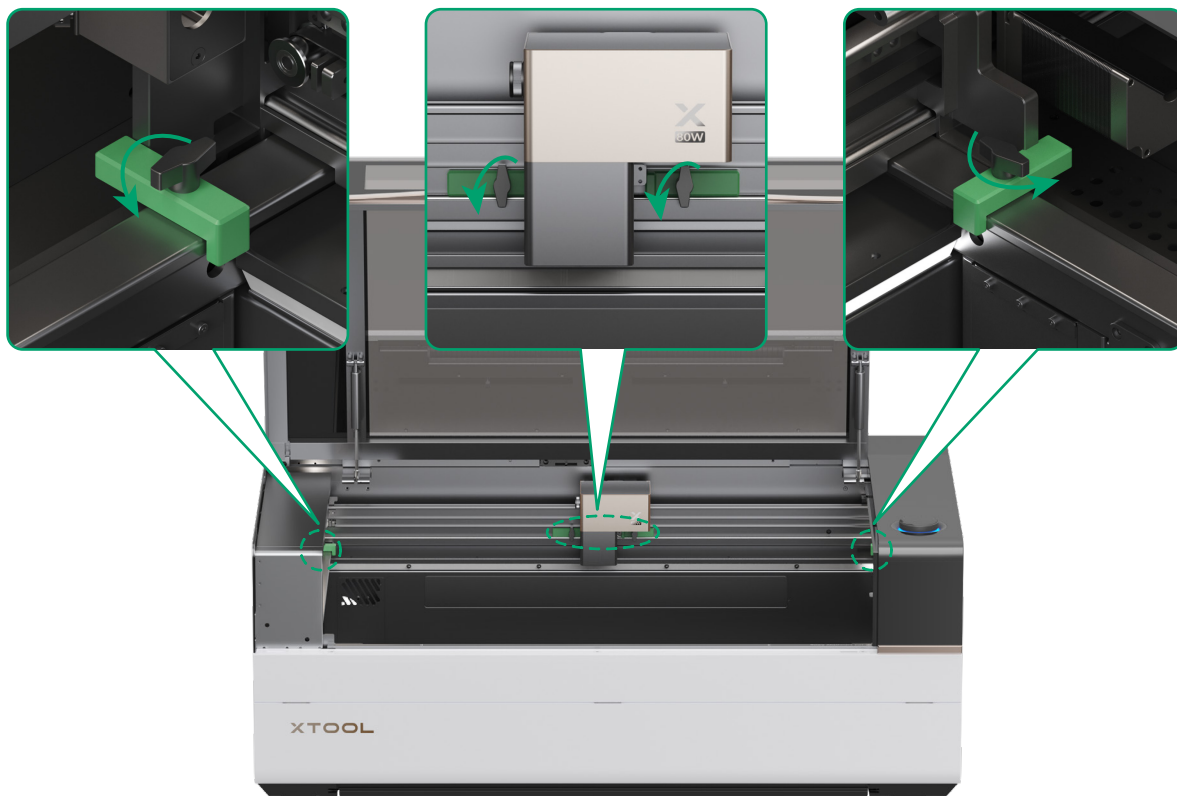

4 Insert the access-control key.



The key can function as both an access control key and an interlock connector. For more information, go to support.xtool.com/article/1367.



- 5** Turn the emergency stop switch to reset it.

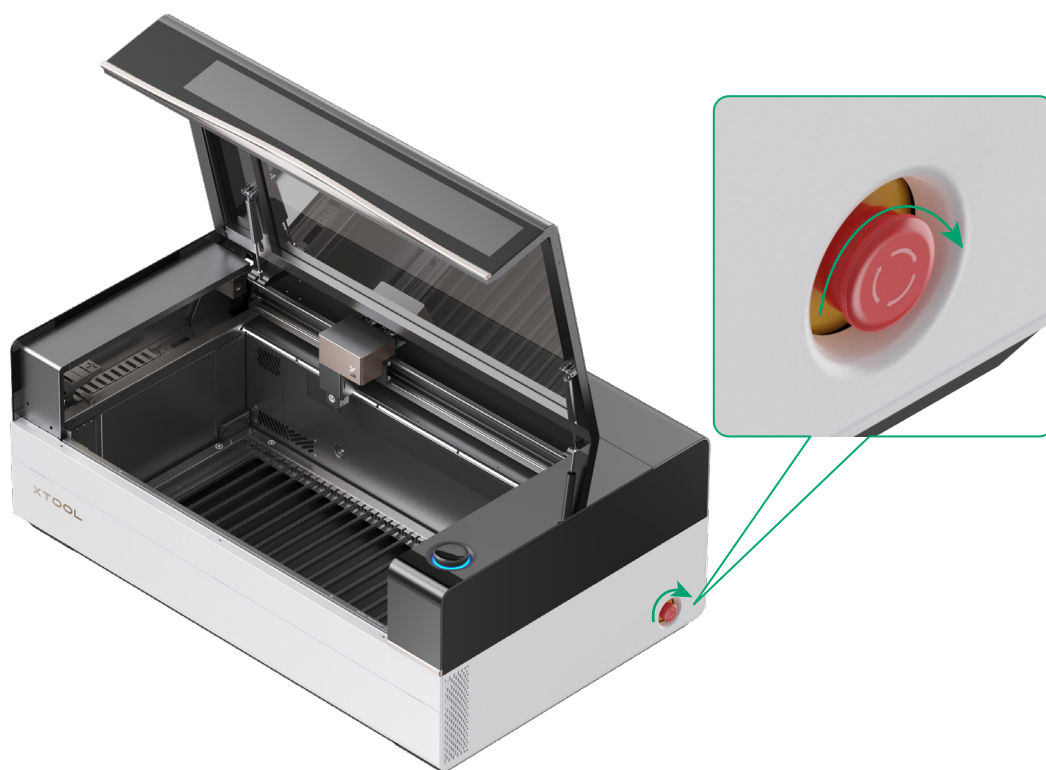

- 6** Manually move the laser module to check whether it can move properly.
If yes, close the lid. If no, do not use the device and contact xTool after-sales services.

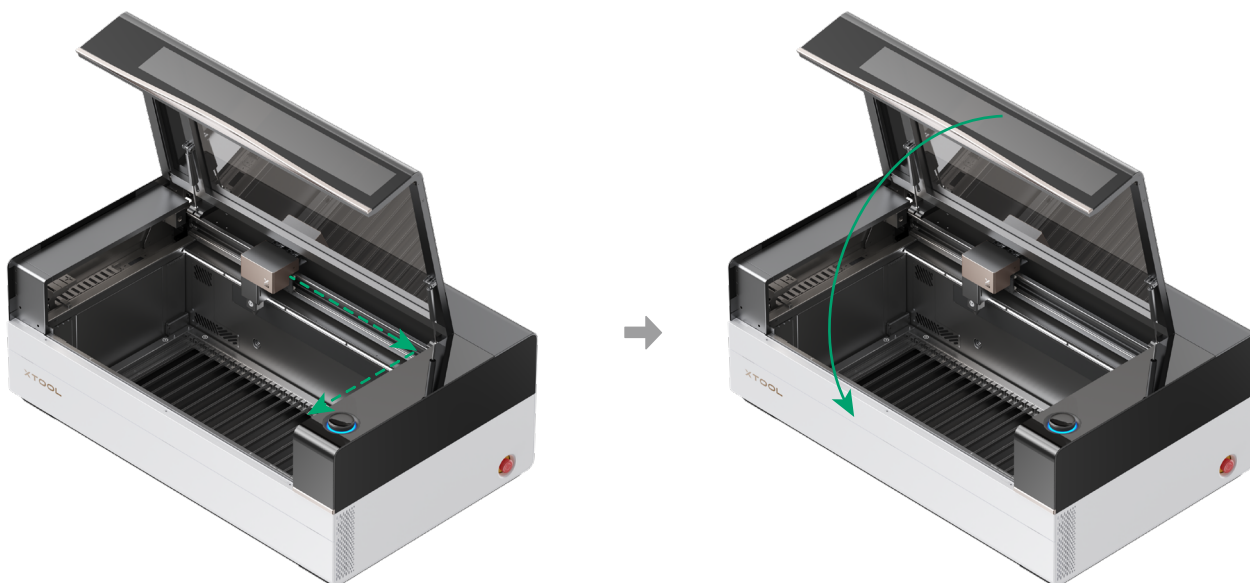

7 Fill the water tank with antifreeze.



■ Prepare a measuring glass to measure purified water.



■ If you do not have a measuring glass, you can store the remaining antifreeze in another container and use the bottle of antifreeze to measure purified water.



- Determine the volume of the antifreeze to be used according to the lowest annual temperature in your region first.
- Ensure that you use purified water to prepare the antifreeze. Tap water contains impurities and bleach, which may cause too many bubbles, affecting the working of the laser tube and even damaging the laser tube.
- Strictly follow the steps below to fill the water tank with the recommended volumes of antifreeze and purified water. To avoid overflow, be careful during the filling.

(1) Determine the volumes of antifreeze and purified water to be used

Lowest annual temperature in your region (°C)	Recommended concentration (%)	Antifreeze (ml)	Purified water (ml)
$T > 0$	0	0	1200
$-10 \leq T \leq 0$	20	240	960
$-20 \leq T \leq -10$	35	420	780
$-30 \leq T \leq -20$	45	540	660
$-40 \leq T \leq -30$	50	600	600
$-50 \leq T \leq -40$	60	720	480

* The capacity of the water tank is 1200 ml.

(2) Open the water tank cap and insert the funnel

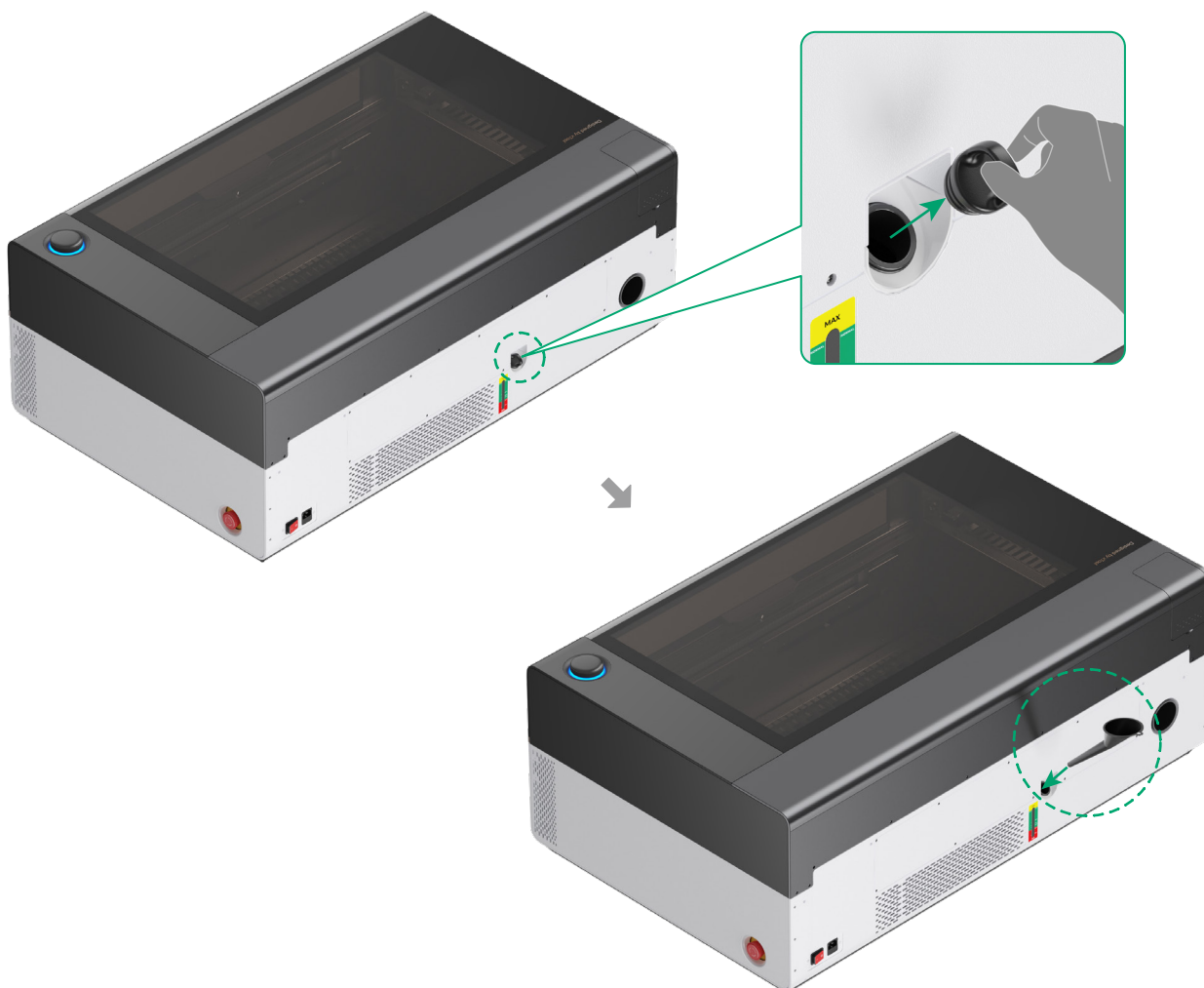

(3) Start the filling (Take -10°C as an example)

Refer to the table in (1), and fill 240 ml of antifreeze until the water level reaches the -10°C mark on the label.

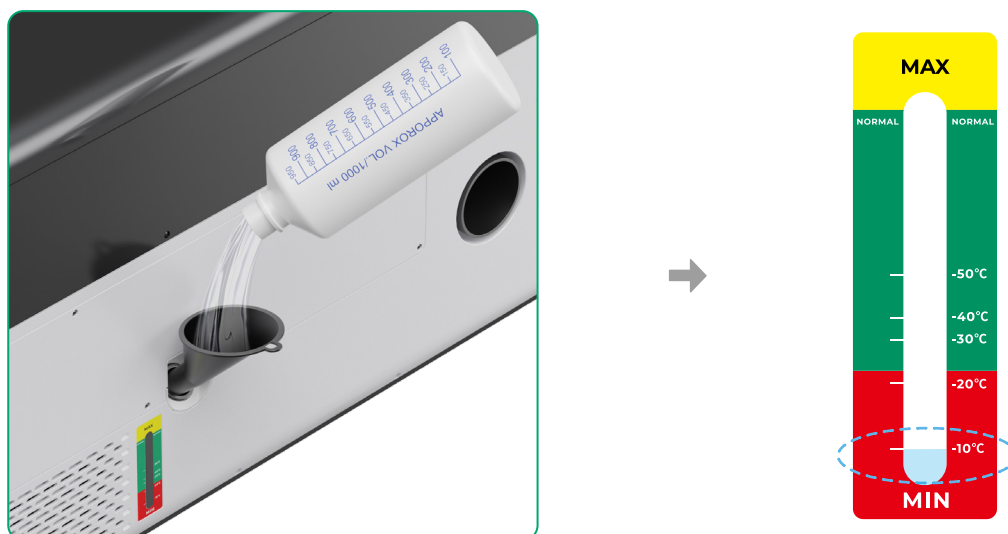

Slowly pour 960 ml of purified water until the water level reaches the NORMAL mark, then close the water tank cap. Observe the water level during the filling to avoid overflow.

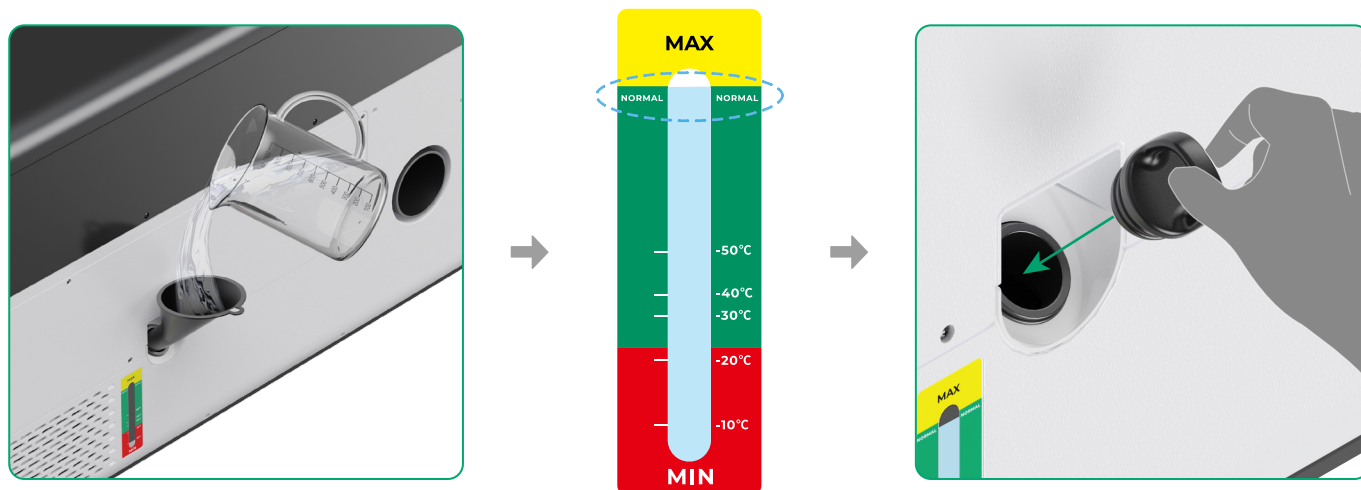

(4) Connect the device to a power supply and turn on the device



Make sure you add the antifreeze into the water tank before connecting the device to a power supply.

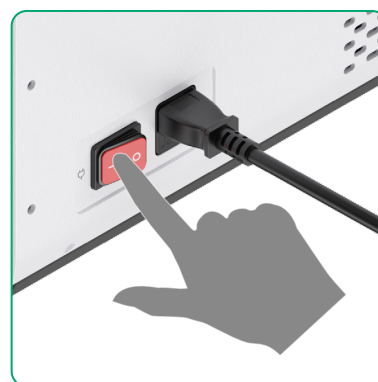
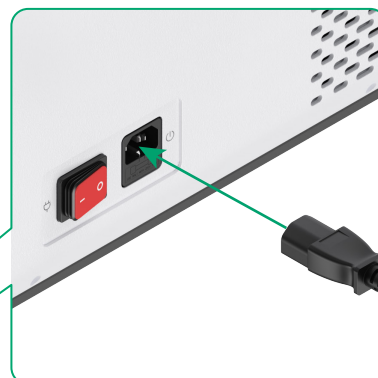
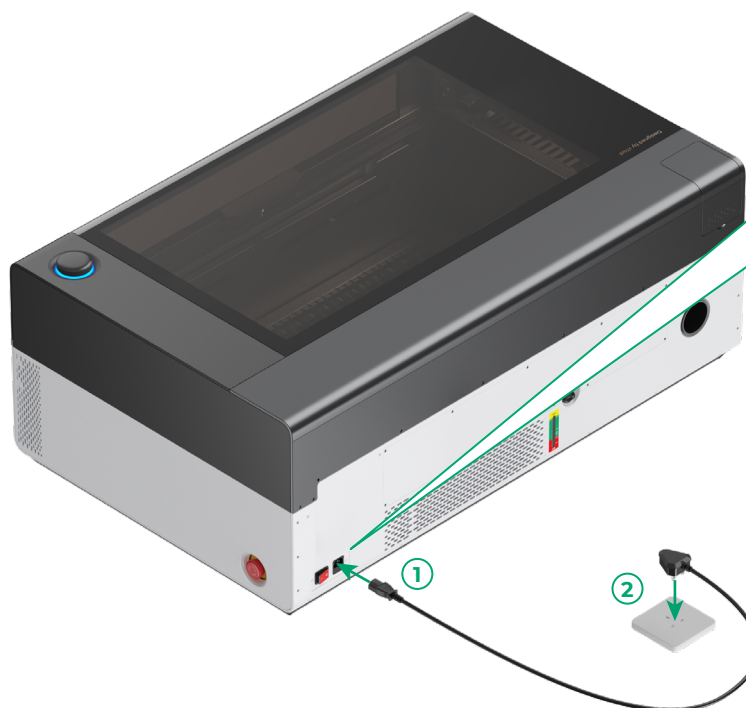

8 Install the smoke exhaust pipe.

Connect xTool P3 to xTool SafetyPro™ AP2 and xTool SafetyPro™ IF2 2.0.



xTool SafetyPro™ AP2 sold separately.

For details on how to connect xTool P3 to the latest version of xTool SafetyPro™ AP2, read the user manual of it.

Use with xTool SafetyPro™ IF2 2.0

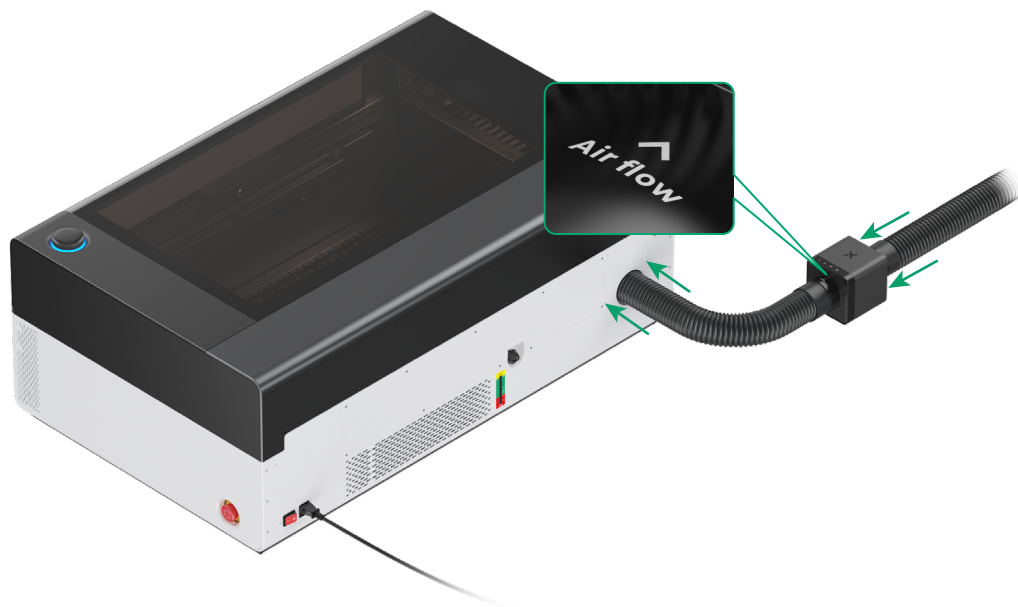

Use with xTool SafetyPro™ AP2

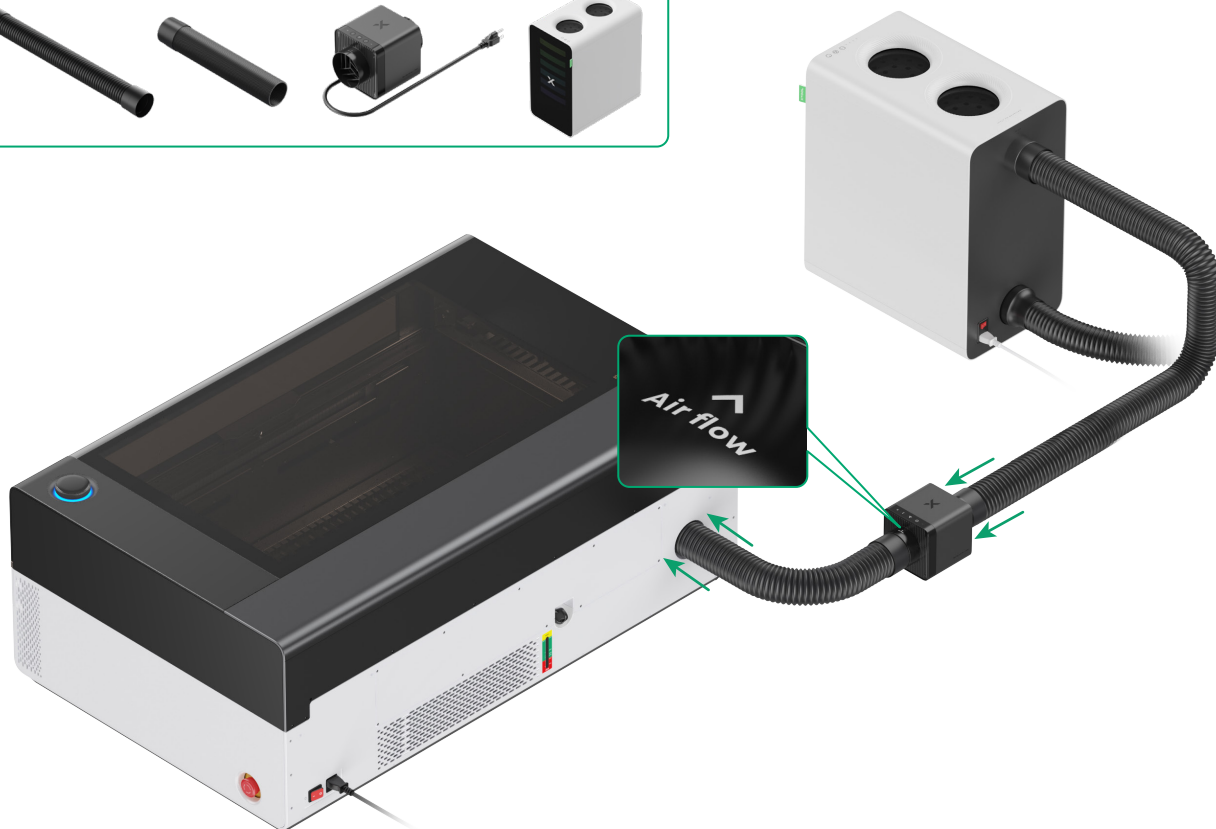

9 Set up wireless connection

A Bluetooth is internally installed in xTool P3. After the inline fan is connected to xTool P3, it automatically establishes a connection via Bluetooth. The device settings page of xTool P3 on the xTool software displays information about the inline fan. For more details, visit the link or scan the QR code.



s.xtool.com/support/IF22.0/tutorial

10 (Optional) Mount the inline fan on the wall

You can mount the inline fan on the wall or other suitable locations using the wall-mounting fixture included in the package.



The following tools are required but not included in the package:



Phillips screwdriver



Pencil



Drill

(1)

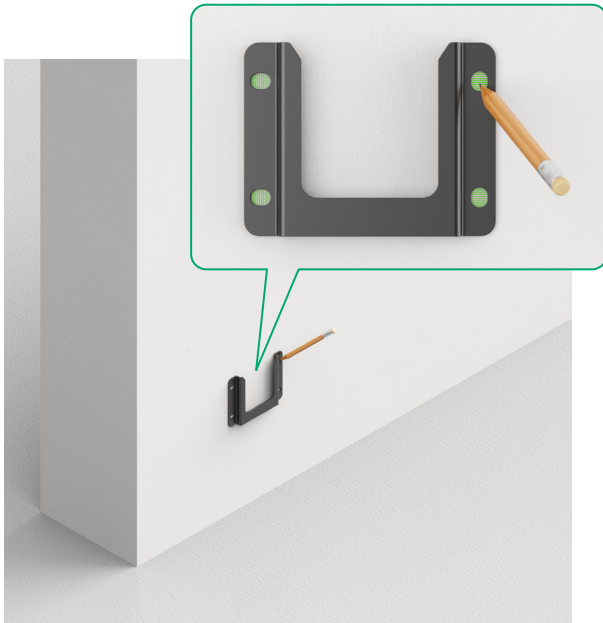

Determine the proper position, place the wall-mounting fixture against the wall, and mark each hole's location with a pencil.

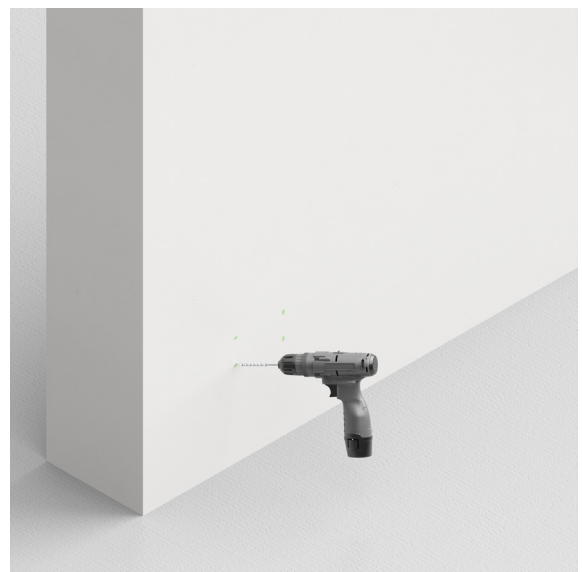

Drill the four holes marked.

(2)

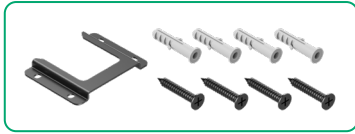

To better secure the screws, you can hammer the ribbed plastic anchors into the holes before applying the screws.

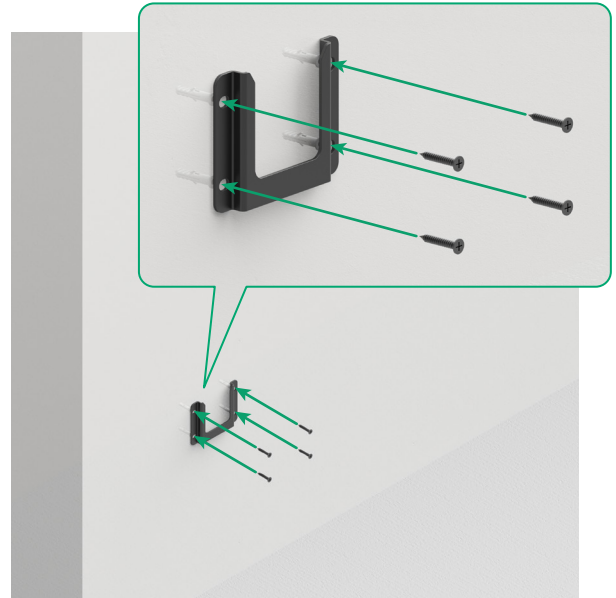

(3)

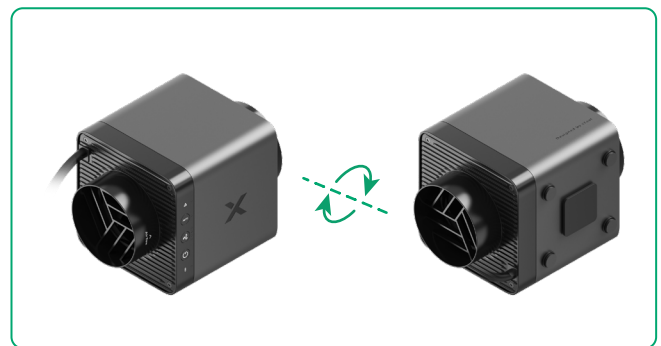
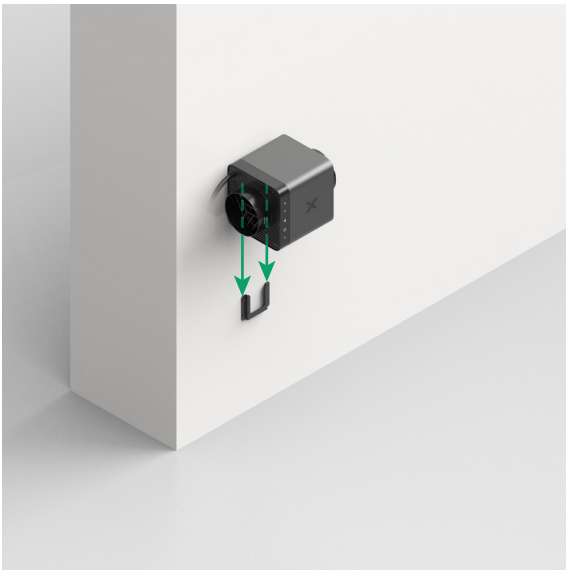

Slide the fan body along the fixture, with the wall-mounting bracket of the fan fitting on the fixture.

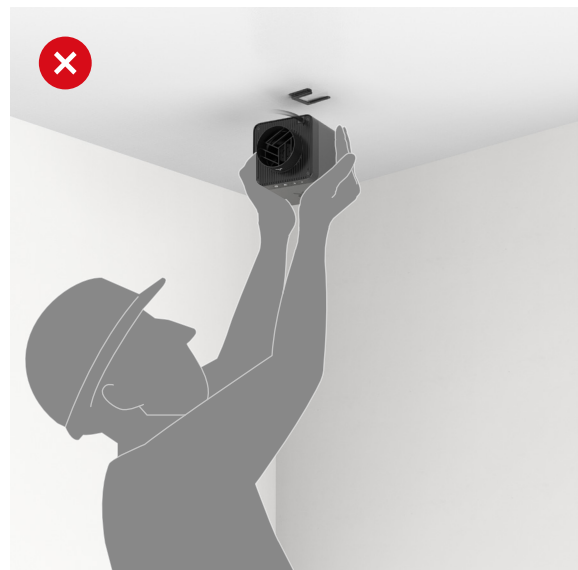
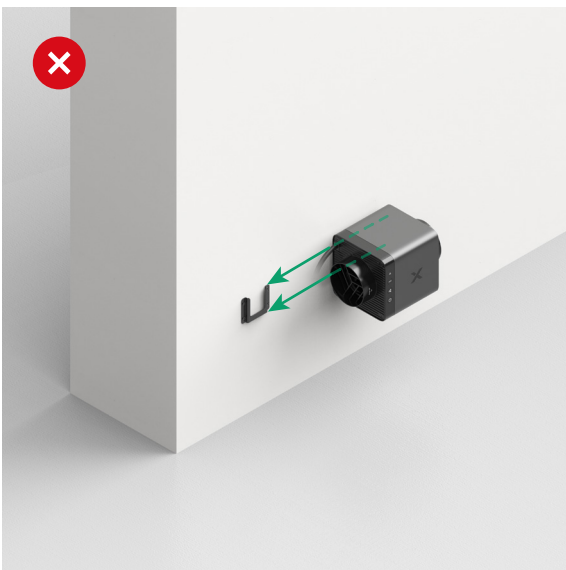

Never mount the wall-mounting fixture sideways or mount on a ceiling. Otherwise, the inline fan may not be fixed properly.

(4)



Use xTool P3

1 Get the xTool software

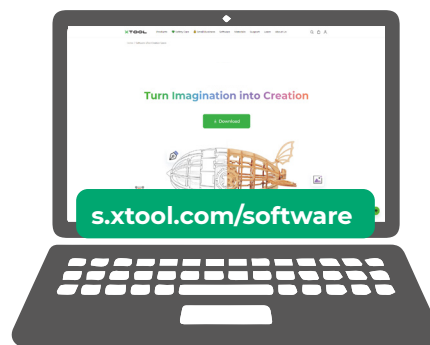

Go to s.xtool.com/software to get the xTool software.

2 Connect xTool P3 to your computer

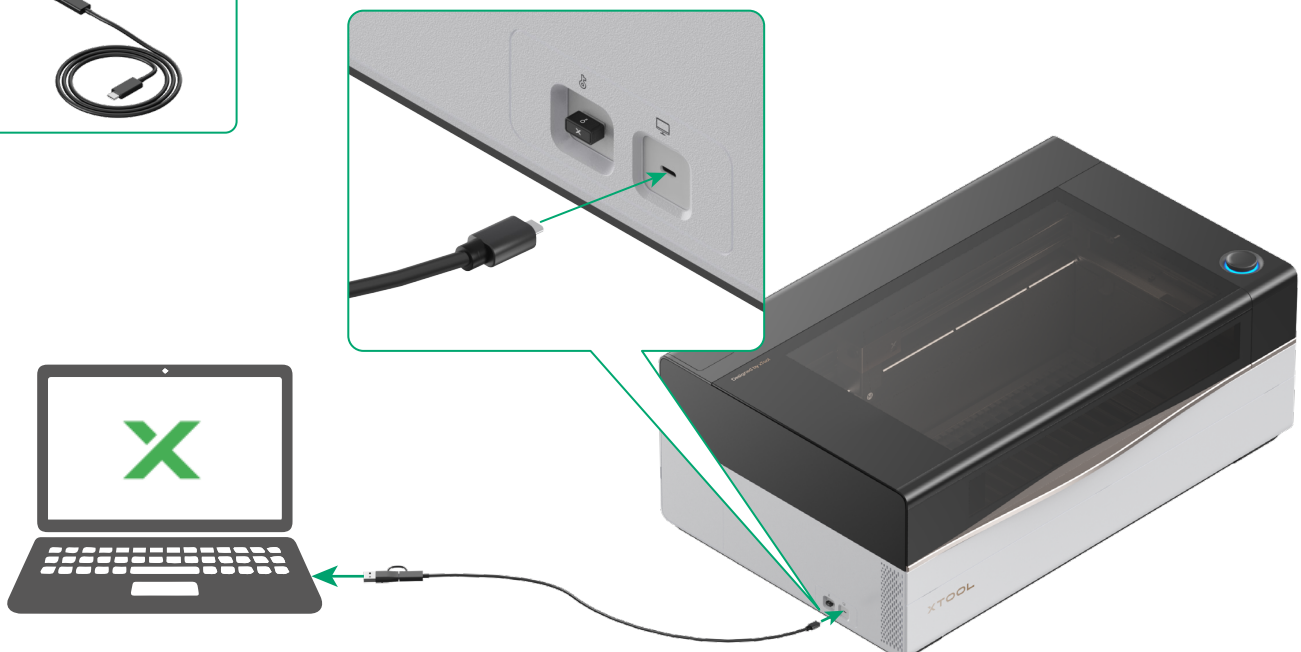



support.xtool.com/article/2007

Understand the annular indicator and control knob

Understand the annular indicator

Annular indicator	Device status
Solid white	Standby, not connected to the network
Blinking blue slowly	Ready to work
Solid blue	Standby, connected to the network
Solid purple	Bluetooth configuring
Solid purple	Firmware updating
Solid yellow	AP network configuring
Solid green	Processing completed
Solid red	Exceptions occur

Understand the control knob

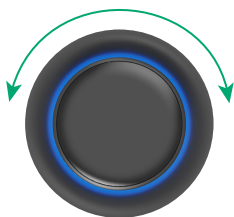

Turn the knob:

- Switch between options
- Adjust the parameters



Press the knob:



- Enter the option
- Confirm the parameter



Hold down for 2s:

- Exit the option

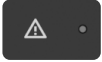
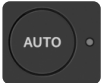
Understand the indicator of the inline fan

Indicator	Indicator status	Device status
 Bluetooth status indicator	Blinking white	Enters pairing mode
	Solid white	Pairing succeeds
	Off	Pairing fails or Bluetooth connection not established
 Fault indicator	Solid red	Inline fan motor stalls and the fan blades need cleaning
	Blinking red	Firmware upgrade fails
 Auto mode indicator	Solid white	The inline fan works in AUTO mode
 Airflow adjustment indicator	Solid white	The inline fan works at the current airflow level
The fault indicator and Bluetooth status indicator blink alternately: Firmware upgrade in progress The fault indicator and Bluetooth status indicator are off and the buzzer sounds once: Firmware upgrade succeeds		

Use the material clamps

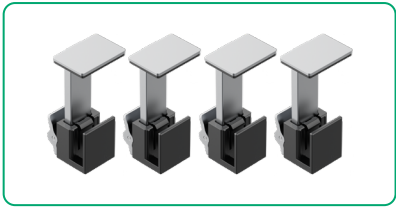

$0 < H \leq 25 \text{ mm}$



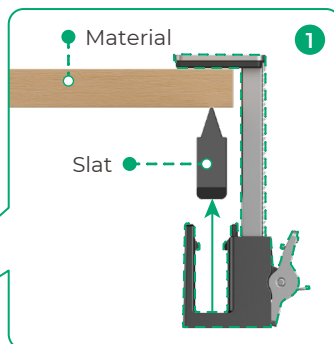
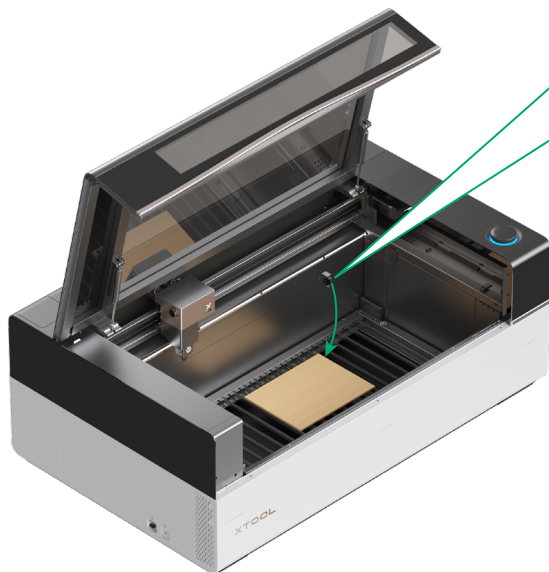

Push the clamp upwards to secure the slat at the bottom

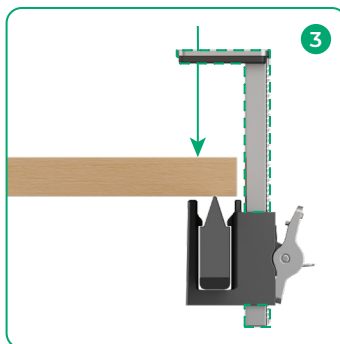
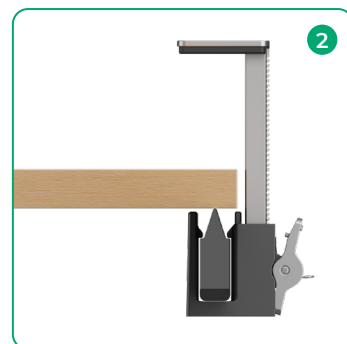

Adjust the clamp's height according to the thickness of the material

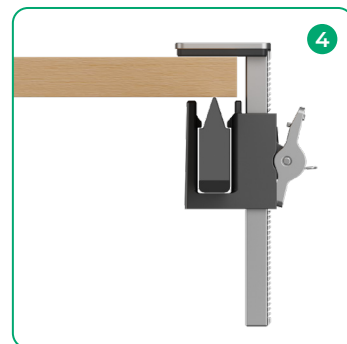

Fit the other three material clamps in the same way.

XTOOL