

XTOOL | SafetyPro™ IF2 2.0

Quick Start Guide



List of items	01
Meet xTool SafetyPro™ IF2 2.0	02
Connect xTool SafetyPro™ IF2 2.0	03
(Optional) Mount on the wall	07
Use xTool SafetyPro™ IF2 2.0	09
Indicator description	10
Use with xTool software	11
Maintenance	11

List of items

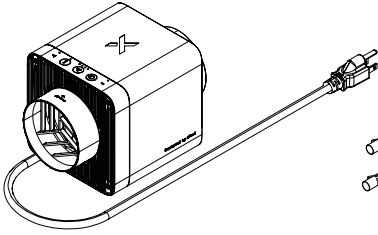

SafetyPro™ IF2 2.0



Ribbed plastic anchors



Screws

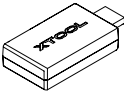

Bluetooth dongle

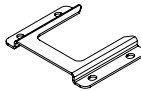

Wall-mounting fixture

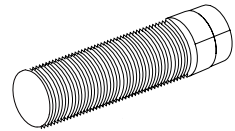

Smoke exhaust pipe

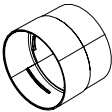

Pipe connector 1

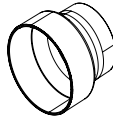

Pipe connector 2



Pipe clamp

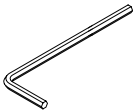

Hex key



Quick start guide



Safety instructions



■ The power cable may vary depending on the region and country where the product is delivered.

■ Pipe connector 1 is compatible with xTool machines' rigid exhaust pipes (hard and shape-adjustable) with a diameter of 80 mm.

■ Pipe connector 2 is compatible with both rigid and flexible exhaust pipes with a diameter of 65 mm.

Meet xTool SafetyPro™ IF2 2.0

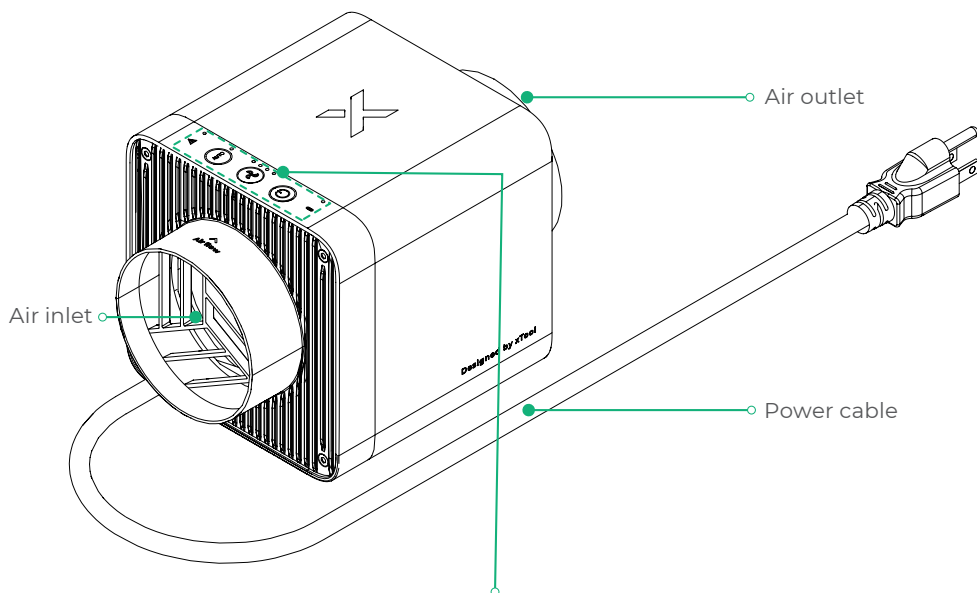

Control panel

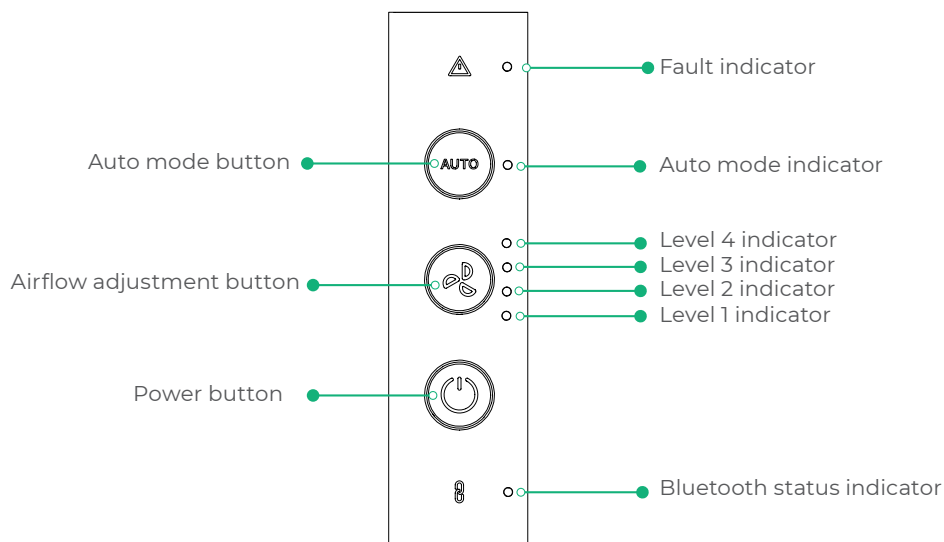

Connect xTool SafetyPro™ IF2 2.0

1 Connect the smoke exhaust pipe of the xTool laser machine

**Pipe connector 1:**

Used for connecting rigid exhaust pipes (hard and shape-adjustable) with a diameter of 80 mm.

**Pipe connector 2:**

Used for connecting rigid exhaust pipes (hard and shape-adjustable) with a diameter of 65 mm.

**Pipe clamp:**

Used for connecting flexible exhaust pipes of xTool P2 and P2S.

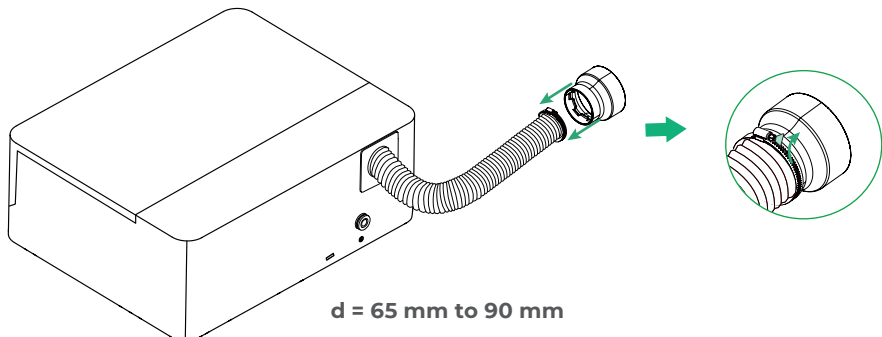
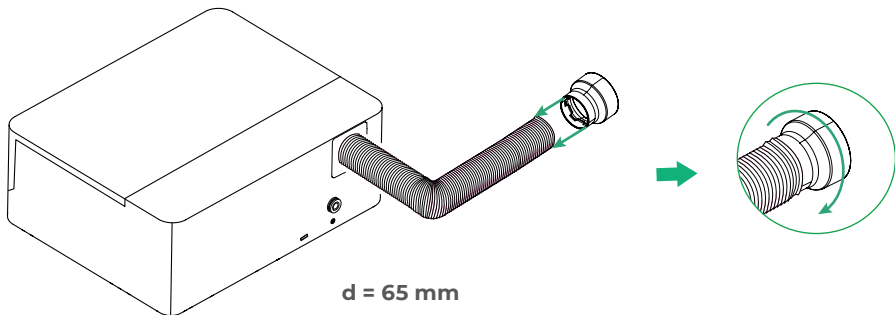
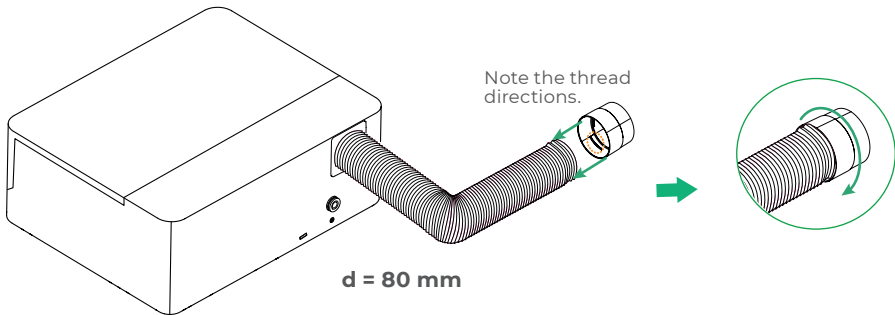

2 Attach the pipe connector and pipe assembly to the inline fan

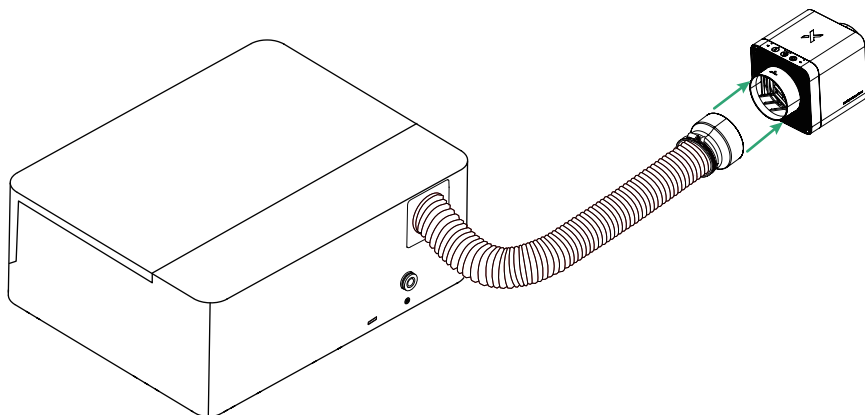
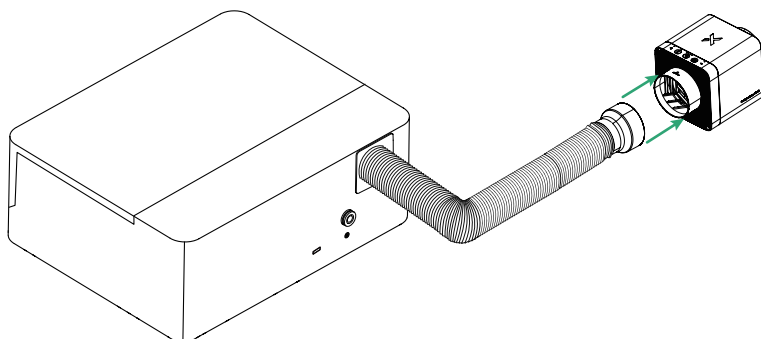
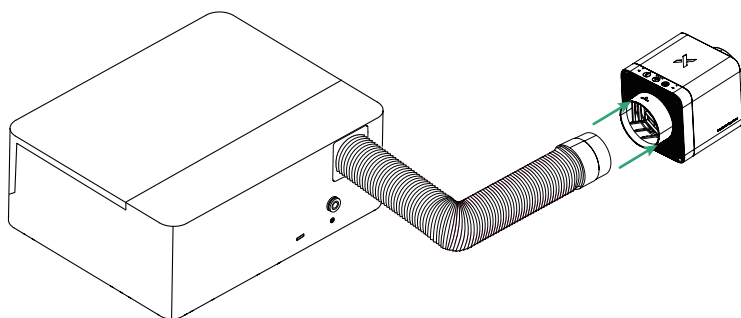

The connection process for pipe connectors 1 and 2 is the same in the following steps, and the process for pipe connector 1 is illustrated as an example.

3 Install the smoke exhaust pipe of the xTool SafetyPro™ IF2 2.0

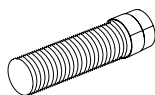

Smoke exhaust pipe

Connect the pipe connector and pipe assembly included in the package to the air outlet of the inline fan.

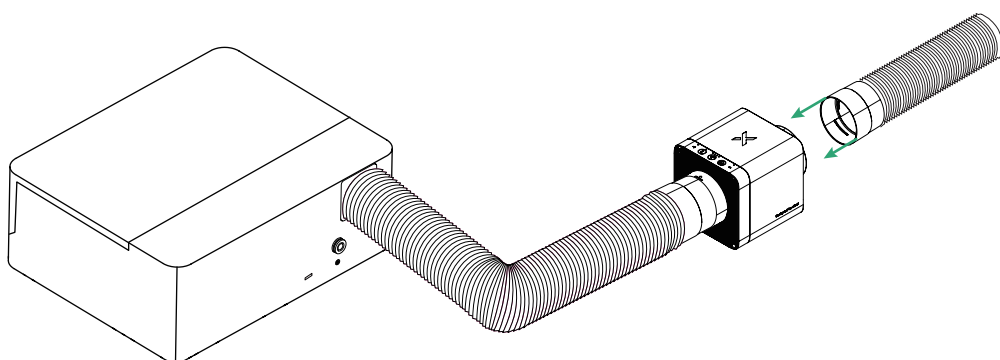

4 Connect to a power supply

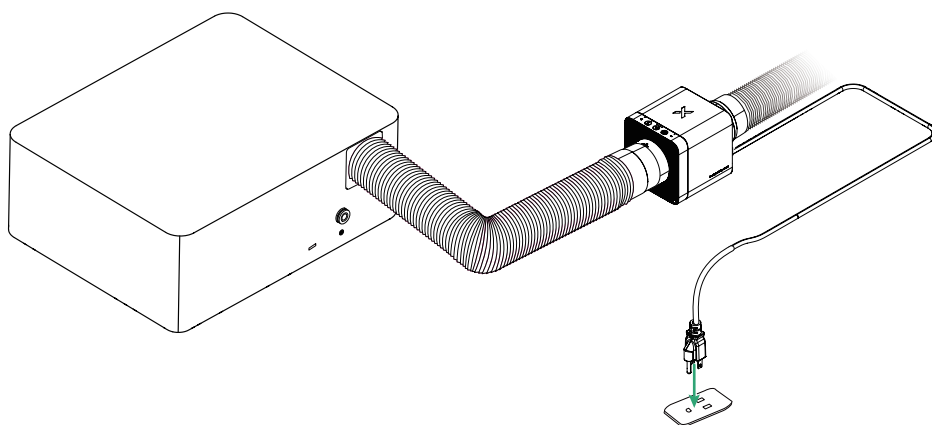

5 Set up wireless connection



The inline fan can establish a wireless connection only with xTool laser machines that support Bluetooth.

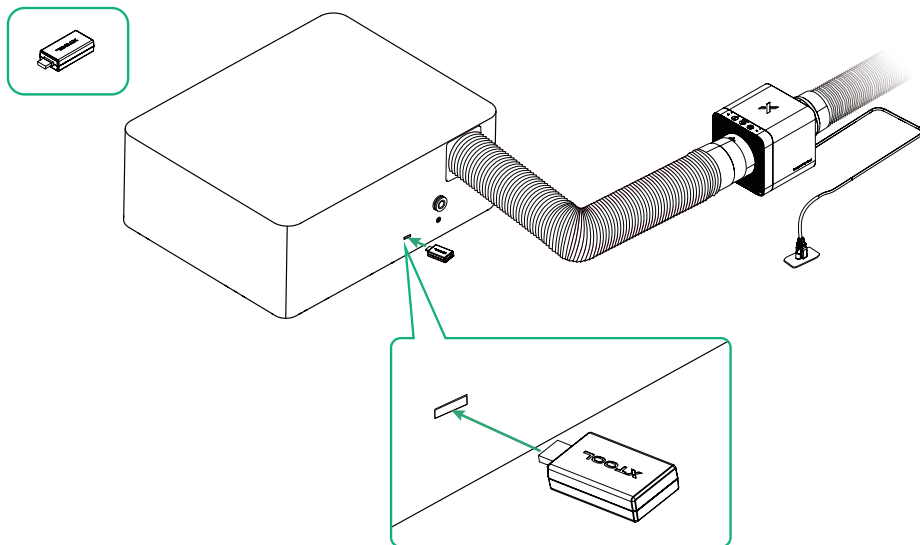

- Connect the Bluetooth dongle to the extension port of the xTool machine. The preceding figure is for reference only.
- After the Bluetooth dongle is connected, the inline fan automatically establishes a connection with the xTool machine. The machine's device settings page on the xTool software displays information about the inline fan. For more details, see "Use with xTool software."
- If another Bluetooth dongle has been connected to the machine already or you need to pair again, press and hold the inline fan's power button for at least five seconds. The Bluetooth status indicator will blink white, indicating that the inline fan is in pairing mode.

(Optional) Mount on the wall

- You can mount the inline fan on the wall or other suitable locations using the wall-mounting fixture included in the package.



The following tools are required but not included in the package:



Screwdriver



Pencil



Drill

(1)

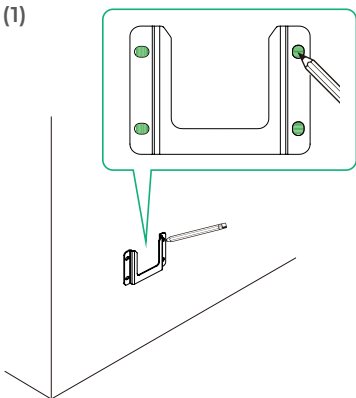

- Place the wall-mounting fixture against the wall, determine the proper position, and mark each hole's location with a pencil.

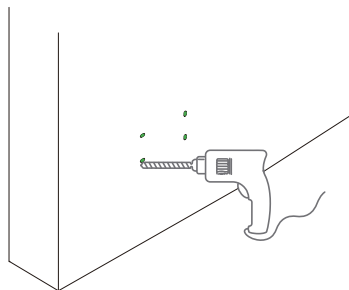

- Drill the four holes marked.

(2)

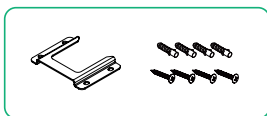

- To better secure the screws, you can hammer the ribbed plastic anchors into the holes before applying the screws.

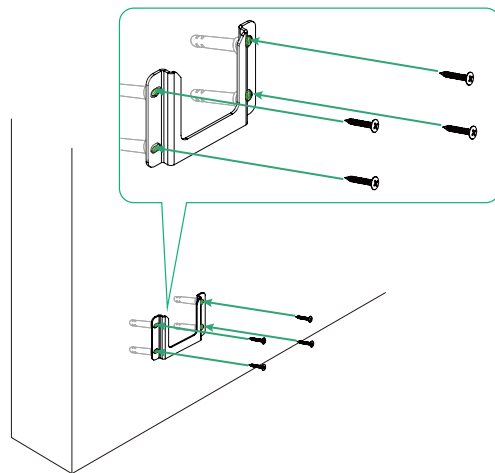

(3)

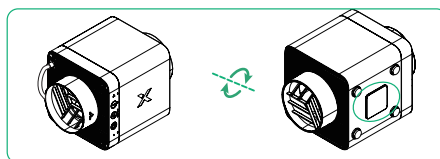
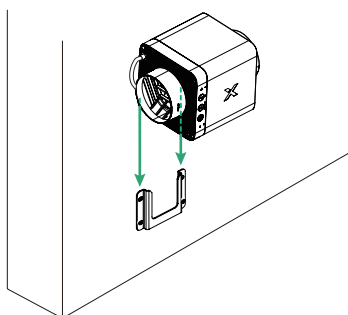

■ Slide the fan body along the fixture, with the wall-mounting bracket of the fan fitting on the fixture.

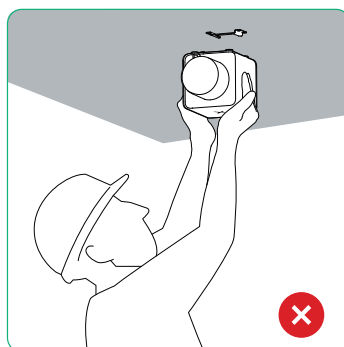
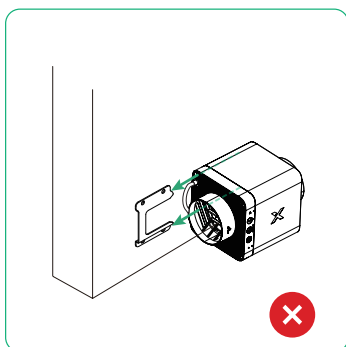

■ Never mount the wall-mounting fixture sideways or mount on a ceiling. Otherwise, the inline fan may not be fixed properly.

(4)

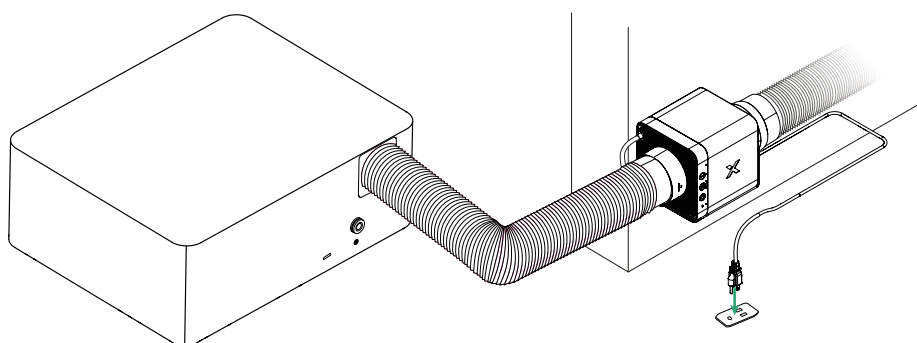

Use xTool SafetyPro™ IF2 2.0

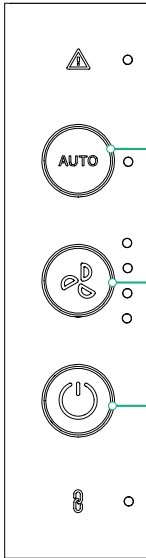





Auto mode button. In Auto mode, the inline fan adjusts the airflow based on the materials being processed. Note: AUTO mode is available only for Bluetooth-enabled xTool machines.

Airflow adjustment button. The indicator lights, arranged from top to bottom, represent airflow levels four, three, two, and one.

Power button. Press to turn the inline fan on or off. Press and hold this button for at least five seconds and the inline fan enters pairing mode.

Indicator description

Indicator	Indicator status	Device status
 Bluetooth status indicator	Blinking white	Enters pairing mode
	Solid white	Pairing succeeds
	Off	Pairing fails or Bluetooth connection is not established
 Fault indicator	Solid red	Inline fan motor stalls and the fan blades need cleaning
	Blinking red	Firmware upgrade fails
 Auto mode indicator	Solid white	The inline fan works in AUTO mode
 Airflow level indicator	Solid white	The inline fan works at the current airflow level
<p>The fault indicator and Bluetooth status indicator blink alternately: Firmware upgrade in progress.</p> <p>The fault indicator and Bluetooth status indicator are off and the buzzer sounds once: Firmware upgrade succeeds.</p>		

Use with xTool software

1 Download xTool software

Go to s.xtool.com/software to get the xTool software.

2 Use xTool SafetyPro™ IF2 2.0 with the xTool software



s.xtool.com/support/IF22.0/tutorial

Maintenance

Clean the fan

After a long period of use, dust buildup may cause abnormal airflow or affect smoke exhaust performance. Clean the fan promptly when the xTool software reminds you.

1 Remove the fan

(1) Disconnect the power cable.

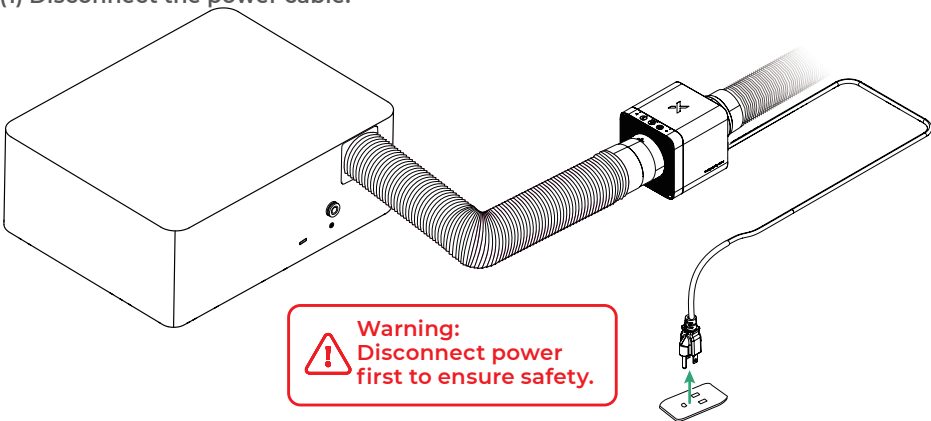

(2) Remove the exhaust pipes and pipe connectors on both sides.

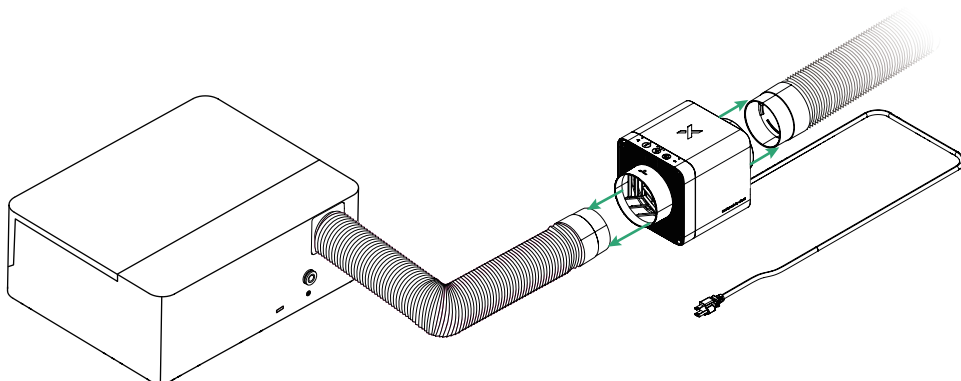

(3) Remove the four screws using the hex key.

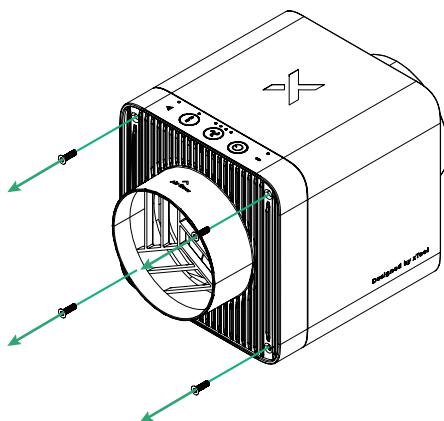

(4)

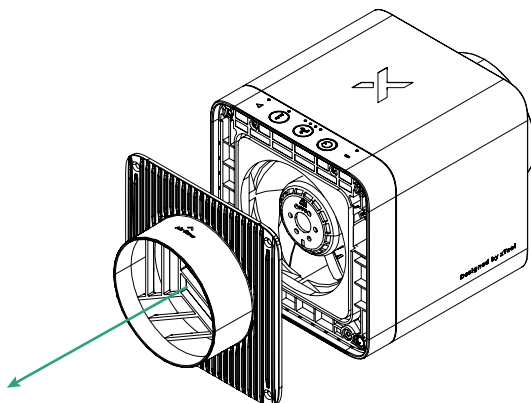

(5) Disconnect the fan's connection cables. Press the positions shown in the illustration using your thumb and pull out the terminals.

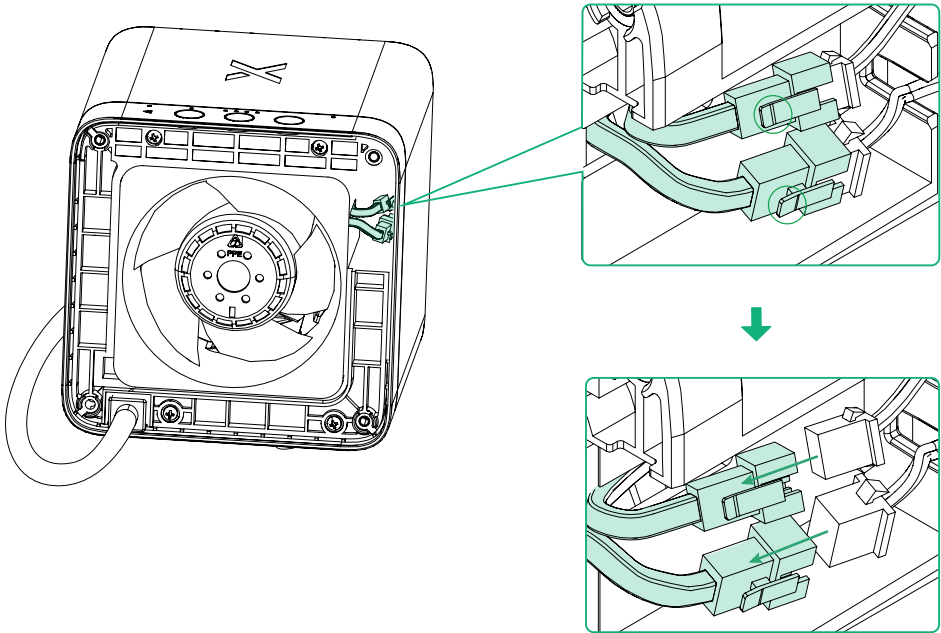

(6) Take the fan out.

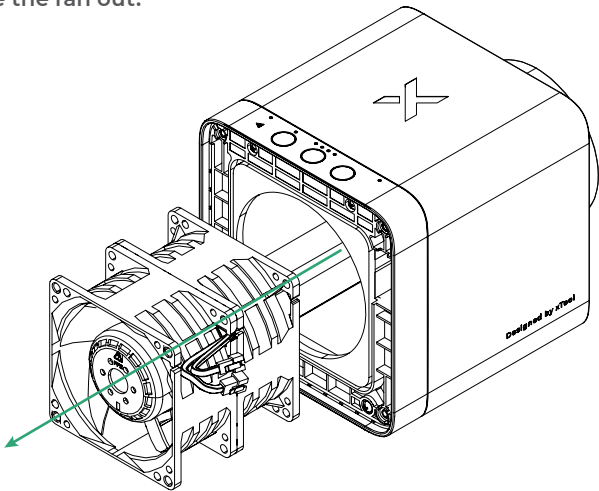

2 Clean the fan

(1) Clean the fan blade using a degreasing cleaner. Avoid applying the cleaner on the terminals.

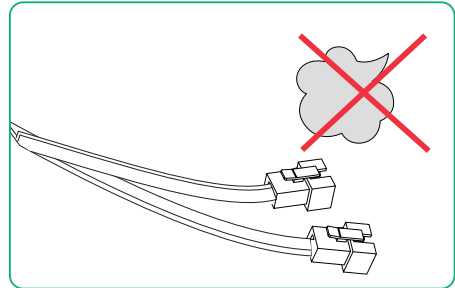
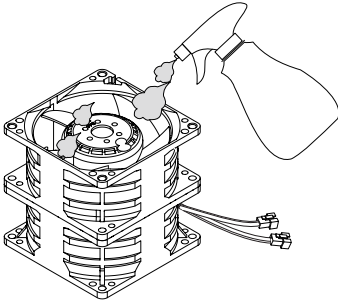

(2) Wash the fan blade with a gentle stream of water.



- Do not splash water on the terminals.
- Do not use a high-pressure water spray to rinse the fan or immerse the fan completely in water.

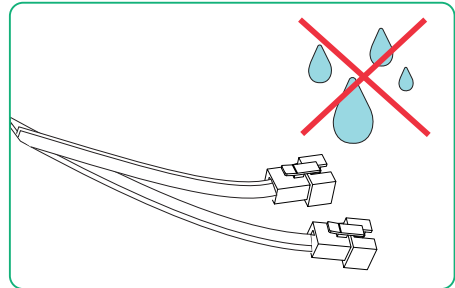
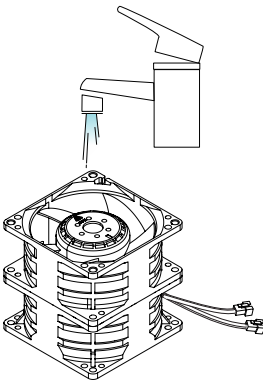

3 Install the fan back

(1) When the fan is dry, put it back with the five-blade side facing outward.

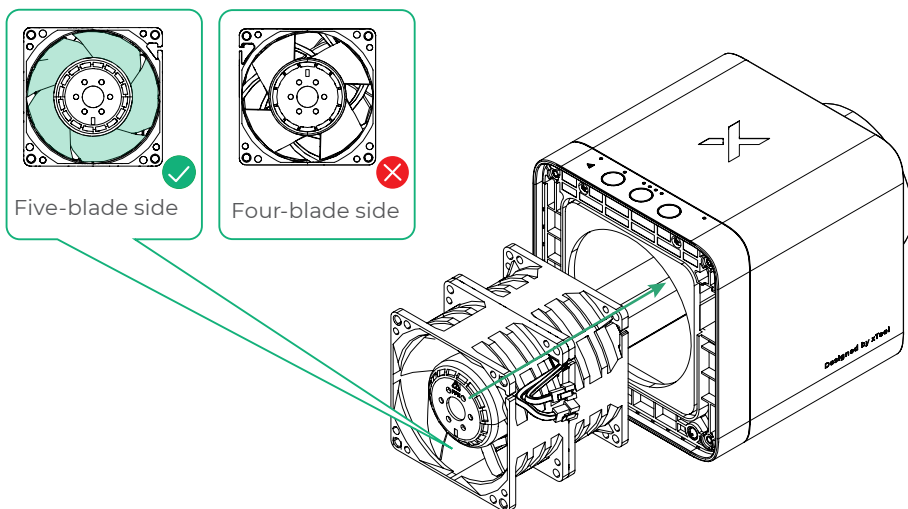

(2) Re-connect the fan's connection cables.

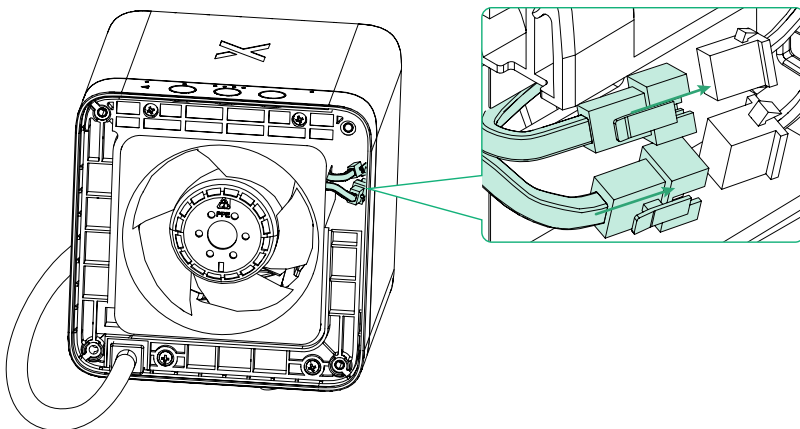

(3) Install the cover back.

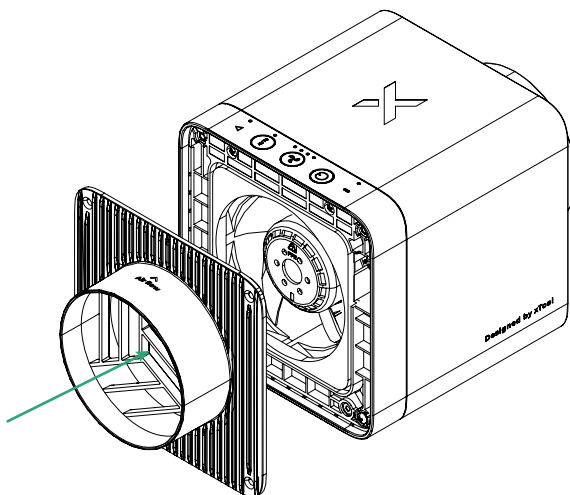

(4) Install and secure the four screws securing the cover.

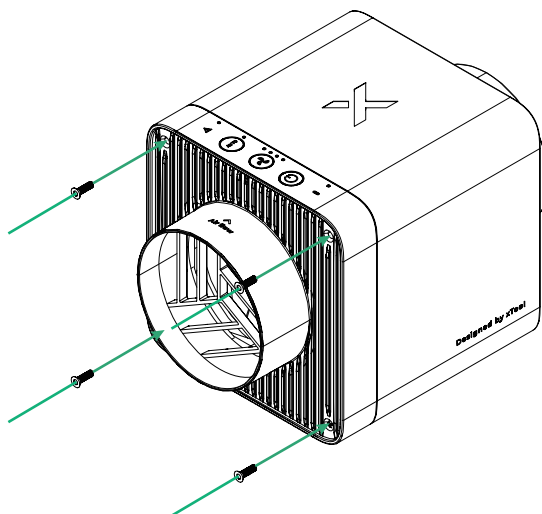
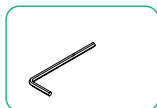

XTOOL