

XTOOL

P3 Automatic Conveyor Feeder



Quick Start Guide

List of items – – – – – 01

Install the conveyor feeder – – – – – 02

Use the conveyor feeder – – – – – 18

Product usage tips – – – – – 21

List of items

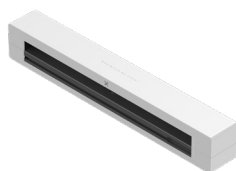

Conveyor feeder



Connection cable



Linear shaft



Fixing block

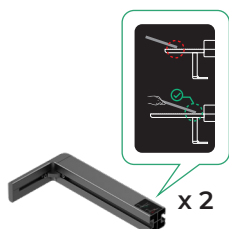

Front support base



Rear support base

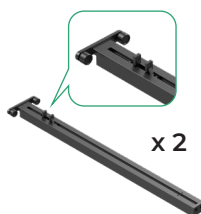

Front conveyor rail

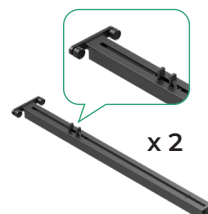

Rear conveyor rail



Smoke shield strip



Level



Screw M4*10



Screw M3*10



2.5 mm screwdriver



2.0 mm screwdriver



Quick start guide



Safety instructions



Sticker

Install the conveyor feeder

1 Prepare xTool P3

(1) Turn off the power switch.

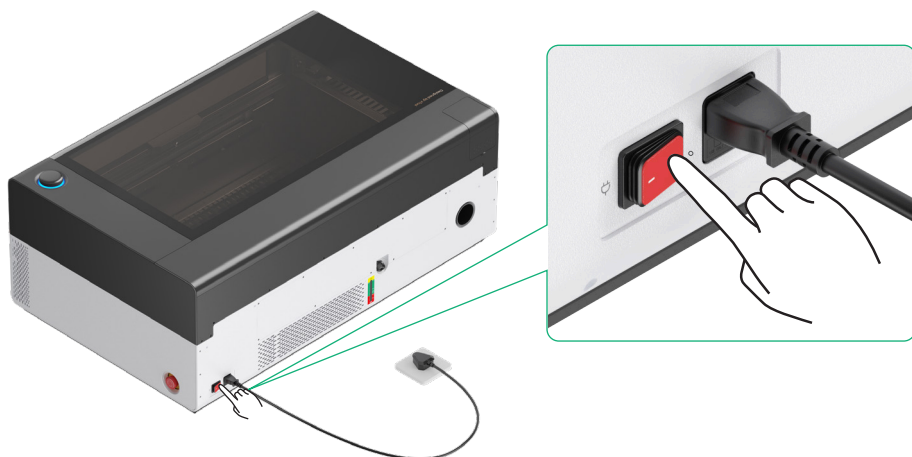

(2) Remove the screws from the back magnetic panel.

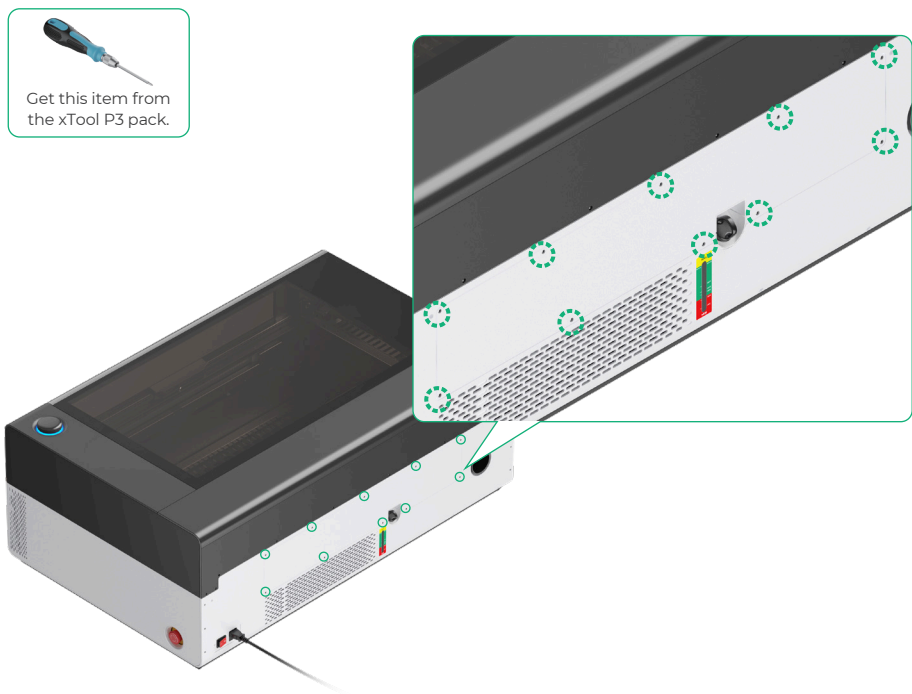

(3)

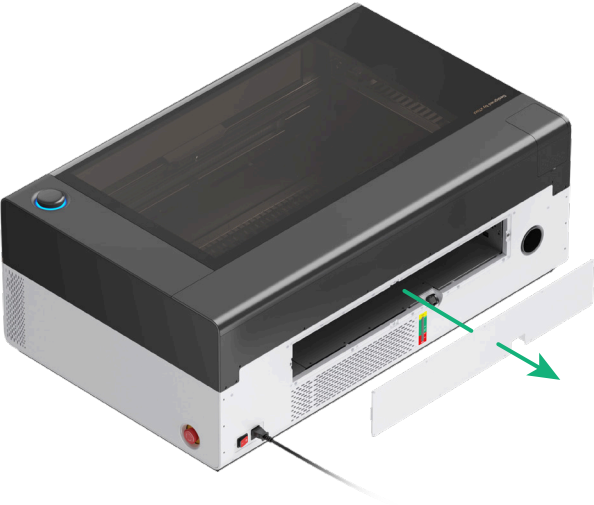

(4)



(5) Remove the internal magnetic panel.



(6) Remove the screws from the front magnetic panel.

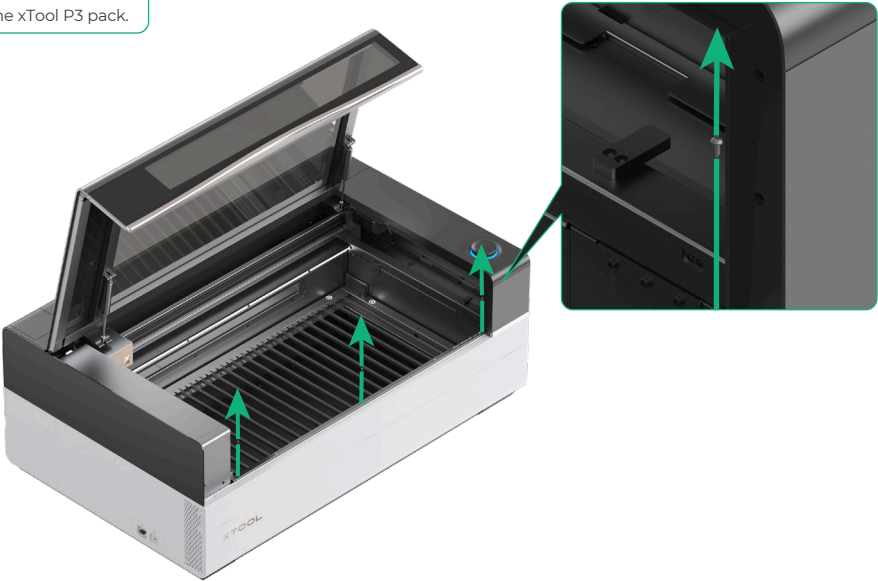

(7)

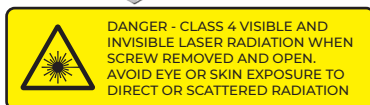
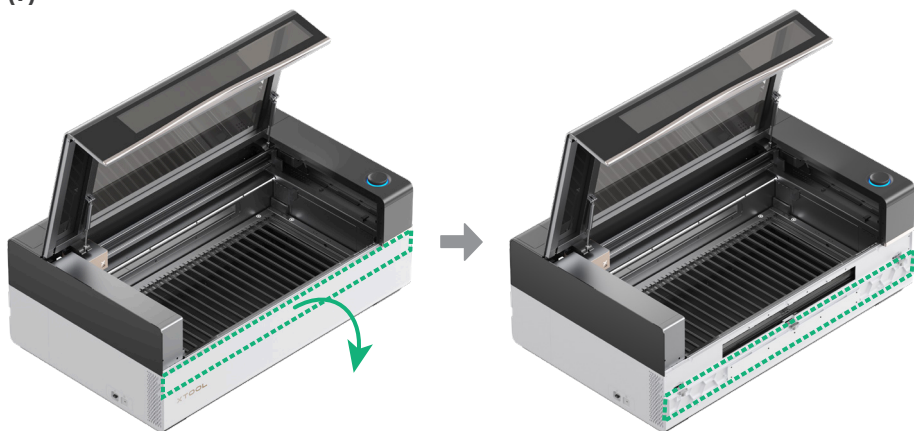

2 Install the conveyor feeder

(1)

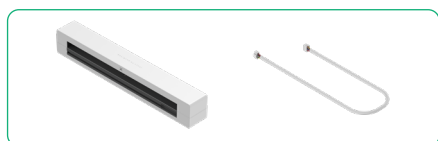

Pay attention to the obverse and reverse side of the connector.

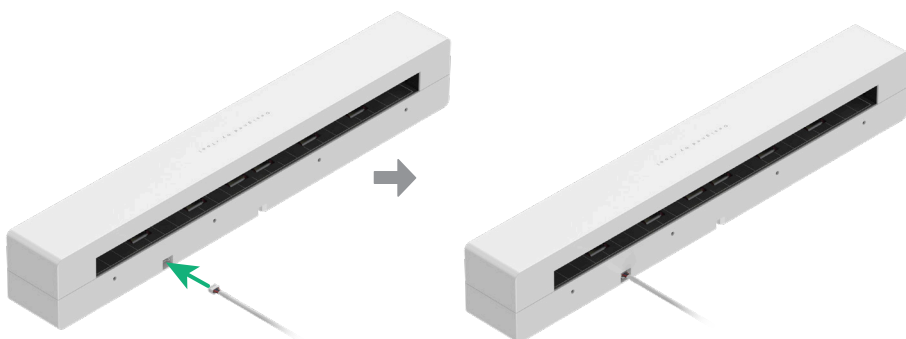

(2) Secure the connection cable.

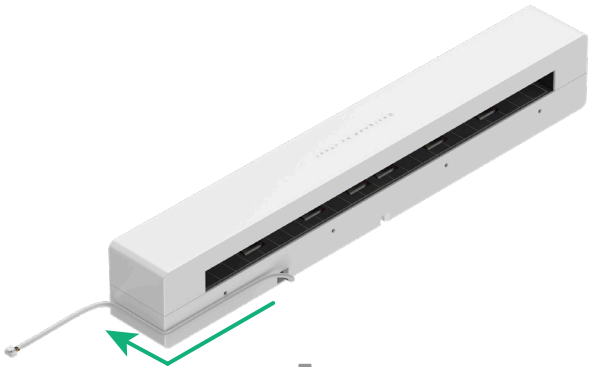
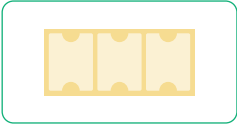

 Avoid the screw holes when attaching the sticker.



(3) Align the conveyor feeder with the left side of the slot and push it into place.

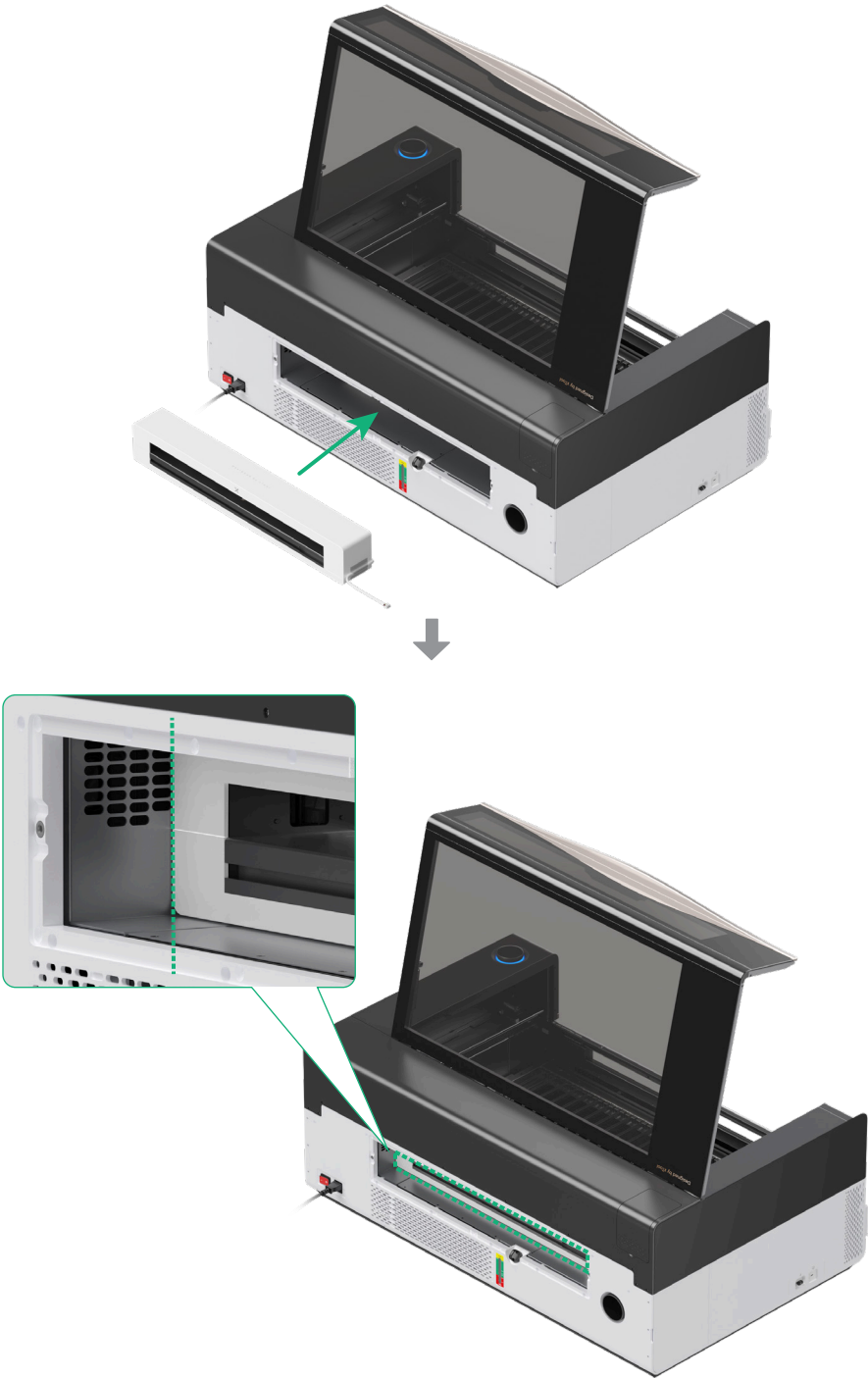

(4) Insert the other end of the connection cable to xTool P3.

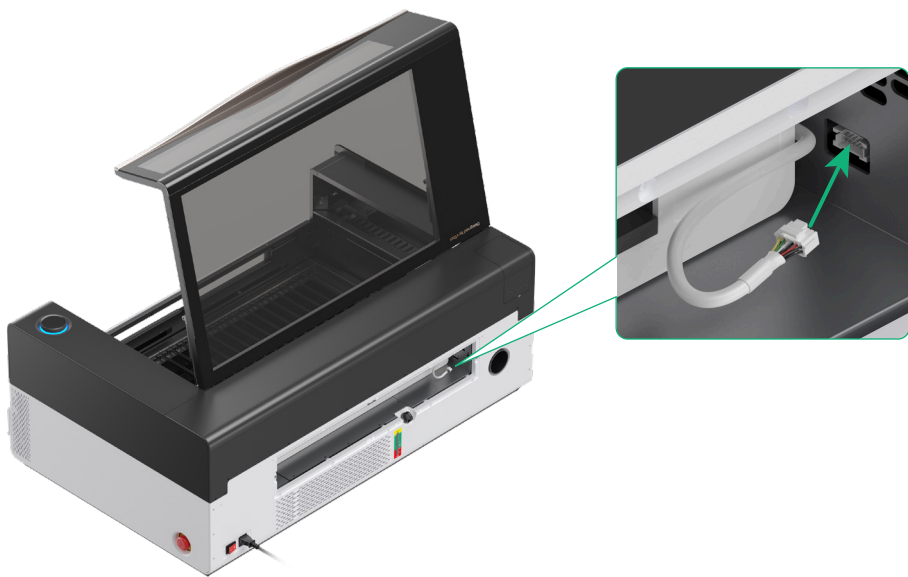

(5)

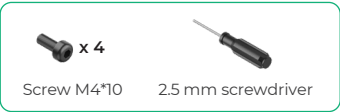

3 Install other parts

(1) Install the fixing block.



Screw M4*10



2.5 mm screwdriver

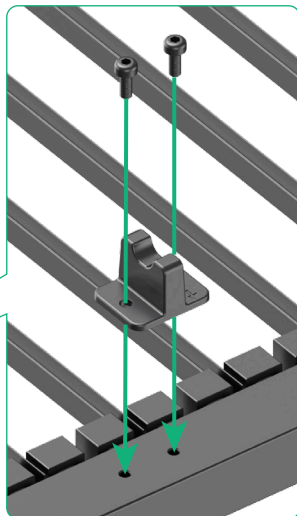

Pay attention to the direction of the fixing block.

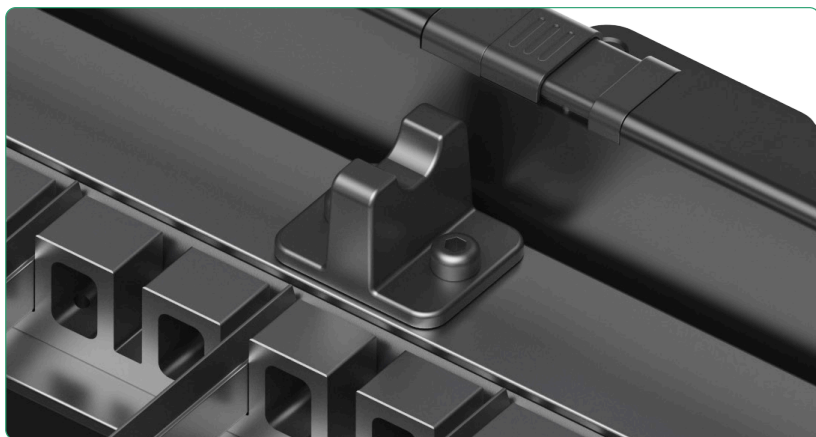

(2) Install the linear shaft.

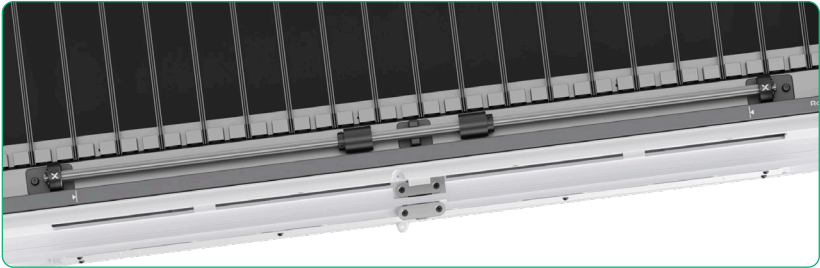
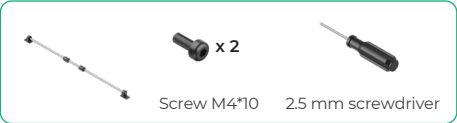

To avoid the laser module hitting the linear shaft, it is recommended to remove the linear shaft when you are not using the conveyor feeder for processing.

(3) Install the smoke shield strip.

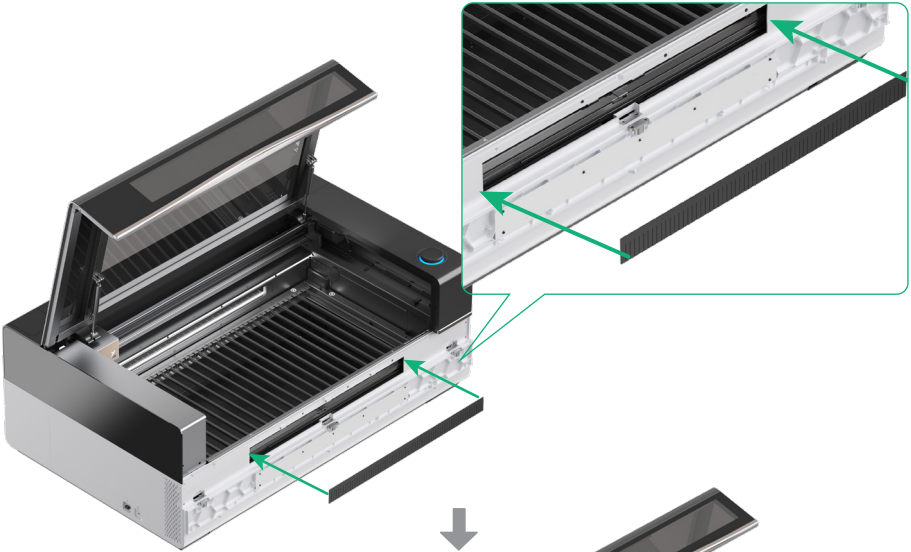
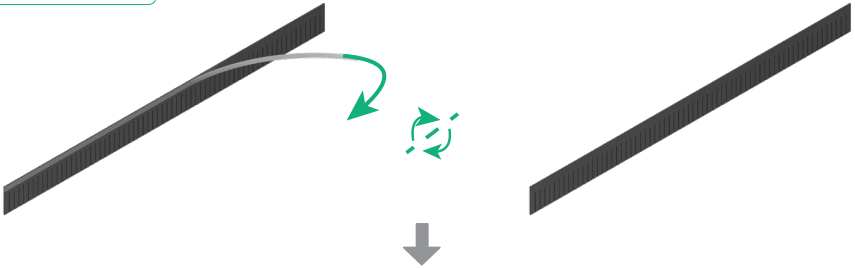
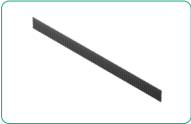

Press on both sides to ensure that the smoke shield strip is firmly secured.

4 Install the conveyor rails

(1) Assemble the rear conveyor rail.

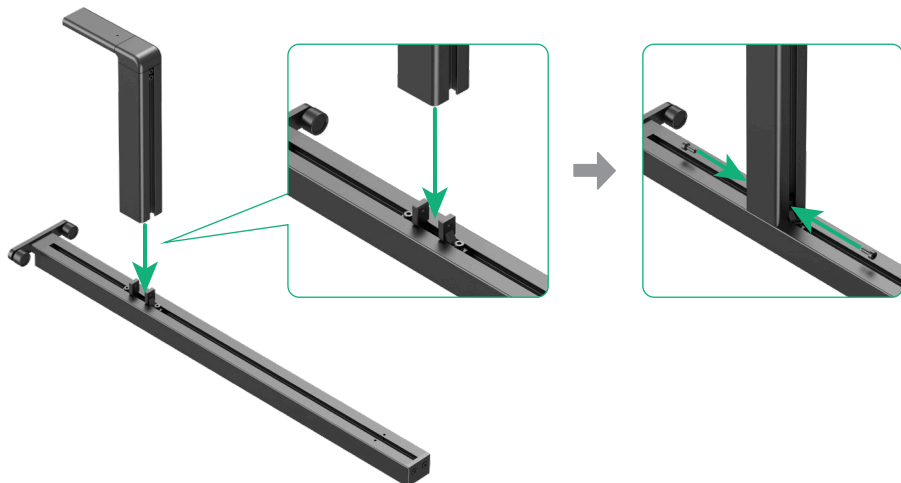
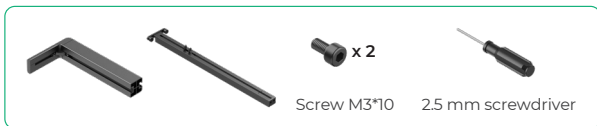

(2) Assemble the other rear conveyor rail in the same way.



(3) Assemble the front conveyor rail.

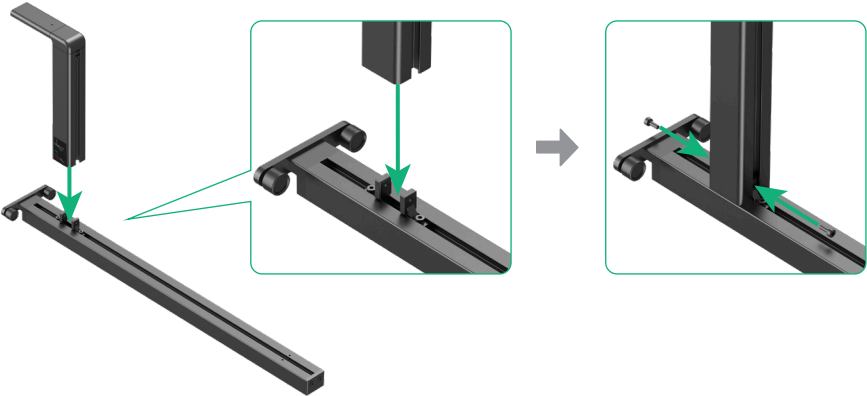

(4) Assemble the other front conveyor rail in the same way.



(5) Install the front conveyor rail.

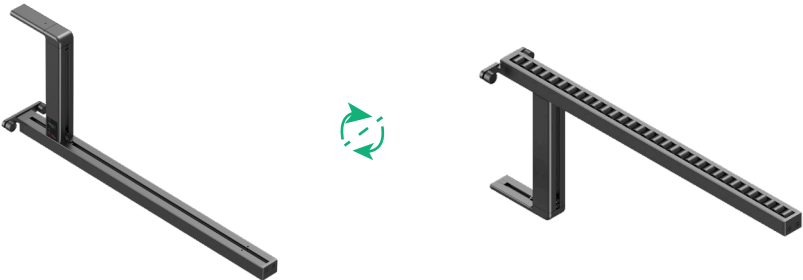

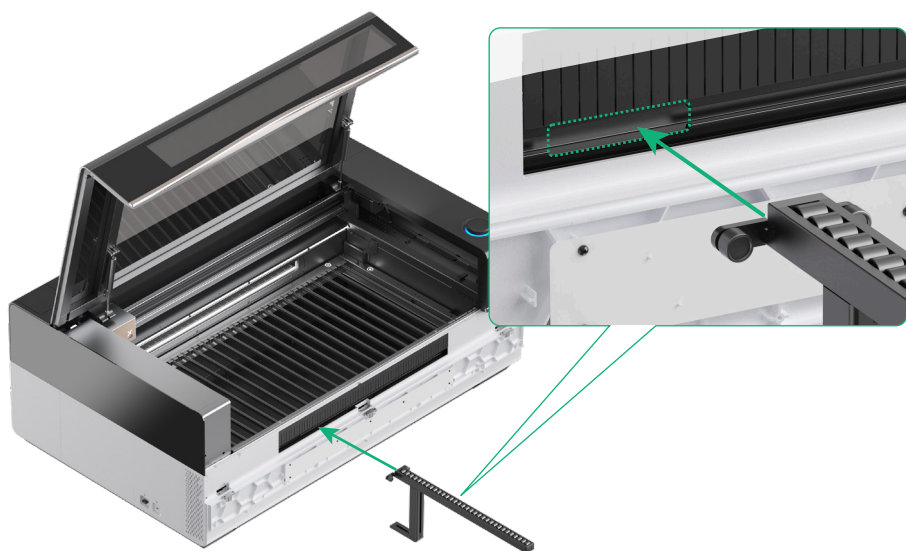

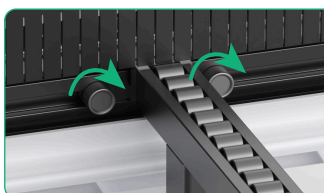

Move the conveyor rail to the proper position based on the width of the material to be processed and tighten the screws clockwise.

(6) Install the other front conveyor rail in the same way.



(7) Install the rear conveyor rail.





Move the conveyor rail to the proper position based on the width of the material to be processed and tighten the screws clockwise.

(8) Install the other rear conveyor rail in the same way.



Ensure that the front and rear conveyor rails are aligned symmetrically.

Use the conveyor feeder

1 Open the sensor cover



Slide the sensor cover to its original position after processing.

2 Place a material

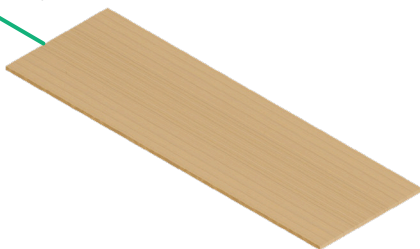

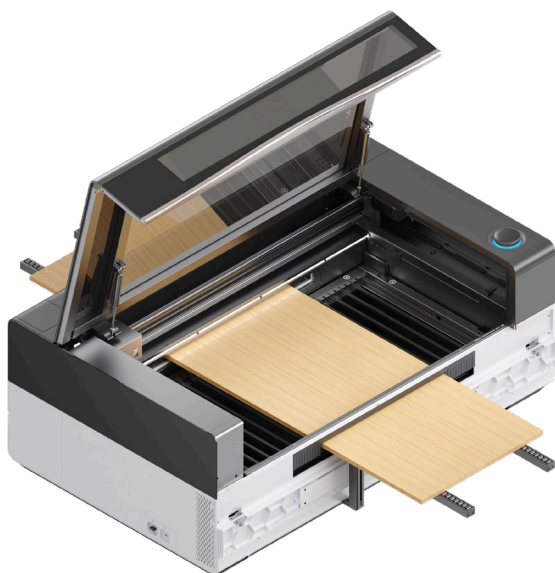

3 Turn on the power switch of xTool P3.

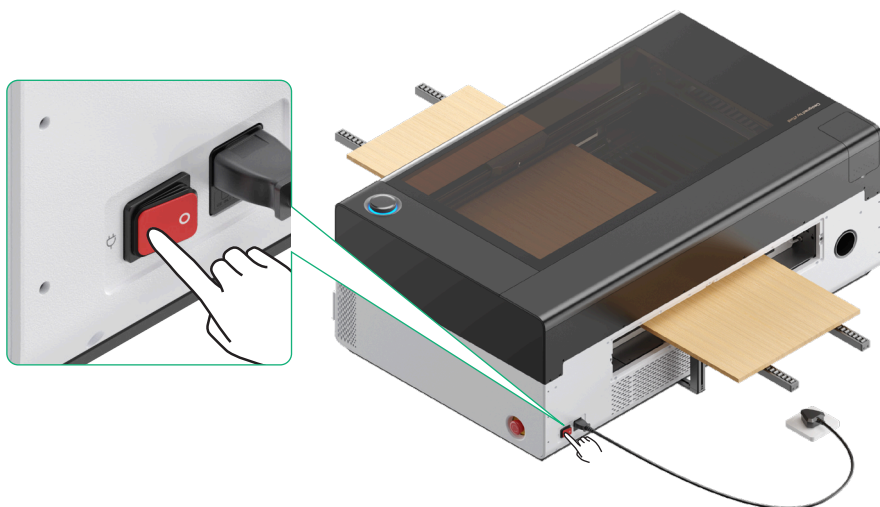

4 Get xTool software

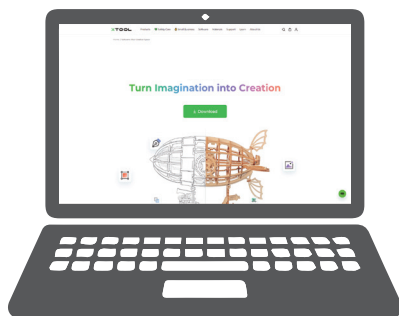

Visit s.xtool.com/software to get xTool software.

5 Connect xTool P3 to a computer

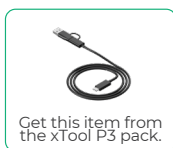

Get this item from the xTool P3 pack.

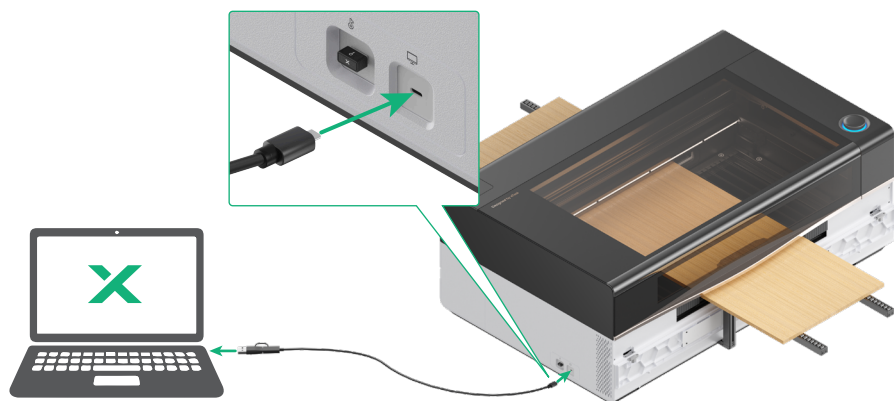

Visit support.xtool.com/article/2130 or scan the QR code for details about how to use xTool software to process materials.



Product usage tips

1 Pressure level

- In xTool software, the conveyor feeder mode provides two pressure levels: rigid level and flexible level, responding to hard material and soft material respectively.
- Rigid level is the default setting. If you process a soft material, set the pressure level to **Flexible** before capturing images.

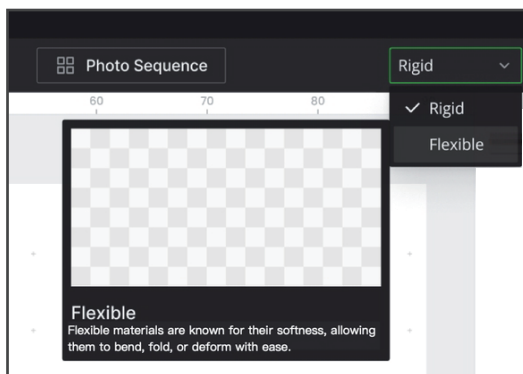

2 Material requirements

- Use materials with straight edges.



- Use materials with high flatness, or materials with a maximum deformation of 4 mm or less.



- When you process a soft material with a thickness less than 6 mm, adhere it to a 6 mm wooden board of the same size and set the pressure level to **Rigid** in xTool software. During adhesion, ensure the material is aligned with all four edges of the board.

3 Material placement

■ To avoid damage to the conveyor rails, when placing the material, ensure that the front end of the material is at the support base of the conveyor rails.

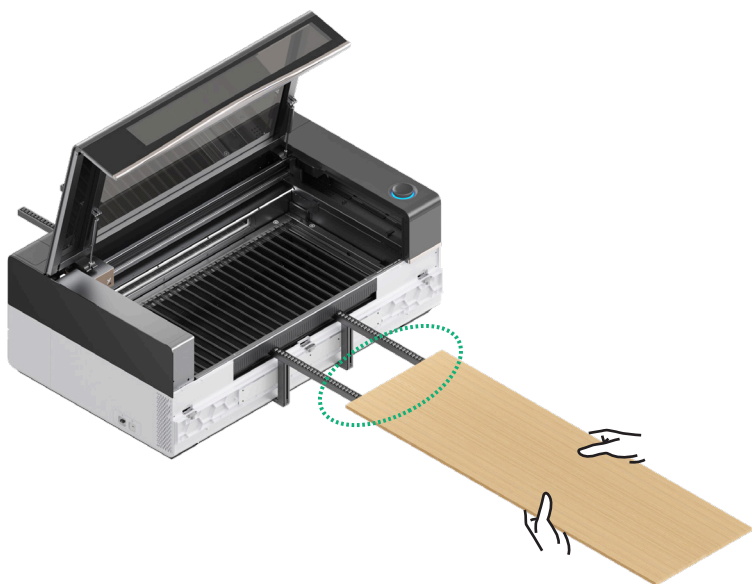
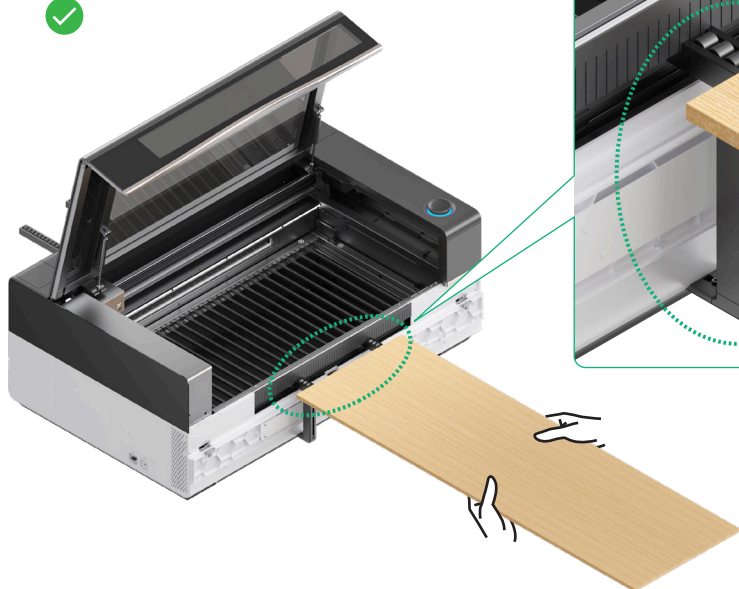

- You can loosen the screws of the conveyor rollers with the 2.0 mm screwdriver and adjust the conveyor roller positions based on the width of the material.



- Ensure that both sides of the material is within the widest limit mark of feeding inlet.

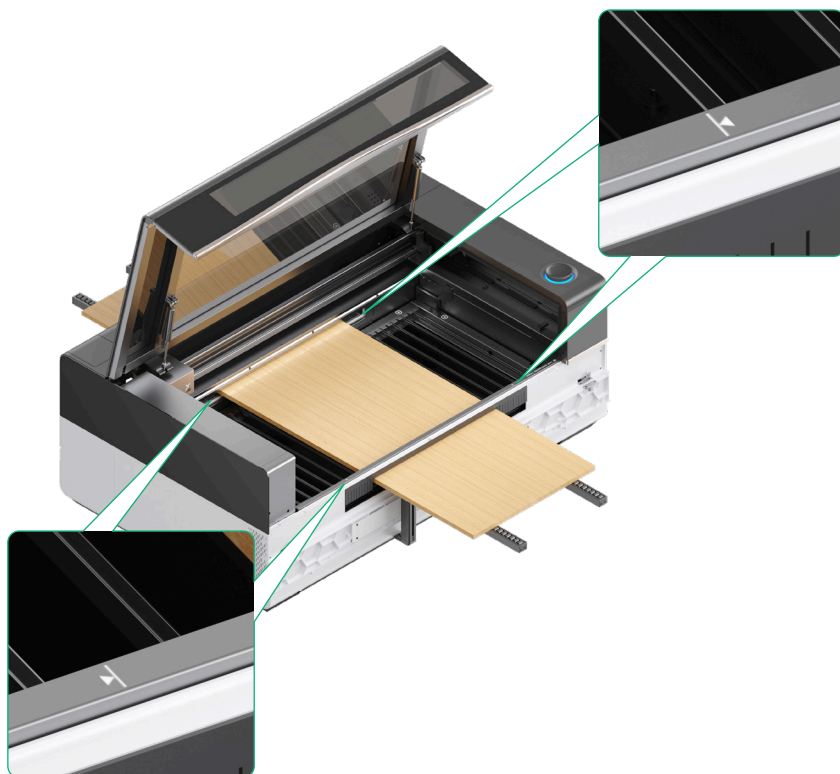

- Ensure that the material is parallel to the slats of xTool P3.

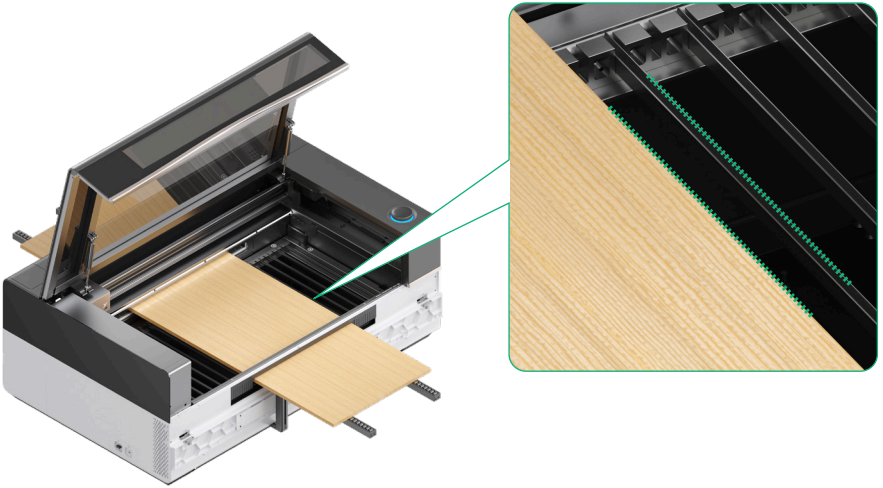

- Ensure both ends of the material fully cover the pinch rollers; otherwise, the material may shift due to uneven force.

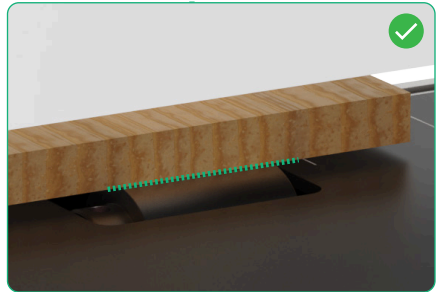
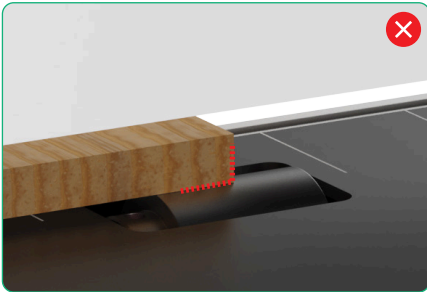

- Adjust the distance between two conveyor rails based on the width of material to ensure that the material is under even pressure, which can avoid deformation.

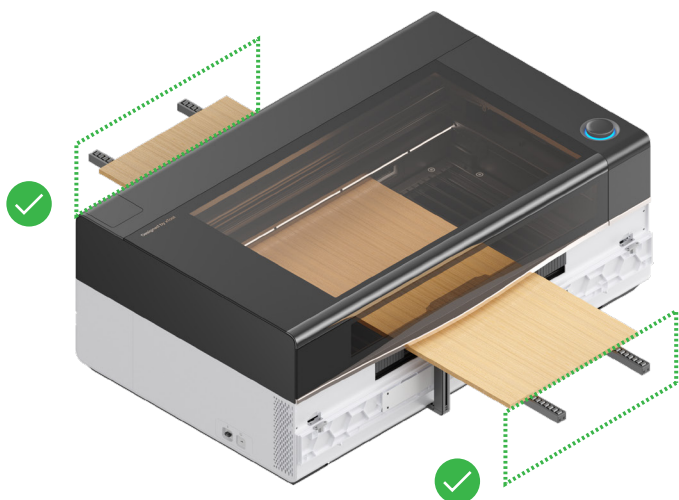

■ To ensure that the material is tightly secured and the feed is stable, the protruding length of the material's leading end should be approximately equal to that of the trailing end.



4 Cautions for processing

■ If the unsupported sections of both sides of the material are more than 300 mm, additional conveyor rails are required.
You can purchase conveyor rails at [xTool.com](https://www.xTool.com).

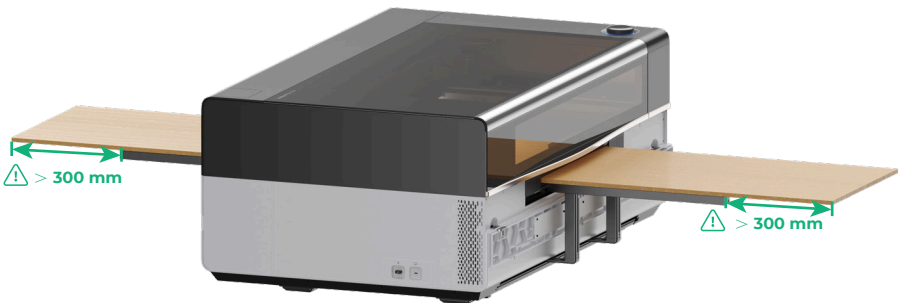

5 Routine cleaning



Brush (not included in the pack)

- Use a brush to regularly clean the clamping module on the conveyor feeder to ensure a good processing effect.

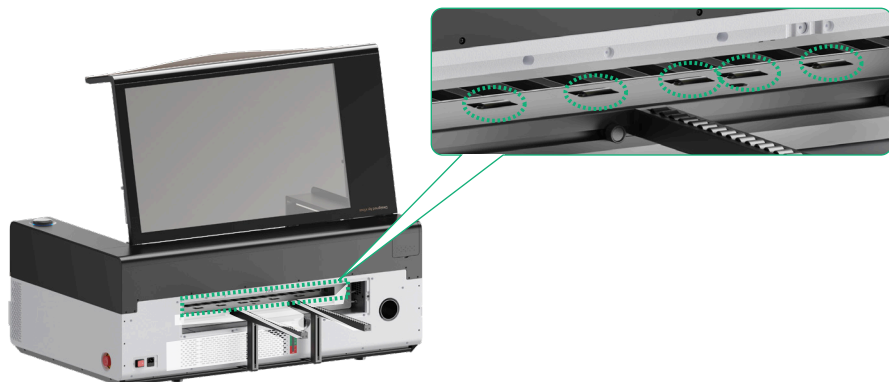

- Before using the conveyor feeder, ensure that the sensor cover in the conveyor feeder and that in the front of xTool P3 are clean.

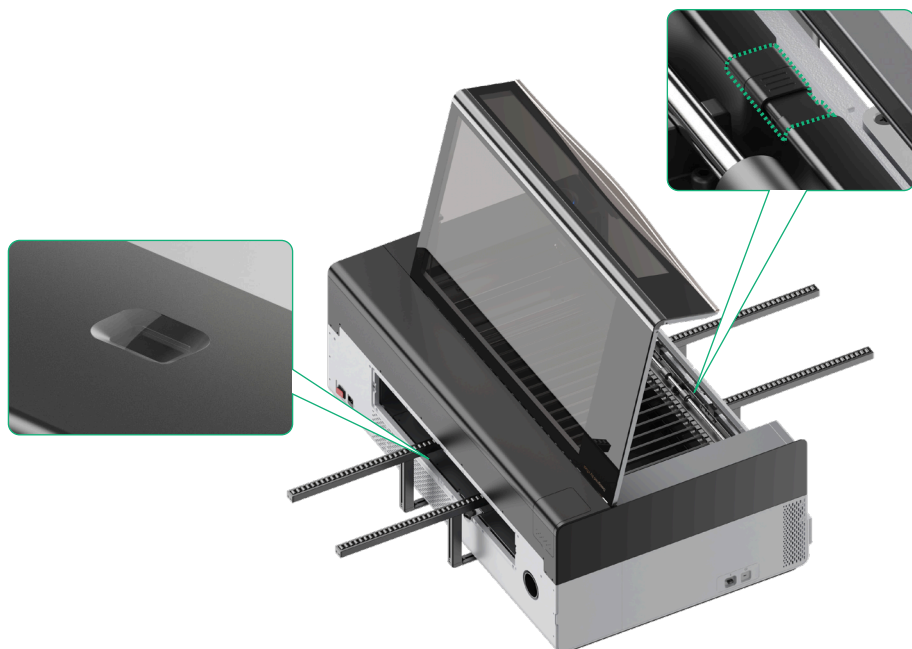

XTOOL